

Lordstown Excess Land -Site ID 1011

1829 Hallock Young Road
Lordstown, OH 44481

Inquiry Number: 02559388.20r
August 07, 2009

The EDR Radius Map™ Report with GeoCheck®

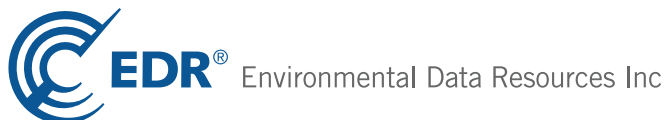

440 Wheelers Farms Road
Milford, CT 06461
Toll Free: 800.352.0050
www.edrnet.com

TABLE OF CONTENTS

<u>SECTION</u>	<u>PAGE</u>
Executive Summary	ES1
Overview Map	2
Detail Map	3
Map Findings Summary	4
Map Findings	7
Orphan Summary	10
Government Records Searched/Data Currency Tracking	GR-1
 <u>GEOCHECK ADDENDUM</u>	
Physical Setting Source Addendum	A-1
Physical Setting Source Summary	A-2
Physical Setting SSURGO Soil Map	A-5
Physical Setting Source Map	A-12
Physical Setting Source Map Findings	A-13
Physical Setting Source Records Searched	A-33

Thank you for your business.
Please contact EDR at 1-800-352-0050
with any questions or comments.

Disclaimer - Copyright and Trademark Notice

This Report contains certain information obtained from a variety of public and other sources reasonably available to Environmental Data Resources, Inc. It cannot be concluded from this Report that coverage information for the target and surrounding properties does not exist from other sources. **NO WARRANTY EXPRESSED OR IMPLIED, IS MADE WHATSOEVER IN CONNECTION WITH THIS REPORT. ENVIRONMENTAL DATA RESOURCES, INC. SPECIFICALLY DISCLAIMS THE MAKING OF ANY SUCH WARRANTIES, INCLUDING WITHOUT LIMITATION, MERCHANTABILITY OR FITNESS FOR A PARTICULAR USE OR PURPOSE. ALL RISK IS ASSUMED BY THE USER. IN NO EVENT SHALL ENVIRONMENTAL DATA RESOURCES, INC. BE LIABLE TO ANYONE, WHETHER ARISING OUT OF ERRORS OR OMISSIONS, NEGLIGENCE, ACCIDENT OR ANY OTHER CAUSE, FOR ANY LOSS OF DAMAGE, INCLUDING, WITHOUT LIMITATION, SPECIAL, INCIDENTAL, CONSEQUENTIAL, OR EXEMPLARY DAMAGES. ANY LIABILITY ON THE PART OF ENVIRONMENTAL DATA RESOURCES, INC. IS STRICTLY LIMITED TO A REFUND OF THE AMOUNT PAID FOR THIS REPORT.** Purchaser accepts this Report "AS IS". Any analyses, estimates, ratings, environmental risk levels or risk codes provided in this Report are provided for illustrative purposes only, and are not intended to provide, nor should they be interpreted as providing any facts regarding, or prediction or forecast of, any environmental risk for any property. Only a Phase I Environmental Site Assessment performed by an environmental professional can provide information regarding the environmental risk for any property. Additionally, the information provided in this Report is not to be construed as legal advice.

Copyright 2009 by Environmental Data Resources, Inc. All rights reserved. Reproduction in any media or format, in whole or in part, of any report or map of Environmental Data Resources, Inc., or its affiliates, is prohibited without prior written permission.

EDR and its logos (including Sanborn and Sanborn Map) are trademarks of Environmental Data Resources, Inc. or its affiliates. All other trademarks used herein are the property of their respective owners.

EXECUTIVE SUMMARY

A search of available environmental records was conducted by Environmental Data Resources, Inc (EDR). The report was designed to assist parties seeking to meet the search requirements of EPA's Standards and Practices for All Appropriate Inquiries (40 CFR Part 312), the ASTM Standard Practice for Environmental Site Assessments (E 1527-05) or custom requirements developed for the evaluation of environmental risk associated with a parcel of real estate.

TARGET PROPERTY INFORMATION

ADDRESS

1829 HALLOCK YOUNG ROAD
LORDSTOWN, OH 44481

COORDINATES

Latitude (North):	41.142500 - 41° 8' 33.0"
Longitude (West):	80.860600 - 80° 51' 38.2"
Universal Tranverse Mercator:	Zone 17
UTM X (Meters):	511698.8
UTM Y (Meters):	4554373.5
Elevation:	972 ft. above sea level

USGS TOPOGRAPHIC MAP ASSOCIATED WITH TARGET PROPERTY

Target Property Map:	41080-B7 WARREN, OH
Most Recent Revision:	1997
West Map:	41080-B8 NEWTON FALLS, OH
Most Recent Revision:	1994

AERIAL PHOTOGRAPHY IN THIS REPORT

Portions of Photo from:	2005, 2006
Source:	USDA

TARGET PROPERTY SEARCH RESULTS

The target property was not listed in any of the databases searched by EDR.

DATABASES WITH NO MAPPED SITES

No mapped sites were found in EDR's search of available ("reasonably ascertainable ") government records either on the target property or within the search radius around the target property for the following databases:

STANDARD ENVIRONMENTAL RECORDS

Federal NPL site list

NPL..... National Priority List

EXECUTIVE SUMMARY

Proposed NPL..... Proposed National Priority List Sites
NPL LIENS..... Federal Superfund Liens

Federal Delisted NPL site list

Delisted NPL..... National Priority List Deletions

Federal CERCLIS list

CERCLIS..... Comprehensive Environmental Response, Compensation, and Liability Information System

Federal CERCLIS NFRAP site List

CERC-NFRAP..... CERCLIS No Further Remedial Action Planned

Federal RCRA CORRACTS facilities list

CORRACTS..... Corrective Action Report

Federal RCRA non-CORRACTS TSD facilities list

RCRA-TSDF..... RCRA - Transporters, Storage and Disposal

Federal RCRA generators list

RCRA-LQG..... RCRA - Large Quantity Generators
RCRA-SQG..... RCRA - Small Quantity Generators
RCRA-CESQG..... RCRA - Conditionally Exempt Small Quantity Generator

Federal institutional controls / engineering controls registries

US ENG CONTROLS..... Engineering Controls Sites List
US INST CONTROL..... Sites with Institutional Controls

Federal ERNS list

ERNS..... Emergency Response Notification System

State- and tribal - equivalent CERCLIS

SHWS..... This state does not maintain a SHWS list. See the Federal CERCLIS list and Federal
NPL list.
DERR..... Division of Emergency & Remedial Response's Database

State and tribal landfill and/or solid waste disposal site lists

SWF/LF..... Licensed Solid Waste Facilities

State and tribal leaking storage tank lists

LUST..... Leaking Underground Storage Tank File
UNREG LTANKS..... Ohio Leaking UST File
INDIAN LUST..... Leaking Underground Storage Tanks on Indian Land

State and tribal registered storage tank lists

UST..... Underground Storage Tank File

EXECUTIVE SUMMARY

INDIAN UST..... Underground Storage Tanks on Indian Land

State and tribal institutional control / engineering control registries

ENG CONTROLS..... Sites with Engineering Controls
INST CONTROL..... Sites with Institutional Engineering Controls
HIST ENG CONTROLS..... Operation & Maintenance Agreements Database
HIST INST CONTROLS..... Institutional Controls Database

State and tribal voluntary cleanup sites

VCP..... Voluntary Action Program Sites
INDIAN VCP..... Voluntary Cleanup Priority Listing

State and tribal Brownfields sites

BROWNFIELDS..... Ohio Brownfield Inventory

ADDITIONAL ENVIRONMENTAL RECORDS

Local Brownfield lists

US BROWNFIELDS..... A Listing of Brownfields Sites

Local Lists of Landfill / Solid Waste Disposal Sites

ODI..... Open Dump Inventory
DEBRIS REGION 9..... Torres Martinez Reservation Illegal Dump Site Locations
HIST LF..... Old Solid Waste Landfill
INDIAN ODI..... Report on the Status of Open Dumps on Indian Lands

Local Lists of Hazardous waste / Contaminated Sites

US CDL..... Clandestine Drug Labs
CDL..... Clandestine Drug Lab Locations

Local Lists of Registered Storage Tanks

ARCHIVE UST..... Archived Underground Storage Tank Sites

Local Land Records

LIENS 2..... CERCLA Lien Information
LUCIS..... Land Use Control Information System

Records of Emergency Release Reports

HMIRS..... Hazardous Materials Information Reporting System
SPILLS..... Emergency Response Database

Other Ascertainable Records

DOT OPS..... Incident and Accident Data
DOD..... Department of Defense Sites

EXECUTIVE SUMMARY

FUDS.....	Formerly Used Defense Sites
CONSENT.....	Superfund (CERCLA) Consent Decrees
ROD.....	Records Of Decision
UMTRA.....	Uranium Mill Tailings Sites
MINES.....	Mines Master Index File
TRIS.....	Toxic Chemical Release Inventory System
TSCA.....	Toxic Substances Control Act
FTTS.....	FIFRA/ TSCA Tracking System - FIFRA (Federal Insecticide, Fungicide, & Rodenticide Act)/TSCA (Toxic Substances Control Act)
HIST FTTS.....	FIFRA/TSCA Tracking System Administrative Case Listing
SSTS.....	Section 7 Tracking Systems
ICIS.....	Integrated Compliance Information System
PADS.....	PCB Activity Database System
MLTS.....	Material Licensing Tracking System
RADINFO.....	Radiation Information Database
FINDS.....	Facility Index System/Facility Registry System
RAATS.....	RCRA Administrative Action Tracking System
TOWNGAS.....	DERR Towngas Database
UIC.....	Underground Injection Wells Listing
DRYCLEANERS.....	Drycleaner Facility Listing
NPDES.....	NPDES General Permit List
AIRS.....	Title V Permits Listing
USD.....	Urban Setting Designation Sites
HIST USD.....	Urban Setting Designations Database
INDIAN RESERV.....	Indian Reservations
SCRD DRYCLEANERS.....	State Coalition for Remediation of Drycleaners Listing

EDR PROPRIETARY RECORDS

EDR Proprietary Records

Manufactured Gas Plants..... EDR Proprietary Manufactured Gas Plants

SURROUNDING SITES: SEARCH RESULTS

Surrounding sites were identified in the following databases.

Elevations have been determined from the USGS Digital Elevation Model and should be evaluated on a relative (not an absolute) basis. Relative elevation information between sites of close proximity should be field verified. Sites with an elevation equal to or higher than the target property have been differentiated below from sites with an elevation lower than the target property.

Page numbers and map identification numbers refer to the EDR Radius Map report where detailed data on individual sites can be reviewed.

Sites listed in ***bold italics*** are in multiple databases.

Unmappable (orphan) sites are not considered in the foregoing analysis.

ADDITIONAL ENVIRONMENTAL RECORDS

Other Ascertainable Records

EXECUTIVE SUMMARY

RCRA-NonGen: RCRAInfo is EPA's comprehensive information system, providing access to data supporting the Resource Conservation and Recovery Act (RCRA) of 1976 and the Hazardous and Solid Waste Amendments (HSWA) of 1984. The database includes selective information on sites which generate, transport, store, treat and/or dispose of hazardous waste as defined by the Resource Conservation and Recovery Act (RCRA). Non-Generators do not presently generate hazardous waste.

A review of the RCRA-NonGen list, as provided by EDR, and dated 11/12/2008 has revealed that there is 1 RCRA-NonGen site within approximately 0.25 miles of the target property.

<u>Equal/Higher Elevation</u>	<u>Address</u>	<u>Direction / Distance</u>	<u>Map ID</u>	<u>Page</u>
<i>CROWN DIVISIONS *</i>	<i>1757 HALLOCK YOUNG ROAD</i>	<i>N 0 - 1/8 (0.077 mi.)</i>	<i>1</i>	<i>7</i>

EXECUTIVE SUMMARY

Due to poor or inadequate address information, the following sites were not mapped:

<u>Site Name</u>	<u>Database(s)</u>
VACANT LOT	UST
LORDSTOWN	UST
RALPHS SERVICE CENTER	UST
NATIONAL CAN CORP	FINDS, RCRA-NonGen
LORDSTOWN OH, 91.3 ON THE AKRON MA	ERNS
WHITESTONE SUPPLY CO LORDSTOWN YAR	FINDS
LORDSTOWN LOCAL SCHOOL	FINDS
LORDSTOWN CONSTRUCTION RECOVERY	FINDS, SPILLS
GENERAL MOTORS / LORDSTOWN	SPILLS
BOC GROUP LORDSTOWN GMC	SPILLS
LORDSTOWN ORDINANCE PLT	DERR
CSXT INC - LORDSTOWN YARD	NPDES

OVERVIEW MAP - 02559388.20r

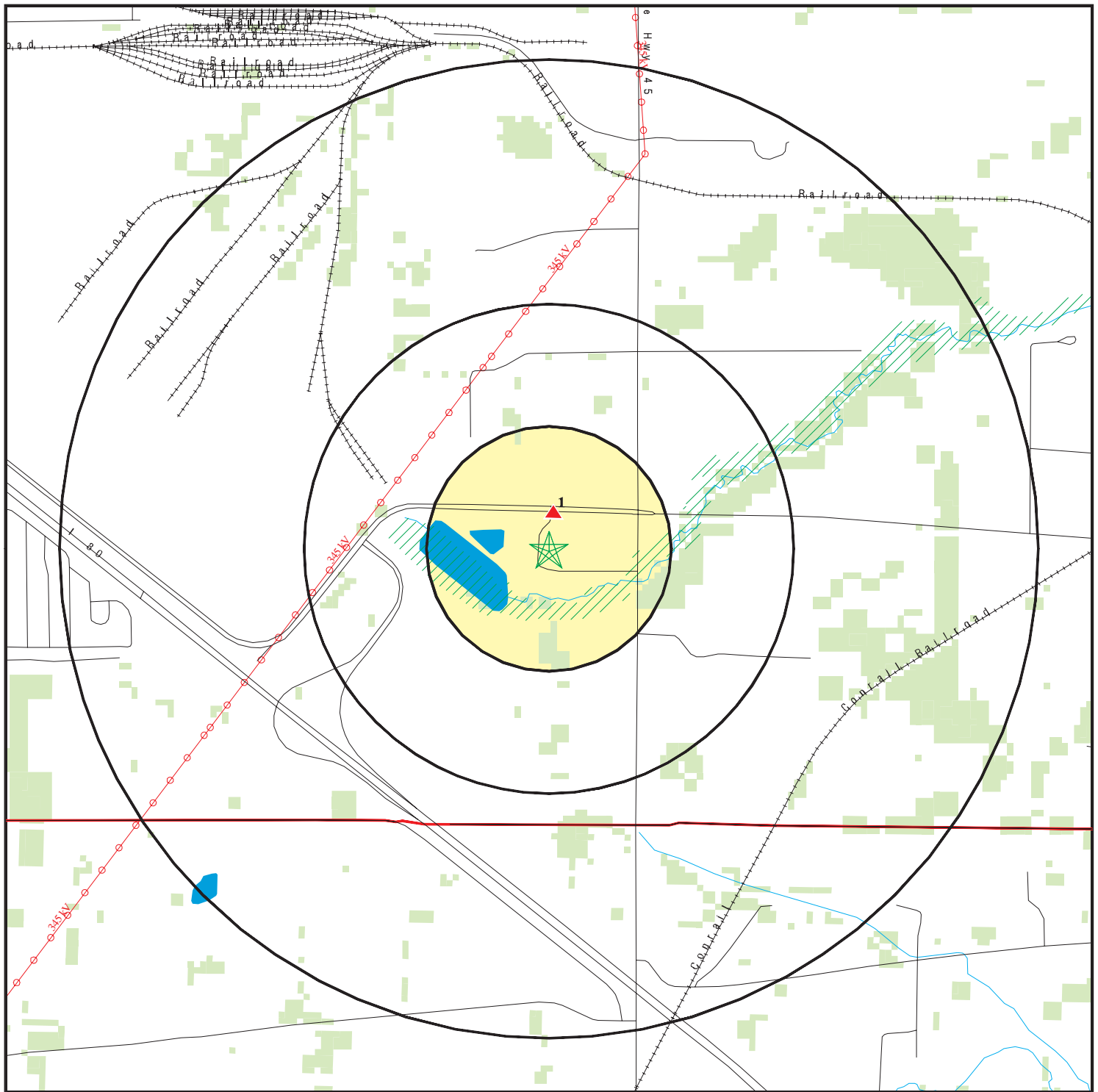

★ Target Property

▲ Sites at elevations higher than or equal to the target property

◆ Sites at elevations lower than the target property

▲ Manufactured Gas Plants

■ National Priority List Sites

■ Dept. Defense Sites

■ Indian Reservations BIA

■ County Boundary

■ Power transmission lines

■ Oil & Gas pipelines

■ 100-year flood zone

■ 500-year flood zone

■ National Wetland Inventory

■ State Wetlands

0 1/4 1/2 1 Miles



This report includes Interactive Map Layers to display and/or hide map information. The legend includes only those icons for the default map view.

SITE NAME: Lordstown Excess Land -Site ID 1011
ADDRESS: 1829 Hallock Young Road
Lordstown OH 44481
LAT/LONG: 41.1425 / 80.8606

CLIENT: LFR Inc
CONTACT: Rich Mall
INQUIRY #: 02559388.20r
DATE: August 07, 2009 10:34 am

DETAIL MAP - 02559388.20r

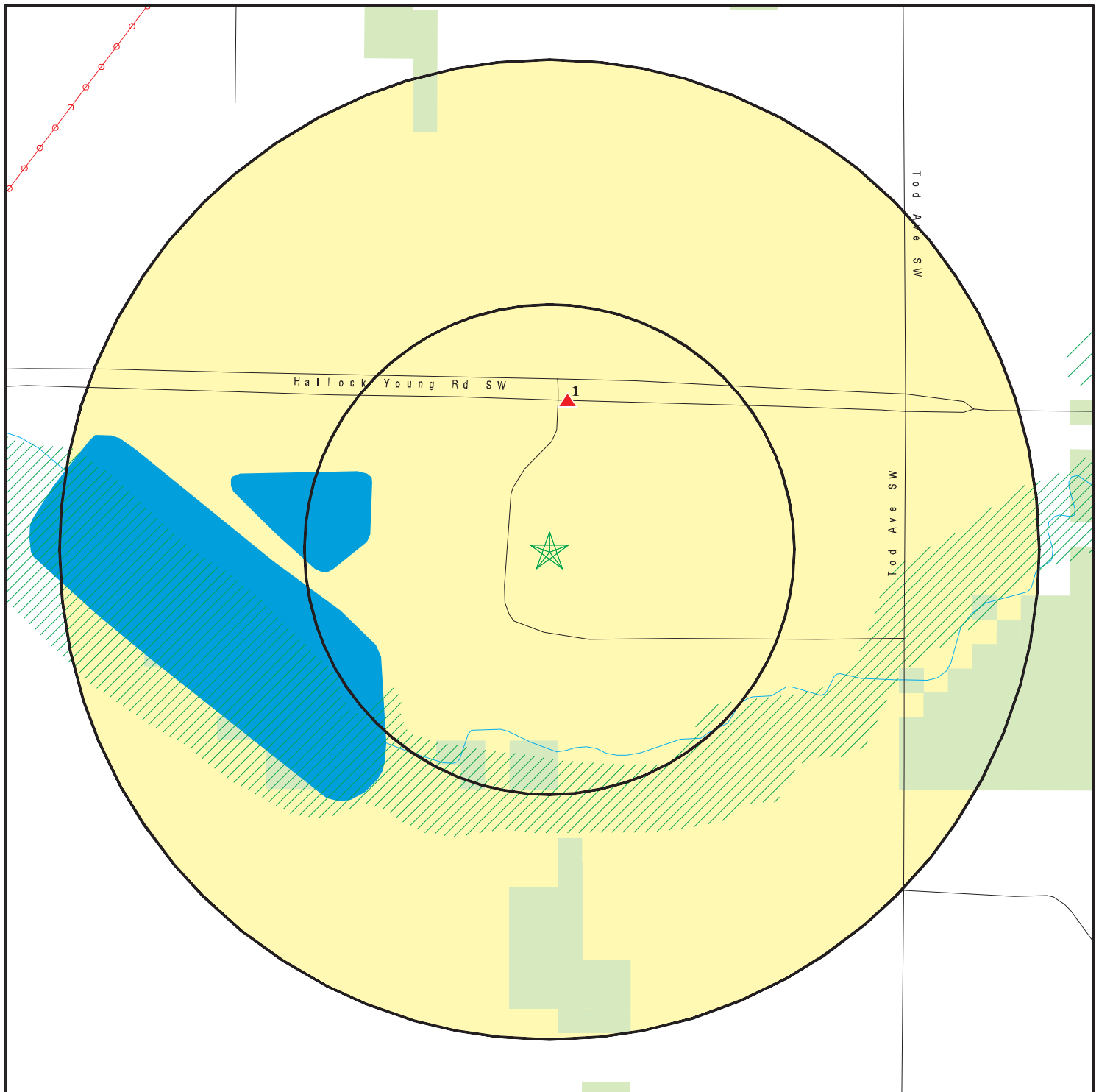

- ★ Target Property
- ▲ Sites at elevations higher than or equal to the target property
- ◆ Sites at elevations lower than the target property
- ⚙ Manufactured Gas Plants
- ⚡ Sensitive Receptors
- 🏠 National Priority List Sites
- 🏠 Dept. Defense Sites

- 🏠 Indian Reservations BIA
- ⚡ Power transmission lines
- ⚡ Oil & Gas pipelines
- 🌊 100-year flood zone
- 🌊 500-year flood zone
- 🌿 National Wetland Inventory
- 🌿 State Wetlands

This report includes Interactive Map Layers to display and/or hide map information. The legend includes only those icons for the default map view.

SITE NAME: Lordstown Excess Land -Site ID 1011
 ADDRESS: 1829 Hallock Young Road
 Lordstown OH 44481
 LAT/LONG: 41.1425 / 80.8606

CLIENT: LFR Inc
 CONTACT: Rich Mall
 INQUIRY #: 02559388.20r
 DATE: August 07, 2009 10:36 am

MAP FINDINGS SUMMARY

Database	Target Property	Search Distance (Miles)	< 1/8	1/8 - 1/4	1/4 - 1/2	1/2 - 1	> 1	Total Plotted
STANDARD ENVIRONMENTAL RECORDS								
<i>Federal NPL site list</i>								
NPL		1.000	0	0	0	0	NR	0
Proposed NPL		1.000	0	0	0	0	NR	0
NPL LIENS		TP	NR	NR	NR	NR	NR	0
<i>Federal Delisted NPL site list</i>								
Delisted NPL		1.000	0	0	0	0	NR	0
<i>Federal CERCLIS list</i>								
CERCLIS		0.500	0	0	0	NR	NR	0
<i>Federal CERCLIS NFRAP site List</i>								
CERC-NFRAP		0.500	0	0	0	NR	NR	0
<i>Federal RCRA CORRACTS facilities list</i>								
CORRACTS		1.000	0	0	0	0	NR	0
<i>Federal RCRA non-CORRACTS TSD facilities list</i>								
RCRA-TSDF		0.500	0	0	0	NR	NR	0
<i>Federal RCRA generators list</i>								
RCRA-LQG		0.250	0	0	NR	NR	NR	0
RCRA-SQG		0.250	0	0	NR	NR	NR	0
RCRA-CESQG		0.250	0	0	NR	NR	NR	0
<i>Federal institutional controls / engineering controls registries</i>								
US ENG CONTROLS		0.500	0	0	0	NR	NR	0
US INST CONTROL		0.500	0	0	0	NR	NR	0
<i>Federal ERNS list</i>								
ERNS		TP	NR	NR	NR	NR	NR	0
<i>State- and tribal - equivalent CERCLIS</i>								
SHWS		N/A	N/A	N/A	N/A	N/A	N/A	N/A
DERR		1.000	0	0	0	0	NR	0
<i>State and tribal landfill and/or solid waste disposal site lists</i>								
SWF/LF		0.500	0	0	0	NR	NR	0
<i>State and tribal leaking storage tank lists</i>								
LUST		0.500	0	0	0	NR	NR	0
UNREG LTANKS		0.500	0	0	0	NR	NR	0
INDIAN LUST		0.500	0	0	0	NR	NR	0
<i>State and tribal registered storage tank lists</i>								
UST		0.250	0	0	NR	NR	NR	0

MAP FINDINGS SUMMARY

Database	Target Property	Search Distance (Miles)	< 1/8	1/8 - 1/4	1/4 - 1/2	1/2 - 1	> 1	Total Plotted
INDIAN UST		0.250	0	0	NR	NR	NR	0
<i>State and tribal institutional control / engineering control registries</i>								
ENG CONTROLS		0.500	0	0	0	NR	NR	0
INST CONTROL		0.500	0	0	0	NR	NR	0
HIST ENG CONTROLS		0.500	0	0	0	NR	NR	0
HIST INST CONTROLS		0.500	0	0	0	NR	NR	0
<i>State and tribal voluntary cleanup sites</i>								
VCP		0.500	0	0	0	NR	NR	0
INDIAN VCP		0.500	0	0	0	NR	NR	0
<i>State and tribal Brownfields sites</i>								
BROWNFIELDS		0.500	0	0	0	NR	NR	0
<u>ADDITIONAL ENVIRONMENTAL RECORDS</u>								
<i>Local Brownfield lists</i>								
US BROWNFIELDS		0.500	0	0	0	NR	NR	0
<i>Local Lists of Landfill / Solid Waste Disposal Sites</i>								
ODI		0.500	0	0	0	NR	NR	0
DEBRIS REGION 9		0.500	0	0	0	NR	NR	0
HIST LF		0.500	0	0	0	NR	NR	0
INDIAN ODI		0.500	0	0	0	NR	NR	0
<i>Local Lists of Hazardous waste / Contaminated Sites</i>								
US CDL		TP	NR	NR	NR	NR	NR	0
CDL		TP	NR	NR	NR	NR	NR	0
<i>Local Lists of Registered Storage Tanks</i>								
ARCHIVE UST		0.250	0	0	NR	NR	NR	0
<i>Local Land Records</i>								
LIENS 2		TP	NR	NR	NR	NR	NR	0
LUCIS		0.500	0	0	0	NR	NR	0
<i>Records of Emergency Release Reports</i>								
HMIRS		TP	NR	NR	NR	NR	NR	0
SPILLS		TP	NR	NR	NR	NR	NR	0
<i>Other Ascertainable Records</i>								
RCRA-NonGen		0.250	1	0	NR	NR	NR	1
DOT OPS		TP	NR	NR	NR	NR	NR	0
DOD		1.000	0	0	0	0	NR	0
FUDS		1.000	0	0	0	0	NR	0
CONSENT		1.000	0	0	0	0	NR	0

MAP FINDINGS SUMMARY

Database	Target Property	Search Distance (Miles)	< 1/8	1/8 - 1/4	1/4 - 1/2	1/2 - 1	> 1	Total Plotted
ROD		1.000	0	0	0	0	NR	0
UMTRA		0.500	0	0	0	NR	NR	0
MINES		0.250	0	0	NR	NR	NR	0
TRIS	TP		NR	NR	NR	NR	NR	0
TSCA	TP		NR	NR	NR	NR	NR	0
FTTS	TP		NR	NR	NR	NR	NR	0
HIST FTTS	TP		NR	NR	NR	NR	NR	0
SSTS	TP		NR	NR	NR	NR	NR	0
ICIS	TP		NR	NR	NR	NR	NR	0
PADS	TP		NR	NR	NR	NR	NR	0
MLTS	TP		NR	NR	NR	NR	NR	0
RADINFO	TP		NR	NR	NR	NR	NR	0
FINDS	TP		NR	NR	NR	NR	NR	0
RAATS	TP		NR	NR	NR	NR	NR	0
TOWNGAS		1.000	0	0	0	0	NR	0
UIC	TP		NR	NR	NR	NR	NR	0
DRYCLEANERS		0.250	0	0	NR	NR	NR	0
NPDES	TP		NR	NR	NR	NR	NR	0
AIRS	TP		NR	NR	NR	NR	NR	0
USD		0.500	0	0	0	NR	NR	0
HIST USD		0.500	0	0	0	NR	NR	0
INDIAN RESERV		1.000	0	0	0	0	NR	0
SCRD DRYCLEANERS		0.500	0	0	0	NR	NR	0

EDR PROPRIETARY RECORDS

EDR Proprietary Records

Manufactured Gas Plants	1.000	0	0	0	0	NR	0
-------------------------	-------	---	---	---	---	----	---

NOTES:

TP = Target Property

NR = Not Requested at this Search Distance

Sites may be listed in more than one database

N/A = This State does not maintain a SHWS list. See the Federal CERCLIS list.

Map ID
Direction
Distance
Elevation

MAP FINDINGS

Site

Database(s)

EDR ID Number
EPA ID Number

1
North
< 1/8
0.077 mi.
406 ft.

CROWN DIVISIONS *
1757 HALLOCK YOUNG ROAD
WARREN, OH 44481

FINDS
RCRA-NonGen **1000437518**
OHD982610859

Relative:
Higher

FINDS:

Registry ID: 110009612865

Environmental Interest/Information System

RCRAInfo is a national information system that supports the Resource Conservation and Recovery Act (RCRA) program through the tracking of events and activities related to facilities that generate, transport, and treat, store, or dispose of hazardous waste. RCRAInfo allows RCRA program staff to track the notification, permit, compliance, and corrective action activities required under RCRA.

The OH-CORE (Ohio - Core) database contains information commonly shared among the Ohio EPA environmental programs. The information is facility-based, general in nature, and used to support specific programmatic systems while simultaneously maintaining an inventory of common facility-related data. Specific programmatic details are maintained in programmatic databases.

RCRA-NonGen:

Date form received by agency: 09/30/1996

Facility name: CROWN DIVISIONS

Facility address: 1757 HALLOCK RD
WARREN, OH 44481

EPA ID: OHD982610859

Mailing address: 1757 HALLOCK YOUNG RD
WARREN, OH 44481

Contact: SAMUEL WILKES

Contact address: 1757 HALLOCK YOUNG RD
WARREN, OH 44481

Contact country: US

Contact telephone: (216) 824-2524

Contact email: Not reported

EPA Region: 05

Classification: Non-Generator

Description: Handler: Non-Generators do not presently generate hazardous waste

Owner/Operator Summary:

Owner/operator name: NAME NOT REPORTED

Owner/operator address: ADDRESS NOT REPORTED
CITY NOT REPORTED, AK 99998

Owner/operator country: Not reported

Owner/operator telephone: (312) 555-1212

Legal status: Private

Owner/Operator Type: Operator

Owner/Op start date: Not reported

Owner/Op end date: Not reported

Owner/operator name: ALLEN GROUP

Owner/operator address: ADDRESS NOT REPORTED
CITY NOT REPORTED, AK 99998

Map ID
Direction
Distance
Elevation

MAP FINDINGS

Site

Database(s)

EDR ID Number
EPA ID Number

CROWN DIVISIONS * (Continued)

1000437518

Owner/operator country: Not reported
Owner/operator telephone: (312) 555-1212
Legal status: Private
Owner/Operator Type: Owner
Owner/Op start date: Not reported
Owner/Op end date: Not reported

Handler Activities Summary:

U.S. importer of hazardous waste: Unknown
Mixed waste (haz. and radioactive): Unknown
Recycler of hazardous waste: No
Transporter of hazardous waste: No
Treater, storer or disposer of HW: No
Underground injection activity: No
On-site burner exemption: Unknown
Furnace exemption: Unknown
Used oil fuel burner: No
Used oil processor: No
User oil refiner: No
Used oil fuel marketer to burner: No
Used oil Specification marketer: No
Used oil transfer facility: No
Used oil transporter: No
Off-site waste receiver: Commercial status unknown

Hazardous Waste Summary:

Waste code: D000
Waste name: Not Defined

Waste code: D001
Waste name: IGNITABLE HAZARDOUS WASTES ARE THOSE WASTES WHICH HAVE A FLASHPOINT OF LESS THAN 140 DEGREES FAHRENHEIT AS DETERMINED BY A PENSKEY-MARTENS CLOSED CUP FLASH POINT TESTER. ANOTHER METHOD OF DETERMINING THE FLASH POINT OF A WASTE IS TO REVIEW THE MATERIAL SAFETY DATA SHEET, WHICH CAN BE OBTAINED FROM THE MANUFACTURER OR DISTRIBUTOR OF THE MATERIAL. LACQUER THINNER IS AN EXAMPLE OF A COMMONLY USED SOLVENT WHICH WOULD BE CONSIDERED AS IGNITABLE HAZARDOUS WASTE.

Waste code: F003
Waste name: THE FOLLOWING SPENT NON-HALOGENATED SOLVENTS: XYLENE, ACETONE, ETHYL ACETATE, ETHYL BENZENE, ETHYL ETHER, METHYL ISOBUTYL KETONE, N-BUTYL ALCOHOL, CYCLOHEXANONE, AND METHANOL; ALL SPENT SOLVENT MIXTURES/BLENDS CONTAINING, BEFORE USE, ONLY THE ABOVE SPENT NON-HALOGENATED SOLVENTS; AND ALL SPENT SOLVENT MIXTURES/BLENDS CONTAINING, BEFORE USE, ONE OR MORE OF THE ABOVE NON-HALOGENATED SOLVENTS, AND, A TOTAL OF TEN PERCENT OR MORE (BY VOLUME) OF ONE OR MORE OF THOSE SOLVENTS LISTED IN F001, F002, F004, AND F005, AND STILL BOTTOMS FROM THE RECOVERY OF THESE SPENT SOLVENTS AND SPENT SOLVENT MIXTURES.

Waste code: F004
Waste name: THE FOLLOWING SPENT NON-HALOGENATED SOLVENTS: CRESOLS AND CRESYLIC ACID, AND NITROBENZENE; ALL SPENT SOLVENT MIXTURES/BLENDS CONTAINING, BEFORE USE, A TOTAL OF TEN PERCENT OR MORE (BY VOLUME) OF ONE OR MORE OF THE ABOVE NON-HALOGENATED SOLVENTS OR THOSE SOLVENTS LISTED IN F001, F002, AND F005; AND STILL BOTTOMS FROM THE RECOVERY OF THESE

Map ID
Direction
Distance
Elevation

MAP FINDINGS

Site

Database(s)

EDR ID Number
EPA ID Number

CROWN DIVISIONS * (Continued)

1000437518

SPENT SOLVENTS AND SPENT SOLVENT MIXTURES.

Waste code:

F005

Waste name:

THE FOLLOWING SPENT NON-HALOGENATED SOLVENTS: TOLUENE, METHYL ETHYL KETONE, CARBON DISULFIDE, ISOBUTANOL, PYRIDINE, BENZENE, 2-ETHOXYETHANOL, AND 2-NITROPROPANE; ALL SPENT SOLVENT MIXTURES/BLENDS CONTAINING, BEFORE USE, A TOTAL OF TEN PERCENT OR MORE (BY VOLUME) OF ONE OR MORE OF THE ABOVE NON-HALOGENATED SOLVENTS OR THOSE SOLVENTS LISTED IN F001, F002, OR F004; AND STILL BOTTOMS FROM THE RECOVERY OF THESE SPENT SOLVENTS AND SPENT SOLVENT MIXTURES.

Violation Status:

No violations found

ORPHAN SUMMARY

City	EDR ID	Site Name	Site Address	Zip	Database(s)
LORDSTOWN	U004103779	VACANT LOT	RT. 45 & SALT SPRINGS RD	44481	UST
LORDSTOWN	S106332842	GENERAL MOTORS / LORDSTOWN	950 HALLOCK-YOUNG ROAD	44481	SPILLS
LORDSTOWN	S108226491	CSXT INC - LORDSTOWN YARD	2128 LINTZ RD	44481	NPDES
LORDSTOWN	87933	LORDSTOWN OH, 91.3 ON THE AKRON MA	LORDSTOWN OH, 91.3 ON THE AKRO		ERNS
LORDSTOWN	1005800338	WHITESTONE SUPPLY CO LORDSTOWN YAR	ONE WARREN-SALEM RD	44481	FINDS
LORDSTOWN	S106473291	BOC GROUP LORDSTOWN GMC	SAME AS ABOVE		SPILLS
LORDSTOWN	S101871693	LORDSTOWN ORDINANCE PLT	STATE RTE 45-4 MI S OF WARREN	44481	DERR
LORDSTOWN	1005810892	LORDSTOWN LOCAL SCHOOL	6540 S TOD AVE	44481	FINDS
WARREN	1000260032	NATIONAL CAN CORP	1 AND 1 HALF MI S OF RTE 5	44481	FINDS, RCRA-NonGen
WARREN	U004095165	LORDSTOWN	6205 NEWTON FALLS BAILEY RD	44481	UST
WARREN	1007086311	LORDSTOWN CONSTRUCTION RECOVERY	6205 NEWTON FALLS BAILEY RD.	44481	FINDS, SPILLS
WARREN	U004099432	RALPHS SERVICE CENTER	2960 ST RT 5 SW	44481	UST

GOVERNMENT RECORDS SEARCHED / DATA CURRENCY TRACKING

To maintain currency of the following federal and state databases, EDR contacts the appropriate governmental agency on a monthly or quarterly basis, as required.

Number of Days to Update: Provides confirmation that EDR is reporting records that have been updated within 90 days from the date the government agency made the information available to the public.

STANDARD ENVIRONMENTAL RECORDS

Federal NPL site list

NPL: National Priority List

National Priorities List (Superfund). The NPL is a subset of CERCLIS and identifies over 1,200 sites for priority cleanup under the Superfund Program. NPL sites may encompass relatively large areas. As such, EDR provides polygon coverage for over 1,000 NPL site boundaries produced by EPA's Environmental Photographic Interpretation Center (EPIC) and regional EPA offices.

Date of Government Version: 02/02/2009	Source: EPA
Date Data Arrived at EDR: 02/12/2009	Telephone: N/A
Date Made Active in Reports: 03/30/2009	Last EDR Contact: 07/31/2009
Number of Days to Update: 46	Next Scheduled EDR Contact: 10/26/2009
	Data Release Frequency: Quarterly

NPL Site Boundaries

Sources:

EPA's Environmental Photographic Interpretation Center (EPIC)
Telephone: 202-564-7333

EPA Region 1
Telephone 617-918-1143

EPA Region 6
Telephone: 214-655-6659

EPA Region 3
Telephone 215-814-5418

EPA Region 7
Telephone: 913-551-7247

EPA Region 4
Telephone 404-562-8033

EPA Region 8
Telephone: 303-312-6774

EPA Region 5
Telephone 312-886-6686

EPA Region 9
Telephone: 415-947-4246

EPA Region 10
Telephone 206-553-8665

Proposed NPL: Proposed National Priority List Sites

A site that has been proposed for listing on the National Priorities List through the issuance of a proposed rule in the Federal Register. EPA then accepts public comments on the site, responds to the comments, and places on the NPL those sites that continue to meet the requirements for listing.

Date of Government Version: 04/23/2009	Source: EPA
Date Data Arrived at EDR: 04/28/2009	Telephone: N/A
Date Made Active in Reports: 05/19/2009	Last EDR Contact: 07/31/2009
Number of Days to Update: 21	Next Scheduled EDR Contact: 10/26/2009
	Data Release Frequency: Quarterly

NPL LIENS: Federal Superfund Liens

Federal Superfund Liens. Under the authority granted the USEPA by CERCLA of 1980, the USEPA has the authority to file liens against real property in order to recover remedial action expenditures or when the property owner received notification of potential liability. USEPA compiles a listing of filed notices of Superfund Liens.

Date of Government Version: 10/15/1991	Source: EPA
Date Data Arrived at EDR: 02/02/1994	Telephone: 202-564-4267
Date Made Active in Reports: 03/30/1994	Last EDR Contact: 05/17/2009
Number of Days to Update: 56	Next Scheduled EDR Contact: 08/17/2009
	Data Release Frequency: No Update Planned

GOVERNMENT RECORDS SEARCHED / DATA CURRENCY TRACKING

Federal Delisted NPL site list

DELISTED NPL: National Priority List Deletions

The National Oil and Hazardous Substances Pollution Contingency Plan (NCP) establishes the criteria that the EPA uses to delete sites from the NPL. In accordance with 40 CFR 300.425.(e), sites may be deleted from the NPL where no further response is appropriate.

Date of Government Version: 02/02/2009	Source: EPA
Date Data Arrived at EDR: 02/12/2009	Telephone: N/A
Date Made Active in Reports: 03/30/2009	Last EDR Contact: 07/31/2009
Number of Days to Update: 46	Next Scheduled EDR Contact: 10/26/2009
	Data Release Frequency: Quarterly

Federal CERCLIS list

CERCLIS: Comprehensive Environmental Response, Compensation, and Liability Information System

CERCLIS contains data on potentially hazardous waste sites that have been reported to the USEPA by states, municipalities, private companies and private persons, pursuant to Section 103 of the Comprehensive Environmental Response, Compensation, and Liability Act (CERCLA). CERCLIS contains sites which are either proposed to or on the National Priorities List (NPL) and sites which are in the screening and assessment phase for possible inclusion on the NPL.

Date of Government Version: 01/09/2009	Source: EPA
Date Data Arrived at EDR: 01/30/2009	Telephone: 703-412-9810
Date Made Active in Reports: 05/11/2009	Last EDR Contact: 07/14/2009
Number of Days to Update: 101	Next Scheduled EDR Contact: 10/12/2009
	Data Release Frequency: Quarterly

Federal CERCLIS NFRAP site List

CERCLIS-NFRAP: CERCLIS No Further Remedial Action Planned

Archived sites are sites that have been removed and archived from the inventory of CERCLIS sites. Archived status indicates that, to the best of EPA's knowledge, assessment at a site has been completed and that EPA has determined no further steps will be taken to list this site on the National Priorities List (NPL), unless information indicates this decision was not appropriate or other considerations require a recommendation for listing at a later time. This decision does not necessarily mean that there is no hazard associated with a given site; it only means that, based upon available information, the location is not judged to be a potential NPL site.

Date of Government Version: 12/03/2007	Source: EPA
Date Data Arrived at EDR: 12/06/2007	Telephone: 703-412-9810
Date Made Active in Reports: 02/20/2008	Last EDR Contact: 06/15/2009
Number of Days to Update: 76	Next Scheduled EDR Contact: 09/14/2009
	Data Release Frequency: Quarterly

Federal RCRA CORRACTS facilities list

CORRACTS: Corrective Action Report

CORRACTS identifies hazardous waste handlers with RCRA corrective action activity.

Date of Government Version: 03/25/2009	Source: EPA
Date Data Arrived at EDR: 04/02/2009	Telephone: 800-424-9346
Date Made Active in Reports: 05/11/2009	Last EDR Contact: 06/01/2009
Number of Days to Update: 39	Next Scheduled EDR Contact: 08/31/2009
	Data Release Frequency: Quarterly

Federal RCRA non-CORRACTS TSD facilities list

RCRA-TSDF: RCRA - Transporters, Storage and Disposal

RCRAInfo is EPA's comprehensive information system, providing access to data supporting the Resource Conservation and Recovery Act (RCRA) of 1976 and the Hazardous and Solid Waste Amendments (HSWA) of 1984. The database includes selective information on sites which generate, transport, store, treat and/or dispose of hazardous waste as defined by the Resource Conservation and Recovery Act (RCRA). Transporters are individuals or entities that move hazardous waste from the generator offsite to a facility that can recycle, treat, store, or dispose of the waste. TSDFs treat, store, or dispose of the waste.

GOVERNMENT RECORDS SEARCHED / DATA CURRENCY TRACKING

Date of Government Version: 11/12/2008
Date Data Arrived at EDR: 11/18/2008
Date Made Active in Reports: 03/16/2009
Number of Days to Update: 118

Source: Environmental Protection Agency
Telephone: 312-886-6186
Last EDR Contact: 07/23/2009
Next Scheduled EDR Contact: 10/19/2009
Data Release Frequency: Quarterly

Federal RCRA generators list

RCRA-LQG: RCRA - Large Quantity Generators

RCRAInfo is EPA's comprehensive information system, providing access to data supporting the Resource Conservation and Recovery Act (RCRA) of 1976 and the Hazardous and Solid Waste Amendments (HSWA) of 1984. The database includes selective information on sites which generate, transport, store, treat and/or dispose of hazardous waste as defined by the Resource Conservation and Recovery Act (RCRA). Large quantity generators (LQGs) generate over 1,000 kilograms (kg) of hazardous waste, or over 1 kg of acutely hazardous waste per month.

Date of Government Version: 11/12/2008
Date Data Arrived at EDR: 11/18/2008
Date Made Active in Reports: 03/16/2009
Number of Days to Update: 118

Source: Environmental Protection Agency
Telephone: 312-886-6186
Last EDR Contact: 07/23/2009
Next Scheduled EDR Contact: 10/19/2009
Data Release Frequency: Quarterly

RCRA-SQG: RCRA - Small Quantity Generators

RCRAInfo is EPA's comprehensive information system, providing access to data supporting the Resource Conservation and Recovery Act (RCRA) of 1976 and the Hazardous and Solid Waste Amendments (HSWA) of 1984. The database includes selective information on sites which generate, transport, store, treat and/or dispose of hazardous waste as defined by the Resource Conservation and Recovery Act (RCRA). Small quantity generators (SQGs) generate between 100 kg and 1,000 kg of hazardous waste per month.

Date of Government Version: 11/12/2008
Date Data Arrived at EDR: 11/18/2008
Date Made Active in Reports: 03/16/2009
Number of Days to Update: 118

Source: Environmental Protection Agency
Telephone: 312-886-6186
Last EDR Contact: 07/23/2009
Next Scheduled EDR Contact: 10/19/2009
Data Release Frequency: Quarterly

RCRA-CESQG: RCRA - Conditionally Exempt Small Quantity Generators

RCRAInfo is EPA's comprehensive information system, providing access to data supporting the Resource Conservation and Recovery Act (RCRA) of 1976 and the Hazardous and Solid Waste Amendments (HSWA) of 1984. The database includes selective information on sites which generate, transport, store, treat and/or dispose of hazardous waste as defined by the Resource Conservation and Recovery Act (RCRA). Conditionally exempt small quantity generators (CESQGs) generate less than 100 kg of hazardous waste, or less than 1 kg of acutely hazardous waste per month.

Date of Government Version: 11/12/2008
Date Data Arrived at EDR: 11/18/2008
Date Made Active in Reports: 03/16/2009
Number of Days to Update: 118

Source: Environmental Protection Agency
Telephone: 312-886-6186
Last EDR Contact: 07/23/2009
Next Scheduled EDR Contact: 10/19/2009
Data Release Frequency: Varies

Federal institutional controls / engineering controls registries

US ENG CONTROLS: Engineering Controls Sites List

A listing of sites with engineering controls in place. Engineering controls include various forms of caps, building foundations, liners, and treatment methods to create pathway elimination for regulated substances to enter environmental media or effect human health.

Date of Government Version: 03/31/2009
Date Data Arrived at EDR: 04/22/2009
Date Made Active in Reports: 05/05/2009
Number of Days to Update: 13

Source: Environmental Protection Agency
Telephone: 703-603-0695
Last EDR Contact: 06/29/2009
Next Scheduled EDR Contact: 09/28/2009
Data Release Frequency: Varies

GOVERNMENT RECORDS SEARCHED / DATA CURRENCY TRACKING

US INST CONTROL: Sites with Institutional Controls

A listing of sites with institutional controls in place. Institutional controls include administrative measures, such as groundwater use restrictions, construction restrictions, property use restrictions, and post remediation care requirements intended to prevent exposure to contaminants remaining on site. Deed restrictions are generally required as part of the institutional controls.

Date of Government Version: 03/31/2009
Date Data Arrived at EDR: 04/22/2009
Date Made Active in Reports: 05/05/2009
Number of Days to Update: 13

Source: Environmental Protection Agency
Telephone: 703-603-0695
Last EDR Contact: 06/29/2009
Next Scheduled EDR Contact: 09/28/2009
Data Release Frequency: Varies

Federal ERNS list

ERNS: Emergency Response Notification System

Emergency Response Notification System. ERNS records and stores information on reported releases of oil and hazardous substances.

Date of Government Version: 12/31/2008
Date Data Arrived at EDR: 01/30/2009
Date Made Active in Reports: 05/19/2009
Number of Days to Update: 109

Source: National Response Center, United States Coast Guard
Telephone: 202-267-2180
Last EDR Contact: 07/21/2009
Next Scheduled EDR Contact: 10/19/2009
Data Release Frequency: Annually

State- and tribal - equivalent CERCLIS

SHWS: This state does not maintain a SHWS list. See the Federal CERCLIS list and Federal NPL list.

State Hazardous Waste Sites. State hazardous waste site records are the states' equivalent to CERCLIS. These sites may or may not already be listed on the federal CERCLIS list. Priority sites planned for cleanup using state funds (state equivalent of Superfund) are identified along with sites where cleanup will be paid for by potentially responsible parties. Available information varies by state.

Date of Government Version: N/A
Date Data Arrived at EDR: N/A
Date Made Active in Reports: N/A
Number of Days to Update: N/A

Source: Ohio EPA
Telephone: 614-644-2924
Last EDR Contact: 06/01/2009
Next Scheduled EDR Contact: 08/31/2009
Data Release Frequency: N/A

DERR: Division of Emergency & Remedial Response's Database

The DERR listings contains sites from all of Ohio that are in the Division of Emergency and Remedial Response (DERR) database, which is an index of sites for which our district offices maintain files. The database is NOT a record of contaminated sites or sites suspected of contamination. Not all sites in the database are contaminated, and a site's absence from the database does not imply that it is uncontaminated.

Date of Government Version: 06/08/2009
Date Data Arrived at EDR: 06/09/2009
Date Made Active in Reports: 07/06/2009
Number of Days to Update: 27

Source: Ohio EPA, Div. of Emergency and Remedial Response
Telephone: 614-644-3538
Last EDR Contact: 06/08/2009
Next Scheduled EDR Contact: 09/07/2009
Data Release Frequency: Semi-Annually

State and tribal landfill and/or solid waste disposal site lists

SWF/LF: Licensed Solid Waste Facilities

Solid Waste Facilities/Landfill Sites. SWF/LF type records typically contain an inventory of solid waste disposal facilities or landfills in a particular state. Depending on the state, these may be active or inactive facilities or open dumps that failed to meet RCRA Subtitle D Section 4004 criteria for solid waste landfills or disposal sites.

Date of Government Version: 05/06/2009
Date Data Arrived at EDR: 05/06/2009
Date Made Active in Reports: 06/05/2009
Number of Days to Update: 30

Source: Ohio Environmental Protection Agency
Telephone: 614-644-2621
Last EDR Contact: 08/03/2009
Next Scheduled EDR Contact: 11/02/2009
Data Release Frequency: Annually

GOVERNMENT RECORDS SEARCHED / DATA CURRENCY TRACKING

State and tribal leaking storage tank lists

LUST: Leaking Underground Storage Tank File

Leaking Underground Storage Tank Incident Reports. LUST records contain an inventory of reported leaking underground storage tank incidents. Not all states maintain these records, and the information stored varies by state.

Date of Government Version: 06/09/2009	Source: Department of Commerce
Date Data Arrived at EDR: 06/10/2009	Telephone: 614-752-7924
Date Made Active in Reports: 07/06/2009	Last EDR Contact: 06/10/2009
Number of Days to Update: 26	Next Scheduled EDR Contact: 09/07/2009
	Data Release Frequency: Quarterly

UNREG LTANKS: Ohio Leaking UST File

A suspected or confirmed release of petroleum from a non-regulated UST.

Date of Government Version: 08/25/1999	Source: Department of Commerce
Date Data Arrived at EDR: 08/19/2003	Telephone: 614-752-7938
Date Made Active in Reports: 08/26/2003	Last EDR Contact: 08/01/2003
Number of Days to Update: 7	Next Scheduled EDR Contact: N/A
	Data Release Frequency: No Update Planned

INDIAN LUST R1: Leaking Underground Storage Tanks on Indian Land

A listing of leaking underground storage tank locations on Indian Land.

Date of Government Version: 02/19/2009	Source: EPA Region 1
Date Data Arrived at EDR: 02/19/2009	Telephone: 617-918-1313
Date Made Active in Reports: 03/16/2009	Last EDR Contact: 05/17/2009
Number of Days to Update: 25	Next Scheduled EDR Contact: 08/17/2009
	Data Release Frequency: Varies

INDIAN LUST R4: Leaking Underground Storage Tanks on Indian Land

LUSTs on Indian land in Florida, Mississippi and North Carolina.

Date of Government Version: 02/24/2009	Source: EPA Region 4
Date Data Arrived at EDR: 03/03/2009	Telephone: 404-562-8677
Date Made Active in Reports: 05/05/2009	Last EDR Contact: 05/17/2009
Number of Days to Update: 63	Next Scheduled EDR Contact: 08/17/2009
	Data Release Frequency: Semi-Annually

INDIAN LUST R6: Leaking Underground Storage Tanks on Indian Land

LUSTs on Indian land in New Mexico and Oklahoma.

Date of Government Version: 05/20/2009	Source: EPA Region 6
Date Data Arrived at EDR: 05/20/2009	Telephone: 214-665-6597
Date Made Active in Reports: 05/29/2009	Last EDR Contact: 05/17/2009
Number of Days to Update: 9	Next Scheduled EDR Contact: 08/17/2009
	Data Release Frequency: Varies

INDIAN LUST R7: Leaking Underground Storage Tanks on Indian Land

LUSTs on Indian land in Iowa, Kansas, and Nebraska

Date of Government Version: 03/24/2009	Source: EPA Region 7
Date Data Arrived at EDR: 05/20/2009	Telephone: 913-551-7003
Date Made Active in Reports: 06/17/2009	Last EDR Contact: 05/20/2009
Number of Days to Update: 28	Next Scheduled EDR Contact: 08/17/2009
	Data Release Frequency: Varies

INDIAN LUST R8: Leaking Underground Storage Tanks on Indian Land

LUSTs on Indian land in Colorado, Montana, North Dakota, South Dakota, Utah and Wyoming.

GOVERNMENT RECORDS SEARCHED / DATA CURRENCY TRACKING

Date of Government Version: 06/01/2009
Date Data Arrived at EDR: 06/03/2009
Date Made Active in Reports: 06/17/2009
Number of Days to Update: 14

Source: EPA Region 8
Telephone: 303-312-6271
Last EDR Contact: 05/17/2009
Next Scheduled EDR Contact: 08/17/2009
Data Release Frequency: Quarterly

INDIAN LUST R9: Leaking Underground Storage Tanks on Indian Land
LUSTs on Indian land in Arizona, California, New Mexico and Nevada

Date of Government Version: 12/15/2008
Date Data Arrived at EDR: 12/16/2008
Date Made Active in Reports: 03/16/2009
Number of Days to Update: 90

Source: Environmental Protection Agency
Telephone: 415-972-3372
Last EDR Contact: 05/17/2009
Next Scheduled EDR Contact: 08/17/2009
Data Release Frequency: Quarterly

INDIAN LUST R10: Leaking Underground Storage Tanks on Indian Land
LUSTs on Indian land in Alaska, Idaho, Oregon and Washington.

Date of Government Version: 06/04/2009
Date Data Arrived at EDR: 06/05/2009
Date Made Active in Reports: 06/17/2009
Number of Days to Update: 12

Source: EPA Region 10
Telephone: 206-553-2857
Last EDR Contact: 05/17/2009
Next Scheduled EDR Contact: 08/17/2009
Data Release Frequency: Quarterly

State and tribal registered storage tank lists

UST: Underground Storage Tank File

Registered Underground Storage Tanks. UST's are regulated under Subtitle I of the Resource Conservation and Recovery Act (RCRA) and must be registered with the state department responsible for administering the UST program. Available information varies by state program.

Date of Government Version: 06/01/2009
Date Data Arrived at EDR: 06/01/2009
Date Made Active in Reports: 07/02/2009
Number of Days to Update: 31

Source: Department of Commerce
Telephone: 614-752-7938
Last EDR Contact: 06/08/2009
Next Scheduled EDR Contact: 09/07/2009
Data Release Frequency: Quarterly

INDIAN UST R8: Underground Storage Tanks on Indian Land

The Indian Underground Storage Tank (UST) database provides information about underground storage tanks on Indian land in EPA Region 8 (Colorado, Montana, North Dakota, South Dakota, Utah, Wyoming and 27 Tribal Nations).

Date of Government Version: 06/01/2009
Date Data Arrived at EDR: 06/03/2009
Date Made Active in Reports: 06/17/2009
Number of Days to Update: 14

Source: EPA Region 8
Telephone: 303-312-6137
Last EDR Contact: 05/17/2009
Next Scheduled EDR Contact: 08/17/2009
Data Release Frequency: Quarterly

INDIAN UST R7: Underground Storage Tanks on Indian Land

The Indian Underground Storage Tank (UST) database provides information about underground storage tanks on Indian land in EPA Region 7 (Iowa, Kansas, Missouri, Nebraska, and 9 Tribal Nations).

Date of Government Version: 04/01/2008
Date Data Arrived at EDR: 12/30/2008
Date Made Active in Reports: 03/16/2009
Number of Days to Update: 76

Source: EPA Region 7
Telephone: 913-551-7003
Last EDR Contact: 05/22/2009
Next Scheduled EDR Contact: 08/17/2009
Data Release Frequency: Varies

INDIAN UST R6: Underground Storage Tanks on Indian Land

The Indian Underground Storage Tank (UST) database provides information about underground storage tanks on Indian land in EPA Region 6 (Louisiana, Arkansas, Oklahoma, New Mexico, Texas and 65 Tribes).

GOVERNMENT RECORDS SEARCHED / DATA CURRENCY TRACKING

Date of Government Version: 05/20/2009
Date Data Arrived at EDR: 05/20/2009
Date Made Active in Reports: 05/29/2009
Number of Days to Update: 9

Source: EPA Region 6
Telephone: 214-665-7591
Last EDR Contact: 05/17/2009
Next Scheduled EDR Contact: 08/17/2009
Data Release Frequency: Semi-Annually

INDIAN UST R5: Underground Storage Tanks on Indian Land

The Indian Underground Storage Tank (UST) database provides information about underground storage tanks on Indian land in EPA Region 5 (Michigan, Minnesota and Wisconsin and Tribal Nations).

Date of Government Version: 09/08/2008
Date Data Arrived at EDR: 09/19/2008
Date Made Active in Reports: 10/16/2008
Number of Days to Update: 27

Source: EPA Region 5
Telephone: 312-886-6136
Last EDR Contact: 05/17/2009
Next Scheduled EDR Contact: 08/17/2009
Data Release Frequency: Varies

INDIAN UST R9: Underground Storage Tanks on Indian Land

The Indian Underground Storage Tank (UST) database provides information about underground storage tanks on Indian land in EPA Region 9 (Arizona, California, Hawaii, Nevada, the Pacific Islands, and Tribal Nations).

Date of Government Version: 12/15/2008
Date Data Arrived at EDR: 12/16/2008
Date Made Active in Reports: 03/16/2009
Number of Days to Update: 90

Source: EPA Region 9
Telephone: 415-972-3368
Last EDR Contact: 05/17/2009
Next Scheduled EDR Contact: 08/17/2009
Data Release Frequency: Quarterly

INDIAN UST R4: Underground Storage Tanks on Indian Land

The Indian Underground Storage Tank (UST) database provides information about underground storage tanks on Indian land in EPA Region 4 (Alabama, Florida, Georgia, Kentucky, Mississippi, North Carolina, South Carolina, Tennessee and Tribal Nations)

Date of Government Version: 02/24/2009
Date Data Arrived at EDR: 03/03/2009
Date Made Active in Reports: 05/05/2009
Number of Days to Update: 63

Source: EPA Region 4
Telephone: 404-562-9424
Last EDR Contact: 05/17/2009
Next Scheduled EDR Contact: 08/17/2009
Data Release Frequency: Semi-Annually

INDIAN UST R10: Underground Storage Tanks on Indian Land

The Indian Underground Storage Tank (UST) database provides information about underground storage tanks on Indian land in EPA Region 10 (Alaska, Idaho, Oregon, Washington, and Tribal Nations).

Date of Government Version: 06/04/2009
Date Data Arrived at EDR: 06/05/2009
Date Made Active in Reports: 06/17/2009
Number of Days to Update: 12

Source: EPA Region 10
Telephone: 206-553-2857
Last EDR Contact: 05/17/2009
Next Scheduled EDR Contact: 08/17/2009
Data Release Frequency: Quarterly

INDIAN UST R1: Underground Storage Tanks on Indian Land

The Indian Underground Storage Tank (UST) database provides information about underground storage tanks on Indian land in EPA Region 1 (Connecticut, Maine, Massachusetts, New Hampshire, Rhode Island, Vermont and ten Tribal Nations).

Date of Government Version: 02/19/2009
Date Data Arrived at EDR: 02/19/2009
Date Made Active in Reports: 03/16/2009
Number of Days to Update: 25

Source: EPA, Region 1
Telephone: 617-918-1313
Last EDR Contact: 05/17/2009
Next Scheduled EDR Contact: 08/17/2009
Data Release Frequency: Varies

State and tribal institutional control / engineering control registries

GOVERNMENT RECORDS SEARCHED / DATA CURRENCY TRACKING

ENG CONTROLS: Sites with Engineering Controls

A database that tracks properties with engineering controls.

Date of Government Version: 06/01/2009	Source: Ohio EPA
Date Data Arrived at EDR: 06/03/2009	Telephone: 614-644-2306
Date Made Active in Reports: 07/06/2009	Last EDR Contact: 06/01/2009
Number of Days to Update: 33	Next Scheduled EDR Contact: 08/31/2009
	Data Release Frequency: Semi-Annually

INST CONTROL: Sites with Institutional Engineering Controls

A database that tracks properties with institutional controls.

Date of Government Version: 06/01/2009	Source: Ohio Environmental Protection Agency
Date Data Arrived at EDR: 06/03/2009	Telephone: 614-644-2306
Date Made Active in Reports: 07/06/2009	Last EDR Contact: 06/01/2009
Number of Days to Update: 33	Next Scheduled EDR Contact: 08/31/2009
	Data Release Frequency: Semi-Annually

HIST ENG CONTROLS: Operation & Maintenance Agreements Database

Volunteers that complete a voluntary action that relies on the ongoing operation and maintenance (O&M) of an engineered control to make the site protective (e.g" cap systems and ground water treatment systems) must enter into a legally binding agreement with the Ohio EPA before the director issues a covenant not to sue. This O&M Agreement must describe how the remedy is constructed and how it will be monitored, maintained and repaired. It also lays out inspection opportunities for the agency. Companies must document that they have the financial capability to operate any remedy relied on, before the agency will agree to enter into the O&M Agreement. The statute requires that the agency be notified of any change in ownership. This database is no longer updated or maintained by the state agency.

Date of Government Version: 05/10/2005	Source: Ohio EPA
Date Data Arrived at EDR: 04/04/2006	Telephone: 614-644-2306
Date Made Active in Reports: 05/04/2006	Last EDR Contact: 06/02/2008
Number of Days to Update: 30	Next Scheduled EDR Contact: 09/01/2008
	Data Release Frequency: No Update Planned

HIST INST CONTROLS: Institutional Controls Database

"Institutional control" is a restriction that is recorded in the same manner as a deed which limits access to or use of the property such that exposure to hazardous substances or petroleum are effectively and reliably eliminated or mitigated. Examples of institutional controls include land and water use restrictions. This database is no longer updated or maintained by the state agency.

Date of Government Version: 05/10/2005	Source: Ohio EPA
Date Data Arrived at EDR: 04/06/2006	Telephone: 614-644-2306
Date Made Active in Reports: 05/04/2006	Last EDR Contact: 06/02/2008
Number of Days to Update: 28	Next Scheduled EDR Contact: 09/01/2008
	Data Release Frequency: No Update Planned

State and tribal voluntary cleanup sites

INDIAN VCP R7: Voluntary Cleanup Priority Listing

A listing of voluntary cleanup priority sites located on Indian Land located in Region 7.

Date of Government Version: 03/20/2008	Source: EPA, Region 7
Date Data Arrived at EDR: 04/22/2008	Telephone: 913-551-7365
Date Made Active in Reports: 05/19/2008	Last EDR Contact: 04/20/2009
Number of Days to Update: 27	Next Scheduled EDR Contact: 07/20/2009
	Data Release Frequency: Varies

VCP: Voluntary Action Program Sites

Site involved in the Voluntary Action Program.

GOVERNMENT RECORDS SEARCHED / DATA CURRENCY TRACKING

Date of Government Version: 06/01/2009
Date Data Arrived at EDR: 06/03/2009
Date Made Active in Reports: 07/06/2009
Number of Days to Update: 33

Source: Ohio EPA, Voluntary Action Program
Telephone: 614-728-1298
Last EDR Contact: 06/01/2009
Next Scheduled EDR Contact: 08/31/2009
Data Release Frequency: Semi-Annually

INDIAN VCP R1: Voluntary Cleanup Priority Listing

A listing of voluntary cleanup priority sites located on Indian Land located in Region 1.

Date of Government Version: 04/02/2008
Date Data Arrived at EDR: 04/22/2008
Date Made Active in Reports: 05/19/2008
Number of Days to Update: 27

Source: EPA, Region 1
Telephone: 617-918-1102
Last EDR Contact: 07/20/2009
Next Scheduled EDR Contact: 10/19/2009
Data Release Frequency: Varies

State and tribal Brownfields sites

BROWNFIELDS: Ohio Brownfield Inventory

A statewide brownfields inventory. A brownfield is an abandoned, idled or under-used industrial or commercial property where expansion or redevelopment is complicated by known or potential releases of hazardous substances and/or petroleum.

Date of Government Version: 02/25/2009
Date Data Arrived at EDR: 04/10/2009
Date Made Active in Reports: 04/24/2009
Number of Days to Update: 14

Source: Ohio EPA
Telephone: 614-644-3748
Last EDR Contact: 07/20/2009
Next Scheduled EDR Contact: 10/05/2009
Data Release Frequency: Varies

ADDITIONAL ENVIRONMENTAL RECORDS

Local Brownfield lists

US BROWNFIELDS: A Listing of Brownfields Sites

Included in the listing are brownfields properties addresses by Cooperative Agreement Recipients and brownfields properties addressed by Targeted Brownfields Assessments. Targeted Brownfields Assessments-EPA's Targeted Brownfields Assessments (TBA) program is designed to help states, tribes, and municipalities--especially those without EPA Brownfields Assessment Demonstration Pilots--minimize the uncertainties of contamination often associated with brownfields. Under the TBA program, EPA provides funding and/or technical assistance for environmental assessments at brownfields sites throughout the country. Targeted Brownfields Assessments supplement and work with other efforts under EPA's Brownfields Initiative to promote cleanup and redevelopment of brownfields. Cooperative Agreement Recipients-States, political subdivisions, territories, and Indian tribes become Brownfields Cleanup Revolving Loan Fund (BCRLF) cooperative agreement recipients when they enter into BCRLF cooperative agreements with the U.S. EPA. EPA selects BCRLF cooperative agreement recipients based on a proposal and application process. BCRLF cooperative agreement recipients must use EPA funds provided through BCRLF cooperative agreement for specified brownfields-related cleanup activities.

Date of Government Version: 10/01/2008
Date Data Arrived at EDR: 11/14/2008
Date Made Active in Reports: 12/23/2008
Number of Days to Update: 39

Source: Environmental Protection Agency
Telephone: 202-566-2777
Last EDR Contact: 07/14/2009
Next Scheduled EDR Contact: 10/12/2009
Data Release Frequency: Semi-Annually

Local Lists of Landfill / Solid Waste Disposal Sites

ODI: Open Dump Inventory

An open dump is defined as a disposal facility that does not comply with one or more of the Part 257 or Part 258 Subtitle D Criteria.

Date of Government Version: 06/30/1985
Date Data Arrived at EDR: 08/09/2004
Date Made Active in Reports: 09/17/2004
Number of Days to Update: 39

Source: Environmental Protection Agency
Telephone: 800-424-9346
Last EDR Contact: 06/09/2004
Next Scheduled EDR Contact: N/A
Data Release Frequency: No Update Planned

GOVERNMENT RECORDS SEARCHED / DATA CURRENCY TRACKING

DEBRIS REGION 9: Torres Martinez Reservation Illegal Dump Site Locations

A listing of illegal dump sites location on the Torres Martinez Indian Reservation located in eastern Riverside County and northern Imperial County, California.

Date of Government Version: 03/25/2008	Source: EPA, Region 9
Date Data Arrived at EDR: 04/17/2008	Telephone: 415-972-3336
Date Made Active in Reports: 05/15/2008	Last EDR Contact: 07/13/2009
Number of Days to Update: 28	Next Scheduled EDR Contact: 09/21/2009
	Data Release Frequency: Varies

HIST LF: Old Solid Waste Landfill

A list of about 1200 old abandoned dumps or landfills. This database was developed from Ohio EPA staff notebooks and other information dating from the mid-1970s

Date of Government Version: 01/01/1980	Source: Ohio EPA
Date Data Arrived at EDR: 07/01/2003	Telephone: 614-644-3749
Date Made Active in Reports: 07/17/2003	Last EDR Contact: 06/26/2003
Number of Days to Update: 16	Next Scheduled EDR Contact: N/A
	Data Release Frequency: No Update Planned

INDIAN ODI: Report on the Status of Open Dumps on Indian Lands

Location of open dumps on Indian land.

Date of Government Version: 12/31/1998	Source: Environmental Protection Agency
Date Data Arrived at EDR: 12/03/2007	Telephone: 703-308-8245
Date Made Active in Reports: 01/24/2008	Last EDR Contact: 05/26/2009
Number of Days to Update: 52	Next Scheduled EDR Contact: 08/24/2009
	Data Release Frequency: Varies

Local Lists of Hazardous waste / Contaminated Sites

CDL: Clandestine Drug Labs

A listing of clandestine drug lab locations. The U.S. Department of Justice ("the Department") provides this web site as a public service. It contains addresses of some locations where law enforcement agencies reported they found chemicals or other items that indicated the presence of either clandestine drug laboratories or dumpsites. In most cases, the source of the entries is not the Department, and the Department has not verified the entry and does not guarantee its accuracy. Members of the public must verify the accuracy of all entries by, for example, contacting local law enforcement and local health departments.

Date of Government Version: 07/01/2008	Source: Drug Enforcement Administration
Date Data Arrived at EDR: 10/31/2008	Telephone: 202-307-1000
Date Made Active in Reports: 12/23/2008	Last EDR Contact: 03/26/2009
Number of Days to Update: 53	Next Scheduled EDR Contact: 06/22/2009
	Data Release Frequency: Quarterly

CDL: Clandestine Drug Lab Locations

A list of clandestine drug lab sites with environmental impact. This list is extracted from the SPILLS database based on the "product" type.

Date of Government Version: 03/01/2008	Source: Ohio EPA
Date Data Arrived at EDR: 03/14/2008	Telephone: 614-644-2080
Date Made Active in Reports: 03/24/2008	Last EDR Contact: 06/01/2009
Number of Days to Update: 10	Next Scheduled EDR Contact: 08/31/2009
	Data Release Frequency: Varies

Local Lists of Registered Storage Tanks

ARCHIVE UST: Archived Underground Storage Tank Sites

Underground storage tank records that have been removed from the Underground Storage Tank database.

GOVERNMENT RECORDS SEARCHED / DATA CURRENCY TRACKING

Date of Government Version: 06/01/2009
Date Data Arrived at EDR: 06/01/2009
Date Made Active in Reports: 07/06/2009
Number of Days to Update: 35

Source: Department of Commerce, Division of State Fire Marshal
Telephone: 614-752-7938
Last EDR Contact: 06/08/2009
Next Scheduled EDR Contact: 09/07/2009
Data Release Frequency: Quarterly

Local Land Records

LIENS 2: CERCLA Lien Information

A Federal CERCLA ('Superfund') lien can exist by operation of law at any site or property at which EPA has spent Superfund monies. These monies are spent to investigate and address releases and threatened releases of contamination. CERCLIS provides information as to the identity of these sites and properties.

Date of Government Version: 05/29/2009
Date Data Arrived at EDR: 06/03/2009
Date Made Active in Reports: 06/17/2009
Number of Days to Update: 14

Source: Environmental Protection Agency
Telephone: 202-564-6023
Last EDR Contact: 05/18/2009
Next Scheduled EDR Contact: 08/17/2009
Data Release Frequency: Varies

LUCIS: Land Use Control Information System

LUCIS contains records of land use control information pertaining to the former Navy Base Realignment and Closure properties.

Date of Government Version: 12/09/2005
Date Data Arrived at EDR: 12/11/2006
Date Made Active in Reports: 01/11/2007
Number of Days to Update: 31

Source: Department of the Navy
Telephone: 843-820-7326
Last EDR Contact: 06/08/2009
Next Scheduled EDR Contact: 09/07/2009
Data Release Frequency: Varies

Records of Emergency Release Reports

HMIRS: Hazardous Materials Information Reporting System

Hazardous Materials Incident Report System. HMIRS contains hazardous material spill incidents reported to DOT.

Date of Government Version: 03/31/2009
Date Data Arrived at EDR: 04/16/2009
Date Made Active in Reports: 05/29/2009
Number of Days to Update: 43

Source: U.S. Department of Transportation
Telephone: 202-366-4555
Last EDR Contact: 07/16/2009
Next Scheduled EDR Contact: 10/12/2009
Data Release Frequency: Annually

SPILLS: Emergency Response Database

Incidents reported to the Emergency Response Unit. The focus of the ER program is to minimize the impact on the environment from accidental releases, spills, and unauthorized discharges from any fixed or mobile sources. Incidents involving petroleum products, hazardous materials, hazardous waste, abandoned drums, or other materials which may pose as a pollution threat to the state's water, land, or air should be reported immediately. Not all incidents included in the database are actual SPILLS, they can simply be reported incidents.

Date of Government Version: 06/01/2009
Date Data Arrived at EDR: 06/01/2009
Date Made Active in Reports: 07/06/2009
Number of Days to Update: 35

Source: Ohio EPA
Telephone: 614-644-2084
Last EDR Contact: 06/01/2009
Next Scheduled EDR Contact: 08/31/2009
Data Release Frequency: Varies

Other Ascertainable Records

RCRA-NonGen: RCRA - Non Generators

RCRAInfo is EPA's comprehensive information system, providing access to data supporting the Resource Conservation and Recovery Act (RCRA) of 1976 and the Hazardous and Solid Waste Amendments (HSWA) of 1984. The database includes selective information on sites which generate, transport, store, treat and/or dispose of hazardous waste as defined by the Resource Conservation and Recovery Act (RCRA). Non-Generators do not presently generate hazardous waste.

GOVERNMENT RECORDS SEARCHED / DATA CURRENCY TRACKING

Date of Government Version: 11/12/2008
Date Data Arrived at EDR: 11/18/2008
Date Made Active in Reports: 03/16/2009
Number of Days to Update: 118

Source: Environmental Protection Agency
Telephone: 312-886-6186
Last EDR Contact: 07/23/2009
Next Scheduled EDR Contact: 10/19/2009
Data Release Frequency: Varies

DOT OPS: Incident and Accident Data

Department of Transportation, Office of Pipeline Safety Incident and Accident data.

Date of Government Version: 05/14/2008
Date Data Arrived at EDR: 05/28/2008
Date Made Active in Reports: 08/08/2008
Number of Days to Update: 72

Source: Department of Transportation, Office of Pipeline Safety
Telephone: 202-366-4595
Last EDR Contact: 05/27/2009
Next Scheduled EDR Contact: 08/24/2009
Data Release Frequency: Varies

DOD: Department of Defense Sites

This data set consists of federally owned or administered lands, administered by the Department of Defense, that have any area equal to or greater than 640 acres of the United States, Puerto Rico, and the U.S. Virgin Islands.

Date of Government Version: 12/31/2005
Date Data Arrived at EDR: 11/10/2006
Date Made Active in Reports: 01/11/2007
Number of Days to Update: 62

Source: USGS
Telephone: 703-692-8801
Last EDR Contact: 05/08/2009
Next Scheduled EDR Contact: 08/03/2009
Data Release Frequency: Semi-Annually

FUDS: Formerly Used Defense Sites

The listing includes locations of Formerly Used Defense Sites properties where the US Army Corps of Engineers is actively working or will take necessary cleanup actions.

Date of Government Version: 12/31/2007
Date Data Arrived at EDR: 09/05/2008
Date Made Active in Reports: 09/23/2008
Number of Days to Update: 18

Source: U.S. Army Corps of Engineers
Telephone: 202-528-4285
Last EDR Contact: 07/01/2009
Next Scheduled EDR Contact: 09/28/2009
Data Release Frequency: Varies

CONSENT: Superfund (CERCLA) Consent Decrees

Major legal settlements that establish responsibility and standards for cleanup at NPL (Superfund) sites. Released periodically by United States District Courts after settlement by parties to litigation matters.

Date of Government Version: 01/27/2009
Date Data Arrived at EDR: 04/23/2009
Date Made Active in Reports: 05/11/2009
Number of Days to Update: 18

Source: Department of Justice, Consent Decree Library
Telephone: Varies
Last EDR Contact: 07/20/2009
Next Scheduled EDR Contact: 10/19/2009
Data Release Frequency: Varies

ROD: Records Of Decision

Record of Decision. ROD documents mandate a permanent remedy at an NPL (Superfund) site containing technical and health information to aid in the cleanup.

Date of Government Version: 04/23/2009
Date Data Arrived at EDR: 04/28/2009
Date Made Active in Reports: 05/19/2009
Number of Days to Update: 21

Source: EPA
Telephone: 703-416-0223
Last EDR Contact: 07/31/2009
Next Scheduled EDR Contact: 09/28/2009
Data Release Frequency: Annually

UMTRA: Uranium Mill Tailings Sites

Uranium ore was mined by private companies for federal government use in national defense programs. When the mills shut down, large piles of the sand-like material (mill tailings) remain after uranium has been extracted from the ore. Levels of human exposure to radioactive materials from the piles are low; however, in some cases tailings were used as construction materials before the potential health hazards of the tailings were recognized.

GOVERNMENT RECORDS SEARCHED / DATA CURRENCY TRACKING

Date of Government Version: 01/05/2009
Date Data Arrived at EDR: 05/07/2009
Date Made Active in Reports: 05/08/2009
Number of Days to Update: 1

Source: Department of Energy
Telephone: 505-845-0011
Last EDR Contact: 06/15/2009
Next Scheduled EDR Contact: 09/14/2009
Data Release Frequency: Varies

MINES: Mines Master Index File

Contains all mine identification numbers issued for mines active or opened since 1971. The data also includes violation information.

Date of Government Version: 02/19/2009
Date Data Arrived at EDR: 03/24/2009
Date Made Active in Reports: 05/05/2009
Number of Days to Update: 42

Source: Department of Labor, Mine Safety and Health Administration
Telephone: 303-231-5959
Last EDR Contact: 06/23/2009
Next Scheduled EDR Contact: 09/21/2009
Data Release Frequency: Semi-Annually

TRIS: Toxic Chemical Release Inventory System

Toxic Release Inventory System. TRIS identifies facilities which release toxic chemicals to the air, water and land in reportable quantities under SARA Title III Section 313.

Date of Government Version: 12/31/2007
Date Data Arrived at EDR: 04/09/2009
Date Made Active in Reports: 06/17/2009
Number of Days to Update: 69

Source: EPA
Telephone: 202-566-0250
Last EDR Contact: 06/16/2009
Next Scheduled EDR Contact: 09/14/2009
Data Release Frequency: Annually

TSCA: Toxic Substances Control Act

Toxic Substances Control Act. TSCA identifies manufacturers and importers of chemical substances included on the TSCA Chemical Substance Inventory list. It includes data on the production volume of these substances by plant site.

Date of Government Version: 12/31/2002
Date Data Arrived at EDR: 04/14/2006
Date Made Active in Reports: 05/30/2006
Number of Days to Update: 46

Source: EPA
Telephone: 202-260-5521
Last EDR Contact: 07/14/2009
Next Scheduled EDR Contact: 10/12/2009
Data Release Frequency: Every 4 Years

FTTS: FIFRA/ TSCA Tracking System - FIFRA (Federal Insecticide, Fungicide, & Rodenticide Act)/TSCA (Toxic Substances Control Act)

FTTS tracks administrative cases and pesticide enforcement actions and compliance activities related to FIFRA, TSCA and EPCRA (Emergency Planning and Community Right-to-Know Act). To maintain currency, EDR contacts the Agency on a quarterly basis.

Date of Government Version: 04/09/2009
Date Data Arrived at EDR: 04/16/2009
Date Made Active in Reports: 05/11/2009
Number of Days to Update: 25

Source: EPA/Office of Prevention, Pesticides and Toxic Substances
Telephone: 202-566-1667
Last EDR Contact: 06/15/2009
Next Scheduled EDR Contact: 09/14/2009
Data Release Frequency: Quarterly

FTTS INSP: FIFRA/ TSCA Tracking System - FIFRA (Federal Insecticide, Fungicide, & Rodenticide Act)/TSCA (Toxic Substances Control Act)

A listing of FIFRA/TSCA Tracking System (FTTS) inspections and enforcements.

Date of Government Version: 04/09/2009
Date Data Arrived at EDR: 04/16/2009
Date Made Active in Reports: 05/11/2009
Number of Days to Update: 25

Source: EPA
Telephone: 202-566-1667
Last EDR Contact: 06/15/2009
Next Scheduled EDR Contact: 09/14/2009
Data Release Frequency: Quarterly

HIST FTTS: FIFRA/TSCA Tracking System Administrative Case Listing

A complete administrative case listing from the FIFRA/TSCA Tracking System (FTTS) for all ten EPA regions. The information was obtained from the National Compliance Database (NCDB). NCDB supports the implementation of FIFRA (Federal Insecticide, Fungicide, and Rodenticide Act) and TSCA (Toxic Substances Control Act). Some EPA regions are now closing out records. Because of that, and the fact that some EPA regions are not providing EPA Headquarters with updated records, it was decided to create a HIST FTTS database. It included records that may not be included in the newer FTTS database updates. This database is no longer updated.

GOVERNMENT RECORDS SEARCHED / DATA CURRENCY TRACKING

Date of Government Version: 10/19/2006
Date Data Arrived at EDR: 03/01/2007
Date Made Active in Reports: 04/10/2007
Number of Days to Update: 40

Source: Environmental Protection Agency
Telephone: 202-564-2501
Last EDR Contact: 12/17/2007
Next Scheduled EDR Contact: 03/17/2008
Data Release Frequency: No Update Planned

HIST FTTS INSP: FIFRA/TSCA Tracking System Inspection & Enforcement Case Listing

A complete inspection and enforcement case listing from the FIFRA/TSCA Tracking System (FTTS) for all ten EPA regions. The information was obtained from the National Compliance Database (NCDB). NCDB supports the implementation of FIFRA (Federal Insecticide, Fungicide, and Rodenticide Act) and TSCA (Toxic Substances Control Act). Some EPA regions are now closing out records. Because of that, and the fact that some EPA regions are not providing EPA Headquarters with updated records, it was decided to create a HIST FTTS database. It included records that may not be included in the newer FTTS database updates. This database is no longer updated.

Date of Government Version: 10/19/2006
Date Data Arrived at EDR: 03/01/2007
Date Made Active in Reports: 04/10/2007
Number of Days to Update: 40

Source: Environmental Protection Agency
Telephone: 202-564-2501
Last EDR Contact: 12/17/2008
Next Scheduled EDR Contact: 03/17/2008
Data Release Frequency: No Update Planned

SSTS: Section 7 Tracking Systems

Section 7 of the Federal Insecticide, Fungicide and Rodenticide Act, as amended (92 Stat. 829) requires all registered pesticide-producing establishments to submit a report to the Environmental Protection Agency by March 1st each year. Each establishment must report the types and amounts of pesticides, active ingredients and devices being produced, and those having been produced and sold or distributed in the past year.

Date of Government Version: 12/31/2006
Date Data Arrived at EDR: 03/14/2008
Date Made Active in Reports: 04/18/2008
Number of Days to Update: 35

Source: EPA
Telephone: 202-564-4203
Last EDR Contact: 07/14/2009
Next Scheduled EDR Contact: 10/12/2009
Data Release Frequency: Annually

ICIS: Integrated Compliance Information System

The Integrated Compliance Information System (ICIS) supports the information needs of the national enforcement and compliance program as well as the unique needs of the National Pollutant Discharge Elimination System (NPDES) program.

Date of Government Version: 03/20/2009
Date Data Arrived at EDR: 03/20/2009
Date Made Active in Reports: 05/05/2009
Number of Days to Update: 46

Source: Environmental Protection Agency
Telephone: 202-564-5088
Last EDR Contact: 07/13/2009
Next Scheduled EDR Contact: 10/12/2009
Data Release Frequency: Quarterly

PADS: PCB Activity Database System

PCB Activity Database. PADS Identifies generators, transporters, commercial storers and/or brokers and disposers of PCB's who are required to notify the EPA of such activities.

Date of Government Version: 02/26/2009
Date Data Arrived at EDR: 05/20/2009
Date Made Active in Reports: 05/29/2009
Number of Days to Update: 9

Source: EPA
Telephone: 202-566-0500
Last EDR Contact: 08/05/2009
Next Scheduled EDR Contact: 11/02/2009
Data Release Frequency: Annually

MLTS: Material Licensing Tracking System

MLTS is maintained by the Nuclear Regulatory Commission and contains a list of approximately 8,100 sites which possess or use radioactive materials and which are subject to NRC licensing requirements. To maintain currency, EDR contacts the Agency on a quarterly basis.

Date of Government Version: 04/02/2009
Date Data Arrived at EDR: 04/24/2009
Date Made Active in Reports: 05/19/2009
Number of Days to Update: 25

Source: Nuclear Regulatory Commission
Telephone: 301-415-7169
Last EDR Contact: 06/29/2009
Next Scheduled EDR Contact: 09/28/2009
Data Release Frequency: Quarterly

GOVERNMENT RECORDS SEARCHED / DATA CURRENCY TRACKING

RADINFO: Radiation Information Database

The Radiation Information Database (RADINFO) contains information about facilities that are regulated by U.S. Environmental Protection Agency (EPA) regulations for radiation and radioactivity.

Date of Government Version: 04/28/2009	Source: Environmental Protection Agency
Date Data Arrived at EDR: 04/29/2009	Telephone: 202-343-9775
Date Made Active in Reports: 05/11/2009	Last EDR Contact: 07/28/2009
Number of Days to Update: 12	Next Scheduled EDR Contact: 10/26/2009
	Data Release Frequency: Quarterly

FINDS: Facility Index System/Facility Registry System

Facility Index System. FINDS contains both facility information and 'pointers' to other sources that contain more detail. EDR includes the following FINDS databases in this report: PCS (Permit Compliance System), AIRS (Aerometric Information Retrieval System), DOCKET (Enforcement Docket used to manage and track information on civil judicial enforcement cases for all environmental statutes), FURS (Federal Underground Injection Control), C-DOCKET (Criminal Docket System used to track criminal enforcement actions for all environmental statutes), FFIS (Federal Facilities Information System), STATE (State Environmental Laws and Statutes), and PADS (PCB Activity Data System).

Date of Government Version: 04/28/2009	Source: EPA
Date Data Arrived at EDR: 05/01/2009	Telephone: (312) 353-2000
Date Made Active in Reports: 05/19/2009	Last EDR Contact: 06/29/2009
Number of Days to Update: 18	Next Scheduled EDR Contact: 09/28/2009
	Data Release Frequency: Quarterly

RAATS: RCRA Administrative Action Tracking System

RCRA Administration Action Tracking System. RAATS contains records based on enforcement actions issued under RCRA pertaining to major violators and includes administrative and civil actions brought by the EPA. For administration actions after September 30, 1995, data entry in the RAATS database was discontinued. EPA will retain a copy of the database for historical records. It was necessary to terminate RAATS because a decrease in agency resources made it impossible to continue to update the information contained in the database.

Date of Government Version: 04/17/1995	Source: EPA
Date Data Arrived at EDR: 07/03/1995	Telephone: 202-564-4104
Date Made Active in Reports: 08/07/1995	Last EDR Contact: 06/02/2008
Number of Days to Update: 35	Next Scheduled EDR Contact: 09/01/2008
	Data Release Frequency: No Update Planned

BRS: Biennial Reporting System

The Biennial Reporting System is a national system administered by the EPA that collects data on the generation and management of hazardous waste. BRS captures detailed data from two groups: Large Quantity Generators (LQG) and Treatment, Storage, and Disposal Facilities.

Date of Government Version: 12/31/2007	Source: EPA/NTIS
Date Data Arrived at EDR: 02/19/2009	Telephone: 800-424-9346
Date Made Active in Reports: 05/22/2009	Last EDR Contact: 06/08/2009
Number of Days to Update: 92	Next Scheduled EDR Contact: 09/07/2009
	Data Release Frequency: Biennially

TOWNGAS: DERR Towngas Database

The database includes 82 very old sites (circa 1895) which produced gas from coal for street lighting. Most visual evidence of these sites has disappeared, however the potential for buried coal tar remains. The database is no longer in active use.

Date of Government Version: 07/28/1992	Source: Ohio EPA
Date Data Arrived at EDR: 02/21/2003	Telephone: 614-644-3749
Date Made Active in Reports: 03/05/2003	Last EDR Contact: 02/12/2003
Number of Days to Update: 12	Next Scheduled EDR Contact: N/A
	Data Release Frequency: No Update Planned

GOVERNMENT RECORDS SEARCHED / DATA CURRENCY TRACKING

UIC: Underground Injection Wells Listing

A listing of underground injection well locations.

Date of Government Version: 06/02/2009
Date Data Arrived at EDR: 06/03/2009
Date Made Active in Reports: 07/06/2009
Number of Days to Update: 33

Source: Ohio EPA
Telephone: 614-644-2752
Last EDR Contact: 06/01/2009
Next Scheduled EDR Contact: 08/31/2009
Data Release Frequency: Varies

DRYCLEANERS: Drycleaner Facility Listing

A listing of drycleaner facility locations.

Date of Government Version: 04/20/2009
Date Data Arrived at EDR: 04/21/2009
Date Made Active in Reports: 04/24/2009
Number of Days to Update: 3

Source: Ohio EPA
Telephone: 614-644-3469
Last EDR Contact: 07/20/2009
Next Scheduled EDR Contact: 10/19/2009
Data Release Frequency: Varies

NPDES: NPDES General Permit List

General information regarding NPDES (National Pollutant Discharge Elimination System) permits.

Date of Government Version: 12/02/2008
Date Data Arrived at EDR: 12/04/2008
Date Made Active in Reports: 02/09/2009
Number of Days to Update: 67

Source: Ohio EPA
Telephone: 614-644-2031
Last EDR Contact: 06/05/2009
Next Scheduled EDR Contact: 08/31/2009
Data Release Frequency: Semi-Annually

AIRS: Title V Permits Listing

A listing of Title V Permits issued by the Division of Air Pollution Control. It is a federal operating permit program adopted and implemented by the state. The basic program elements typically specify that major sources will submit an operating application to the specified state environmental regulatory agency according to a schedule.

Date of Government Version: 04/10/2009
Date Data Arrived at EDR: 04/15/2009
Date Made Active in Reports: 04/24/2009
Number of Days to Update: 9

Source: Ohio EPA
Telephone: 614-644-2270
Last EDR Contact: 07/14/2009
Next Scheduled EDR Contact: 10/12/2009
Data Release Frequency: Varies

USD: Urban Setting Designation Sites

A USD may be requested for properties participating in the VAP when there is no current or future use of the ground water by local residents for drinking, showering, bathing or cooking. In these areas, an approved USD would lower the cost of cleanup and promote economic redevelopment while still protecting public health and safety. If these USDs were to be approved, the ground water cleanup or response requirements for the areas could be lessened. The Ohio EPA director may approve a USD request based on a demonstration that the USD requirements are met and an evaluation of existing and future uses of ground water in the area. The Ohio EPA director's decision on approval or denial of the request is needed before cleanup requirements for the site can be determined.

Date of Government Version: 06/01/2009
Date Data Arrived at EDR: 06/03/2009
Date Made Active in Reports: 07/06/2009
Number of Days to Update: 33

Source: Ohio EPA
Telephone: 614-644-3749
Last EDR Contact: 06/01/2009
Next Scheduled EDR Contact: 08/31/2009
Data Release Frequency: Varies

HIST USD: Urban Setting Designations Database

A USD may be requested for properties participating in the VAP when there is no current or future use of the ground water by local residents for drinking, showering, bathing or cooking. In these areas, an approved USD would lower the cost of cleanup and promote economic redevelopment while still protecting public health and safety. If these USDs were to be approved, the ground water cleanup or response requirements for the areas could be lessened. The Ohio EPA director may approve a USD request based on a demonstration that the USD requirements are met and an evaluation of existing and future uses of ground water in the area. The Ohio EPA director's decision on approval or denial of the request is needed before cleanup requirements for the site can be determined. This database is no longer updated or maintained by the state agency.

GOVERNMENT RECORDS SEARCHED / DATA CURRENCY TRACKING

Date of Government Version: 05/10/2005
Date Data Arrived at EDR: 04/25/2006
Date Made Active in Reports: 05/11/2006
Number of Days to Update: 16

Source: Ohio EPA
Telephone: 614-644-3749
Last EDR Contact: 06/02/2008
Next Scheduled EDR Contact: 09/01/2008
Data Release Frequency: No Update Planned

INDIAN RESERV: Indian Reservations

This map layer portrays Indian administered lands of the United States that have any area equal to or greater than 640 acres.

Date of Government Version: 12/31/2005
Date Data Arrived at EDR: 12/08/2006
Date Made Active in Reports: 01/11/2007
Number of Days to Update: 34

Source: USGS
Telephone: 202-208-3710
Last EDR Contact: 05/08/2009
Next Scheduled EDR Contact: 08/03/2009
Data Release Frequency: Semi-Annually

SCRD DRYCLEANERS: State Coalition for Remediation of Drycleaners Listing

The State Coalition for Remediation of Drycleaners was established in 1998, with support from the U.S. EPA Office of Superfund Remediation and Technology Innovation. It is comprised of representatives of states with established drycleaner remediation programs. Currently the member states are Alabama, Connecticut, Florida, Illinois, Kansas, Minnesota, Missouri, North Carolina, Oregon, South Carolina, Tennessee, Texas, and Wisconsin.

Date of Government Version: 04/13/2009
Date Data Arrived at EDR: 04/14/2009
Date Made Active in Reports: 06/17/2009
Number of Days to Update: 64

Source: Environmental Protection Agency
Telephone: 615-532-8599
Last EDR Contact: 06/22/2009
Next Scheduled EDR Contact: 08/10/2009
Data Release Frequency: Varies

FEDLAND: Federal and Indian Lands

Federally and Indian administered lands of the United States. Lands included are administered by: Army Corps of Engineers, Bureau of Reclamation, National Wild and Scenic River, National Wildlife Refuge, Public Domain Land, Wilderness, Wilderness Study Area, Wildlife Management Area, Bureau of Indian Affairs, Bureau of Land Management, Department of Justice, Forest Service, Fish and Wildlife Service, National Park Service.

Date of Government Version: 12/31/2005
Date Data Arrived at EDR: 02/06/2006
Date Made Active in Reports: 01/11/2007
Number of Days to Update: 339

Source: U.S. Geological Survey
Telephone: 888-275-8747
Last EDR Contact: 05/08/2009
Next Scheduled EDR Contact: 08/03/2009
Data Release Frequency: N/A

EDR PROPRIETARY RECORDS

EDR Proprietary Records

Manufactured Gas Plants: EDR Proprietary Manufactured Gas Plants

The EDR Proprietary Manufactured Gas Plant Database includes records of coal gas plants (manufactured gas plants) compiled by EDR's researchers. Manufactured gas sites were used in the United States from the 1800's to 1950's to produce a gas that could be distributed and used as fuel. These plants used whale oil, rosin, coal, or a mixture of coal, oil, and water that also produced a significant amount of waste. Many of the byproducts of the gas production, such as coal tar (oily waste containing volatile and non-volatile chemicals), sludges, oils and other compounds are potentially hazardous to human health and the environment. The byproduct from this process was frequently disposed of directly at the plant site and can remain or spread slowly, serving as a continuous source of soil and groundwater contamination.

Date of Government Version: N/A
Date Data Arrived at EDR: N/A
Date Made Active in Reports: N/A
Number of Days to Update: N/A

Source: EDR, Inc.
Telephone: N/A
Last EDR Contact: N/A
Next Scheduled EDR Contact: N/A
Data Release Frequency: No Update Planned

GOVERNMENT RECORDS SEARCHED / DATA CURRENCY TRACKING

OTHER DATABASE(S)

Depending on the geographic area covered by this report, the data provided in these specialty databases may or may not be complete. For example, the existence of wetlands information data in a specific report does not mean that all wetlands in the area covered by the report are included. Moreover, the absence of any reported wetlands information does not necessarily mean that wetlands do not exist in the area covered by the report.

CT MANIFEST: Hazardous Waste Manifest Data

Facility and manifest data. Manifest is a document that lists and tracks hazardous waste from the generator through transporters to a tsd facility.

Date of Government Version: 12/31/2006
Date Data Arrived at EDR: 12/11/2008
Date Made Active in Reports: 03/19/2009
Number of Days to Update: 98

Source: Department of Environmental Protection
Telephone: 860-424-3375
Last EDR Contact: 07/21/2009
Next Scheduled EDR Contact: 09/07/2009
Data Release Frequency: Annually

NJ MANIFEST: Manifest Information

Hazardous waste manifest information.

Date of Government Version: 12/31/2008
Date Data Arrived at EDR: 05/05/2009
Date Made Active in Reports: 05/22/2009
Number of Days to Update: 17

Source: Department of Environmental Protection
Telephone: N/A
Last EDR Contact: 08/04/2009
Next Scheduled EDR Contact: 11/02/2009
Data Release Frequency: Annually

NY MANIFEST: Facility and Manifest Data

Manifest is a document that lists and tracks hazardous waste from the generator through transporters to a TSD facility.

Date of Government Version: 05/22/2009
Date Data Arrived at EDR: 05/27/2009
Date Made Active in Reports: 07/01/2009
Number of Days to Update: 35

Source: Department of Environmental Conservation
Telephone: 518-402-8651
Last EDR Contact: 05/27/2009
Next Scheduled EDR Contact: 08/24/2009
Data Release Frequency: Annually

PA MANIFEST: Manifest Information

Hazardous waste manifest information.

Date of Government Version: 12/31/2007
Date Data Arrived at EDR: 09/11/2008
Date Made Active in Reports: 10/02/2008
Number of Days to Update: 21

Source: Department of Environmental Protection
Telephone: N/A
Last EDR Contact: 06/08/2009
Next Scheduled EDR Contact: 09/07/2009
Data Release Frequency: Annually

RI MANIFEST: Manifest information

Hazardous waste manifest information

Date of Government Version: 06/01/2009
Date Data Arrived at EDR: 06/12/2009
Date Made Active in Reports: 06/29/2009
Number of Days to Update: 17

Source: Department of Environmental Management
Telephone: 401-222-2797
Last EDR Contact: 06/15/2009
Next Scheduled EDR Contact: 09/14/2009
Data Release Frequency: Annually

VT MANIFEST: Hazardous Waste Manifest Data

Hazardous waste manifest information.

Date of Government Version: 03/31/2009
Date Data Arrived at EDR: 04/09/2009
Date Made Active in Reports: 05/20/2009
Number of Days to Update: 41

Source: Department of Environmental Conservation
Telephone: 802-241-3443
Last EDR Contact: 05/11/2009
Next Scheduled EDR Contact: 08/10/2009
Data Release Frequency: Annually

GOVERNMENT RECORDS SEARCHED / DATA CURRENCY TRACKING

WI MANIFEST: Manifest Information

Hazardous waste manifest information.

Date of Government Version: 12/31/2007

Date Data Arrived at EDR: 08/22/2008

Date Made Active in Reports: 09/08/2008

Number of Days to Update: 17

Source: Department of Natural Resources

Telephone: N/A

Last EDR Contact: 07/06/2009

Next Scheduled EDR Contact: 10/05/2009

Data Release Frequency: Annually

Oil/Gas Pipelines: This data was obtained by EDR from the USGS in 1994. It is referred to by USGS as GeoData Digital Line Graphs from 1:100,000-Scale Maps. It was extracted from the transportation category including some oil, but primarily gas pipelines.

Electric Power Transmission Line Data

Source: PennWell Corporation

Telephone: (800) 823-6277

This map includes information copyrighted by PennWell Corporation. This information is provided on a best effort basis and PennWell Corporation does not guarantee its accuracy nor warrant its fitness for any particular purpose. Such information has been reprinted with the permission of PennWell.

Sensitive Receptors: There are individuals deemed sensitive receptors due to their fragile immune systems and special sensitivity to environmental discharges. These sensitive receptors typically include the elderly, the sick, and children. While the location of all sensitive receptors cannot be determined, EDR indicates those buildings and facilities - schools, daycares, hospitals, medical centers, and nursing homes - where individuals who are sensitive receptors are likely to be located.

AHA Hospitals:

Source: American Hospital Association, Inc.

Telephone: 312-280-5991

The database includes a listing of hospitals based on the American Hospital Association's annual survey of hospitals.

Medical Centers: Provider of Services Listing

Source: Centers for Medicare & Medicaid Services

Telephone: 410-786-3000

A listing of hospitals with Medicare provider number, produced by Centers of Medicare & Medicaid Services, a federal agency within the U.S. Department of Health and Human Services.

Nursing Homes

Source: National Institutes of Health

Telephone: 301-594-6248

Information on Medicare and Medicaid certified nursing homes in the United States.

Public Schools

Source: National Center for Education Statistics

Telephone: 202-502-7300

The National Center for Education Statistics' primary database on elementary and secondary public education in the United States. It is a comprehensive, annual, national statistical database of all public elementary and secondary schools and school districts, which contains data that are comparable across all states.

Private Schools

Source: National Center for Education Statistics

Telephone: 202-502-7300

The National Center for Education Statistics' primary database on private school locations in the United States.

Daycare Centers: Licensed Child Day Care Facilities

Source: Department of Job & Family Services

Telephone: 614-466-6282

Flood Zone Data: This data, available in select counties across the country, was obtained by EDR in 1999 from the Federal Emergency Management Agency (FEMA). Data depicts 100-year and 500-year flood zones as defined by FEMA.

NWI: National Wetlands Inventory. This data, available in select counties across the country, was obtained by EDR in 2002 and 2005 from the U.S. Fish and Wildlife Service.

State Wetlands Data: Wetlands Inventory

Source: Department of Natural Resources

Telephone: 614-265-1044

Scanned Digital USGS 7.5' Topographic Map (DRG)

Source: United States Geologic Survey

A digital raster graphic (DRG) is a scanned image of a U.S. Geological Survey topographic map. The map images are made by scanning published paper maps on high-resolution scanners. The raster image is georeferenced and fit to the Universal Transverse Mercator (UTM) projection.

STREET AND ADDRESS INFORMATION

© 2009 Tele Atlas North America, Inc. All rights reserved. This material is proprietary and the subject of copyright protection and other intellectual property rights owned by or licensed to Tele Atlas North America, Inc. The use of this material is subject to the terms of a license agreement. You will be held liable for any unauthorized copying or disclosure of this material.

GEOCHECK[®] - PHYSICAL SETTING SOURCE ADDENDUM

TARGET PROPERTY ADDRESS

LORDSTOWN EXCESS LAND -SITE ID 1011
1829 HALLOCK YOUNG ROAD
LORDSTOWN, OH 44481

TARGET PROPERTY COORDINATES

Latitude (North):	41.14250 - 41° 8' 33.0"
Longitude (West):	80.8606 - 80° 51' 38.2"
Universal Transverse Mercator:	Zone 17
UTM X (Meters):	511698.8
UTM Y (Meters):	4554373.5
Elevation:	972 ft. above sea level

USGS TOPOGRAPHIC MAP

Target Property Map:	41080-B7 WARREN, OH
Most Recent Revision:	1997
West Map:	41080-B8 NEWTON FALLS, OH
Most Recent Revision:	1994

EDR's GeoCheck Physical Setting Source Addendum is provided to assist the environmental professional in forming an opinion about the impact of potential contaminant migration.

Assessment of the impact of contaminant migration generally has two principle investigative components:

1. Groundwater flow direction, and
2. Groundwater flow velocity.

Groundwater flow direction may be impacted by surface topography, hydrology, hydrogeology, characteristics of the soil, and nearby wells. Groundwater flow velocity is generally impacted by the nature of the geologic strata.

GEOCHECK® - PHYSICAL SETTING SOURCE SUMMARY

GROUNDWATER FLOW DIRECTION INFORMATION

Groundwater flow direction for a particular site is best determined by a qualified environmental professional using site-specific well data. If such data is not reasonably ascertainable, it may be necessary to rely on other sources of information, such as surface topographic information, hydrologic information, hydrogeologic data collected on nearby properties, and regional groundwater flow information (from deep aquifers).

TOPOGRAPHIC INFORMATION

Surface topography may be indicative of the direction of surficial groundwater flow. This information can be used to assist the environmental professional in forming an opinion about the impact of nearby contaminated properties or, should contamination exist on the target property, what downgradient sites might be impacted.

TARGET PROPERTY TOPOGRAPHY

General Topographic Gradient: General SSE

SURROUNDING TOPOGRAPHY: ELEVATION PROFILES

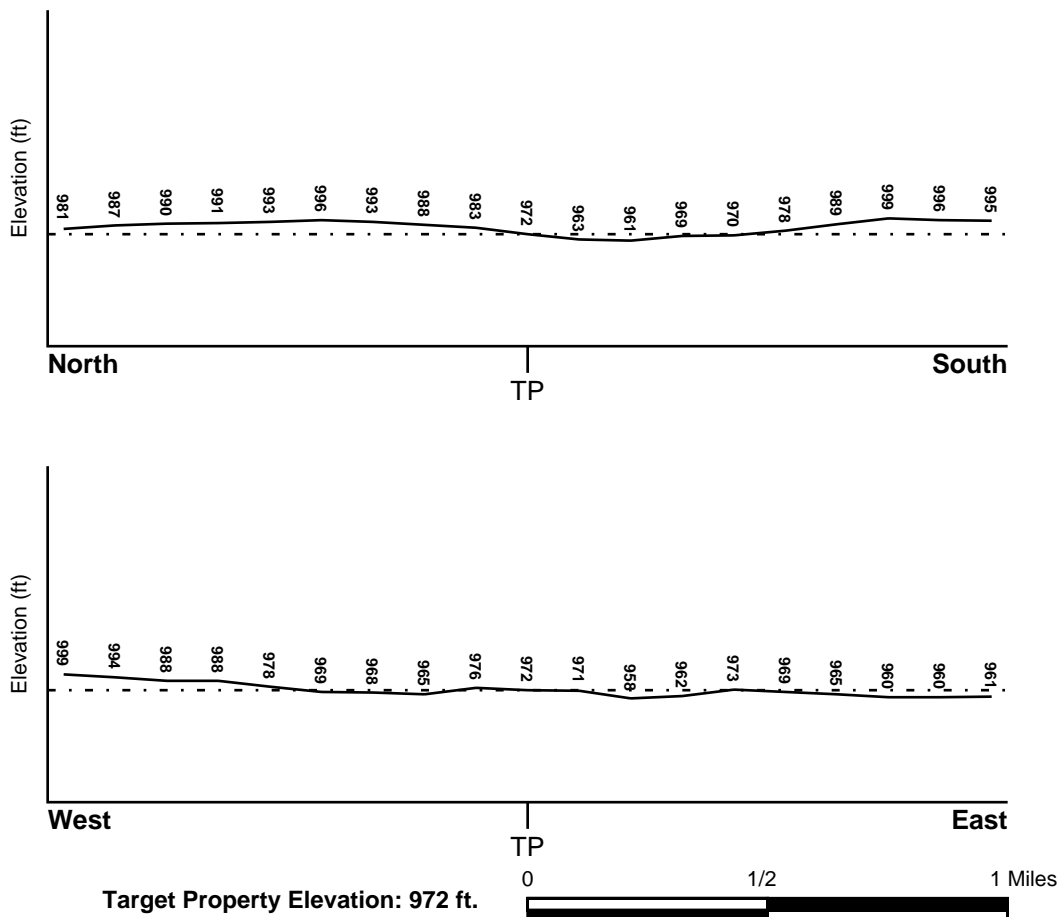

Source: Topography has been determined from the USGS 7.5' Digital Elevation Model and should be evaluated on a relative (not an absolute) basis. Relative elevation information between sites of close proximity should be field verified.

GEOCHECK® - PHYSICAL SETTING SOURCE SUMMARY

HYDROLOGIC INFORMATION

Surface water can act as a hydrologic barrier to groundwater flow. Such hydrologic information can be used to assist the environmental professional in forming an opinion about the impact of nearby contaminated properties or, should contamination exist on the target property, what downgradient sites might be impacted.

Refer to the Physical Setting Source Map following this summary for hydrologic information (major waterways and bodies of water).

FEMA FLOOD ZONE

<u>Target Property County</u>	<u>FEMA Flood</u>
TRUMBULL, OH	<u>Electronic Data</u>
	YES - refer to the Overview Map and Detail Map

Flood Plain Panel at Target Property: 3908120010B

Additional Panels in search area: Not Reported

NATIONAL WETLAND INVENTORY

<u>NWI Quad at Target Property</u>	<u>NWI Electronic</u>
WARREN	<u>Data Coverage</u>
	Not Available

HYDROGEOLOGIC INFORMATION

Hydrogeologic information obtained by installation of wells on a specific site can often be an indicator of groundwater flow direction in the immediate area. Such hydrogeologic information can be used to assist the environmental professional in forming an opinion about the impact of nearby contaminated properties or, should contamination exist on the target property, what downgradient sites might be impacted.

AQUIFLOW®

Search Radius: 1.000 Mile.

EDR has developed the AQUIFLOW Information System to provide data on the general direction of groundwater flow at specific points. EDR has reviewed reports submitted by environmental professionals to regulatory authorities at select sites and has extracted the date of the report, groundwater flow direction as determined hydrogeologically, and the depth to water table.

<u>MAP ID</u>	<u>LOCATION</u>	<u>GENERAL DIRECTION</u>
Not Reported	<u>FROM TP</u>	<u>GROUNDWATER FLOW</u>

GEOCHECK® - PHYSICAL SETTING SOURCE SUMMARY

GROUNDWATER FLOW VELOCITY INFORMATION

Groundwater flow velocity information for a particular site is best determined by a qualified environmental professional using site specific geologic and soil strata data. If such data are not reasonably ascertainable, it may be necessary to rely on other sources of information, including geologic age identification, rock stratigraphic unit and soil characteristics data collected on nearby properties and regional soil information. In general, contaminant plumes move more quickly through sandy-gravelly types of soils than silty-clayey types of soils.

GEOLOGIC INFORMATION IN GENERAL AREA OF TARGET PROPERTY

Geologic information can be used by the environmental professional in forming an opinion about the relative speed at which contaminant migration may be occurring.

ROCK STRATIGRAPHIC UNIT

Era:	Paleozoic
System:	Pennsylvanian
Series:	Atokan and Morrowan Series
Code:	PP1 (<i>decoded above as Era, System & Series</i>)

GEOLOGIC AGE IDENTIFICATION

Category: Stratified Sequence

Geologic Age and Rock Stratigraphic Unit Source: P.G. Schruben, R.E. Arndt and W.J. Bawiec, Geology of the Conterminous U.S. at 1:2,500,000 Scale - a digital representation of the 1974 P.B. King and H.M. Beikman Map, USGS Digital Data Series DDS - 11 (1994).

SSURGO SOIL MAP - 02559388.20r

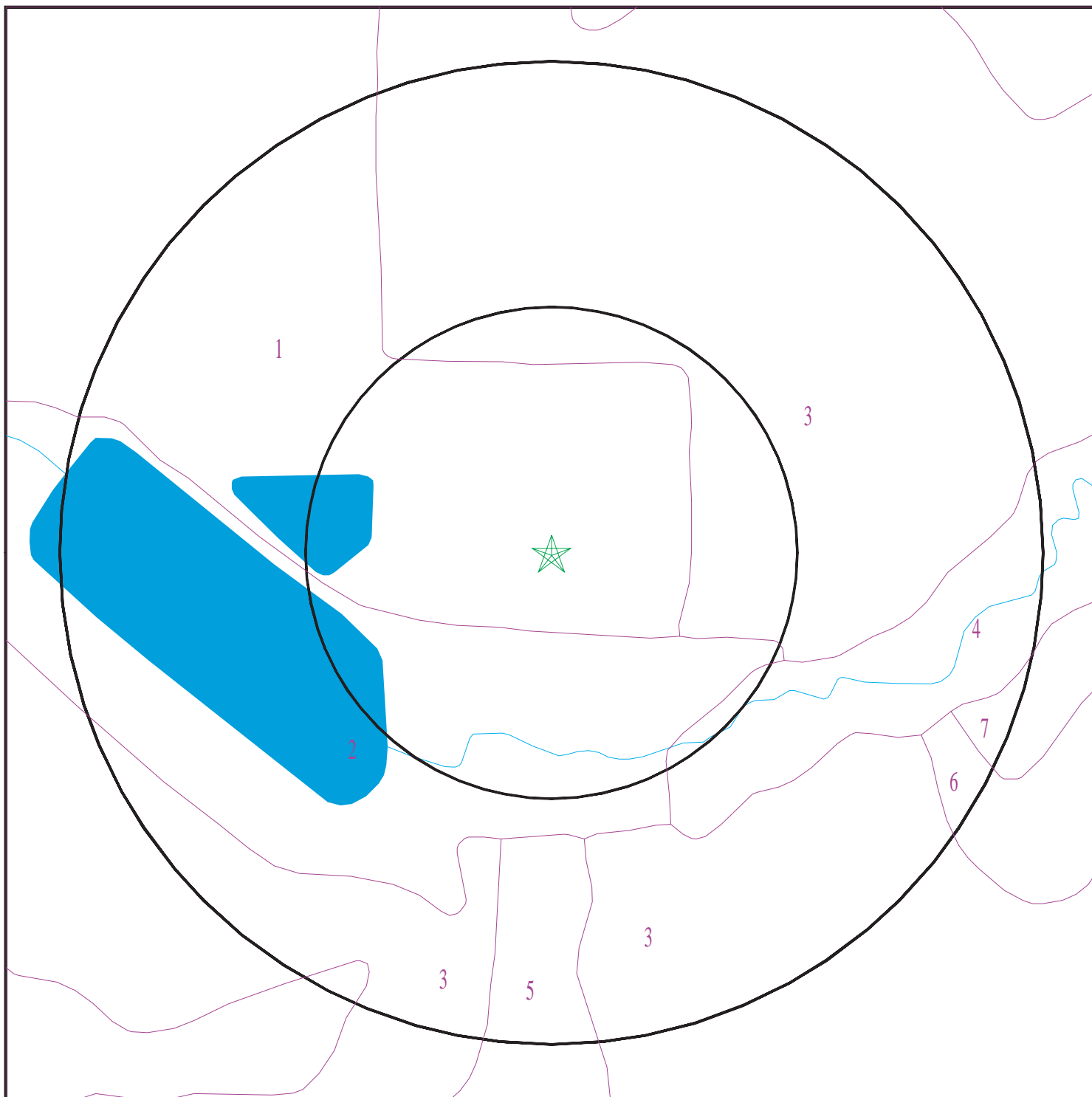

- ★ Target Property
- SSURGO Soil
- Water

0 1/16 1/8 1/4 Miles



SITE NAME: Lordstown Excess Land -Site ID 1011
ADDRESS: 1829 Hallock Young Road
Lordstown OH 44481
LAT/LONG: 41.1425 / 80.8606

CLIENT: LFR Inc
CONTACT: Rich Mall
INQUIRY #: 02559388.20r
DATE: August 07, 2009 10:36 am

GEOCHECK® - PHYSICAL SETTING SOURCE SUMMARY

DOMINANT SOIL COMPOSITION IN GENERAL AREA OF TARGET PROPERTY

The U.S. Department of Agriculture's (USDA) Soil Conservation Service (SCS) leads the National Cooperative Soil Survey (NCSS) and is responsible for collecting, storing, maintaining and distributing soil survey information for privately owned lands in the United States. A soil map in a soil survey is a representation of soil patterns in a landscape. The following information is based on Soil Conservation Service SSURGO data.

Soil Map ID: 1

Soil Component Name: Urban land

Soil Surface Texture:
Hydrologic Group: Not reported

Soil Drainage Class:
Hydric Status: Not hydric

Corrosion Potential - Uncoated Steel: Not Reported

Depth to Bedrock Min: > 0 inches

Depth to Watertable Min: > 0 inches

No Layer Information available.

Soil Map ID: 2

Soil Component Name: Udorthents

Soil Surface Texture:
Hydrologic Group: Class B - Moderate infiltration rates. Deep and moderately deep, moderately well and well drained soils with moderately coarse textures.

Soil Drainage Class: Well drained

Hydric Status: Not hydric

Corrosion Potential - Uncoated Steel: Not Reported

Depth to Bedrock Min: > 0 inches

Depth to Watertable Min: > 0 inches

GEOCHECK® - PHYSICAL SETTING SOURCE SUMMARY

Soil Layer Information							
	Boundary			Classification		Saturated hydraulic conductivity micro m/sec	Soil Reaction (pH)
Layer	Upper	Lower	Soil Texture Class	AASHTO Group	Unified Soil		
1	0 inches	0 inches		Not reported	Not reported	Max: Min:	Max: Min:
2	0 inches	0 inches		Not reported	Not reported	Max: Min:	Max: Min:

Soil Map ID: 3

Soil Component Name: Wadsworth

Soil Surface Texture: silt loam

Hydrologic Group: Class C - Slow infiltration rates. Soils with layers impeding downward movement of water, or soils with moderately fine or fine textures.

Soil Drainage Class: Somewhat poorly drained

Hydric Status: Partially hydric

Corrosion Potential - Uncoated Steel: High

Depth to Bedrock Min: > 0 inches

Depth to Watertable Min: > 46 inches

Soil Layer Information							
	Boundary			Classification		Saturated hydraulic conductivity micro m/sec	Soil Reaction (pH)
Layer	Upper	Lower	Soil Texture Class	AASHTO Group	Unified Soil		
1	0 inches	7 inches	silt loam	Not reported	Not reported	Max: 4.23 Min: 0.42	Max: 8.4 Min: 5.6
2	7 inches	25 inches		Not reported	Not reported	Max: 4.23 Min: 0.42	Max: 8.4 Min: 5.6
3	25 inches	48 inches		Not reported	Not reported	Max: 4.23 Min: 0.42	Max: 8.4 Min: 5.6
4	48 inches	79 inches		Not reported	Not reported	Max: 4.23 Min: 0.42	Max: 8.4 Min: 5.6

GEOCHECK® - PHYSICAL SETTING SOURCE SUMMARY

Soil Map ID: 4

Soil Component Name: Holly

Soil Surface Texture: silt loam

Hydrologic Group: Class B/D - Drained/undrained hydrology class of soils that can be drained and are classified.

Soil Drainage Class: Poorly drained

Hydric Status: Partially hydric

Corrosion Potential - Uncoated Steel: High

Depth to Bedrock Min: > 0 inches

Depth to Watertable Min: > 15 inches

Soil Layer Information							
Layer	Boundary		Soil Texture Class	Classification		Saturated hydraulic conductivity micro m/sec	Soil Reaction (pH)
	Upper	Lower		AASHTO Group	Unified Soil		
1	0 inches	7 inches	silt loam	Not reported	Not reported	Max: 42.34 Min: 4.23	Max: 7.8 Min: 5.6
2	7 inches	33 inches		Not reported	Not reported	Max: 42.34 Min: 4.23	Max: 7.8 Min: 5.6
3	33 inches	44 inches		Not reported	Not reported	Max: 42.34 Min: 4.23	Max: 7.8 Min: 5.6
4	44 inches	68 inches		Not reported	Not reported	Max: 42.34 Min: 4.23	Max: 7.8 Min: 5.6

Soil Map ID: 5

Soil Component Name: Sebring

Soil Surface Texture: silt loam

Hydrologic Group: Class B/D - Drained/undrained hydrology class of soils that can be drained and are classified.

Soil Drainage Class: Poorly drained

Hydric Status: Partially hydric

Corrosion Potential - Uncoated Steel: High

Depth to Bedrock Min: > 0 inches

Depth to Watertable Min: > 15 inches

GEOCHECK® - PHYSICAL SETTING SOURCE SUMMARY

Soil Layer Information							
Layer	Boundary		Soil Texture Class	Classification		Saturated hydraulic conductivity micro m/sec	Soil Reaction (pH)
	Upper	Lower		AASHTO Group	Unified Soil		
1	0 inches	5 inches	silt loam	Not reported	Not reported	Max: 14.11 Min: 1.41	Max: 8.4 Min: 6.1
2	5 inches	29 inches		Not reported	Not reported	Max: 14.11 Min: 1.41	Max: 8.4 Min: 6.1
3	29 inches	53 inches		Not reported	Not reported	Max: 14.11 Min: 1.41	Max: 8.4 Min: 6.1
4	53 inches	68 inches		Not reported	Not reported	Max: 14.11 Min: 1.41	Max: 8.4 Min: 6.1

Soil Map ID: 6

Soil Component Name: Rittman

Soil Surface Texture: silt loam

Hydrologic Group: Class C - Slow infiltration rates. Soils with layers impeding downward movement of water, or soils with moderately fine or fine textures.

Soil Drainage Class: Moderately well drained

Hydric Status: Unknown

Corrosion Potential - Uncoated Steel: High

Depth to Bedrock Min: > 0 inches

Depth to Watertable Min: > 69 inches

Soil Layer Information							
Layer	Boundary		Soil Texture Class	Classification		Saturated hydraulic conductivity micro m/sec	Soil Reaction (pH)
	Upper	Lower		AASHTO Group	Unified Soil		
1	0 inches	16 inches	silt loam	Not reported	Not reported	Max: 4.23 Min: 0.42	Max: 7.8 Min: 5.6
2	16 inches	27 inches		Not reported	Not reported	Max: 4.23 Min: 0.42	Max: 7.8 Min: 5.6
3	27 inches	46 inches		Not reported	Not reported	Max: 4.23 Min: 0.42	Max: 7.8 Min: 5.6
4	46 inches	72 inches		Not reported	Not reported	Max: 4.23 Min: 0.42	Max: 7.8 Min: 5.6

GEOCHECK® - PHYSICAL SETTING SOURCE SUMMARY

Soil Map ID: 7

Soil Component Name: Rittman

Soil Surface Texture: silt loam

Hydrologic Group: Class C - Slow infiltration rates. Soils with layers impeding downward movement of water, or soils with moderately fine or fine textures.

Soil Drainage Class: Moderately well drained

Hydric Status: Unknown

Corrosion Potential - Uncoated Steel: High

Depth to Bedrock Min: > 0 inches

Depth to Watertable Min: > 69 inches

Soil Layer Information							
Layer	Boundary		Soil Texture Class	Classification		Saturated hydraulic conductivity micro m/sec	Soil Reaction (pH)
	Upper	Lower		AASHTO Group	Unified Soil		
1	0 inches	16 inches	silt loam	Not reported	Not reported	Max: 4.23 Min: 0.42	Max: 7.8 Min: 5.6
2	16 inches	27 inches		Not reported	Not reported	Max: 4.23 Min: 0.42	Max: 7.8 Min: 5.6
3	27 inches	46 inches		Not reported	Not reported	Max: 4.23 Min: 0.42	Max: 7.8 Min: 5.6
4	46 inches	72 inches		Not reported	Not reported	Max: 4.23 Min: 0.42	Max: 7.8 Min: 5.6

Soil Map ID: 8

Soil Component Name: Mahoning

Soil Surface Texture: silt loam

Hydrologic Group: Class D - Very slow infiltration rates. Soils are clayey, have a high water table, or are shallow to an impervious layer.

Soil Drainage Class: Somewhat poorly drained

Hydric Status: Partially hydric

Corrosion Potential - Uncoated Steel: High

Depth to Bedrock Min: > 0 inches

Depth to Watertable Min: > 31 inches

GEOCHECK® - PHYSICAL SETTING SOURCE SUMMARY

Soil Layer Information							
Layer	Boundary		Soil Texture Class	Classification		Saturated hydraulic conductivity micro m/sec	Soil Reaction (pH)
	Upper	Lower		AASHTO Group	Unified Soil		
1	0 inches	7 inches	silt loam	Not reported	Not reported	Max: 1.41 Min: 0	Max: 8.4 Min: 7.4
2	7 inches	40 inches		Not reported	Not reported	Max: 1.41 Min: 0	Max: 8.4 Min: 7.4
3	40 inches	70 inches		Not reported	Not reported	Max: 1.41 Min: 0	Max: 8.4 Min: 7.4

LOCAL / REGIONAL WATER AGENCY RECORDS

EDR Local/Regional Water Agency records provide water well information to assist the environmental professional in assessing sources that may impact ground water flow direction, and in forming an opinion about the impact of contaminant migration on nearby drinking water wells.

WELL SEARCH DISTANCE INFORMATION

<u>DATABASE</u>	<u>SEARCH DISTANCE (miles)</u>
Federal USGS	1.000
Federal FRDS PWS	Nearest PWS within 1 mile
State Database	1.000

FEDERAL USGS WELL INFORMATION

<u>MAP ID</u>	<u>WELL ID</u>	<u>LOCATION FROM TP</u>
No Wells Found		

FEDERAL FRDS PUBLIC WATER SUPPLY SYSTEM INFORMATION

<u>MAP ID</u>	<u>WELL ID</u>	<u>LOCATION FROM TP</u>
1	OH7830812	1/4 - 1/2 Mile South

Note: PWS System location is not always the same as well location.

STATE DATABASE WELL INFORMATION

<u>MAP ID</u>	<u>WELL ID</u>	<u>LOCATION FROM TP</u>
2	OHD400000213422	1/4 - 1/2 Mile NNE

GEOCHECK® - PHYSICAL SETTING SOURCE SUMMARY

STATE DATABASE WELL INFORMATION

MAP ID	WELL ID	LOCATION FROM TP
3	OHD400000211912	1/2 - 1 Mile SSE
4	OHD400000213758	1/2 - 1 Mile NNE
5	OHD400000212016	1/2 - 1 Mile SW
6	OHD400000213858	1/2 - 1 Mile NNE
7	OHD400000211867	1/2 - 1 Mile SSW
8	OHD400000211752	1/2 - 1 Mile SSE
9	OHD400000211874	1/2 - 1 Mile SW
A10	OHD400000211425	1/2 - 1 Mile South
A11	OHD400000211416	1/2 - 1 Mile South
12	OHD400000214461	1/2 - 1 Mile North
13	OHD400000211334	1/2 - 1 Mile South
14	OHD400000214446	1/2 - 1 Mile NNE
B15	OHD400000211390	1/2 - 1 Mile SSW
B16	OHD400000211407	1/2 - 1 Mile SSW

PHYSICAL SETTING SOURCE MAP - 02559388.20r

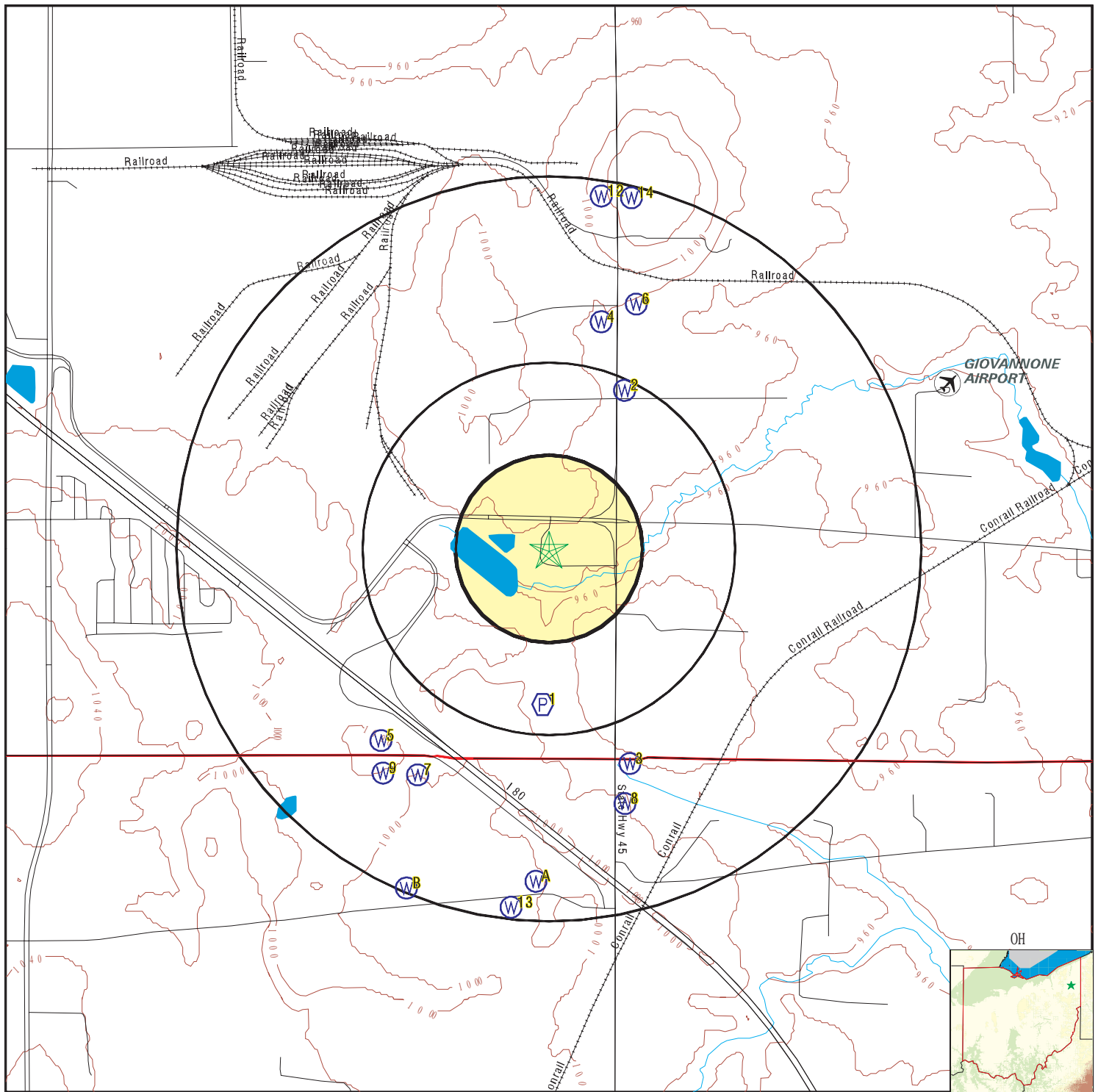

- County Boundary
- Major Roads
- Contour Lines
- Airports
- Earthquake epicenter, Richter 5 or greater
- Water Wells
- Public Water Supply Wells
- Cluster of Multiple Icons

- Groundwater Flow Direction
- Indeterminate Groundwater Flow at Location
- Groundwater Flow Varies at Location

SITE NAME: Lordstown Excess Land -Site ID 1011
 ADDRESS: 1829 Hallock Young Road
 Lordstown OH 44481
 LAT/LONG: 41.1425 / 80.8606

CLIENT: LFR Inc
 CONTACT: Rich Mall
 INQUIRY #: 02559388.20r
 DATE: August 07, 2009 10:36 am

GEOCHECK® - PHYSICAL SETTING SOURCE MAP FINDINGS

Map ID
Direction
Distance
Elevation

Database EDR ID Number

1
South
1/4 - 1/2 Mile
Higher

FRDS PWS OH7830812

PWS ID: OH7830812
Date Initiated: 7703 Date Deactivated: Not Reported
PWS Name: CAMBRIDGE FARMS
 8745 S TOD
 LORDSTOWN, OH 44481

Addressee / Facility: System Owner/Responsible Party
 CAMBRIDGE FARMS -TRU
 8745 S TOD
 LORDSTOWN, OH 44481

Facility Latitude: 41 08 11 Facility Longitude: 080 51 40
City Served: LORDSTOWN TWP
Treatment Class: Untreated Population: 00000030

Violations information not reported.

2
NNE
1/4 - 1/2 Mile
Higher

OH WELLS OHD400000213422

Oid :	660770		
Well log n:	164136		
Well type :	WATER WELL		
End user i:	2398		
Cnty code:	155	Twp code:	1575
Orig owner:	PAUL	Orig own 1:	ELESSER
Drill type:	Not Reported	Test type :	Not Reported
Well use c:	Not Reported	Aquifer ty:	LIMESTONE
Loc map ye:	1969	Loc area:	Not Reported
Loc no:	18		
Sub name:	Not Reported	Sub map ye:	Not Reported
Sub no:	Not Reported	Permit no:	Not Reported
Sec owner :	Not Reported	Lot no:	Not Reported
Sect no:	0		
St dir cod:	Not Reported		
St no:	0		
St name:	45	St type co:	SR
Sec add:	Not Reported		
Sec add no:	0		
City:	Not Reported	State code:	OH
Zip:	Not Reported		
Well loc d:	Not Reported		
Zone code:	S		
Horiz x:	2452653.44		
Horiz y:	1151064.24		
Horiz datu:	NAD27		
Horiz acc :	0		
Horiz acc1:	0		
Horiz ac 1:	Not Reported		
Vert loc:	976.38		

GEOCHECK® - PHYSICAL SETTING SOURCE MAP FINDINGS

Vert acc:	0		
Vert acc u:	Not Reported		
Latitude:	41.148611		
Longitude:	-80.856893		
Source of :	Digitized	Flowing we:	N
Test rate:	18		
Draw down:	15		
Draw down :	.4		
S water le:	8		
S water me:	Not Reported	S water 1:	06/10/2008
Cas ht:	0		
Screen len:	0		
Total dept:	40		
Date of co:	03/18/1957	Located in:	Y
Assoc rpt :	Not Reported		
Depth to b:	0		
Drill year:	Not Reported		
Comments:	Not Reported		
Well seal :	0		
Screen slo:	0		
Screened i:	0		
Screened 1:	0		
Sustained :	0		
Attatch st:	\\NRAS1\		
Screen dia:	0		
Screen typ:	Not Reported	Screen mat:	Not Reported
Pump type:	Not Reported		
Pump capac:	0		
Pump set a:	0		
Pitless ty:	Not Reported	Pump inst :	Not Reported
Elev sourc:	Not Reported		
Water leve:	968		
Well drill:	Not Reported	Subcon odh:	Not Reported
Site id:	OHD400000213422		

3 SSE 1/2 - 1 Mile Higher

OH WELLS OHD400000211912

Oid :	534329		
Well log n:	315206		
Well type :	WATER WELL		
End user i:	1944		
Cnty code:	99	Twp code:	1345
Orig owner:	Not Reported	Orig own 1:	TED MESMER & SONS IN
Drill type:	Not Reported	Test type :	Not Reported
Well use c:	DOMESTIC	Aquifer ty:	LOAM
Loc map ye:	1974	Loc area:	Not Reported
Loc no:	15		
Sub name:	Not Reported	Sub map ye:	Not Reported
Sub no:	Not Reported	Permit no:	Not Reported
Sec owner :	TED MESMER & SON INC	Lot no:	Not Reported
Sect no:	0		
St dir cod:	N		
St no:	0		
St name:	SALEM WARREN	St type co:	RD
Sec add:	Not Reported		
Sec add no:	0		
City:	NORTH JACKSON	State code:	OH

GEOCHECK® - PHYSICAL SETTING SOURCE MAP FINDINGS

Zip:	44451		
Well loc d:	JUST ACCROSS MILTON LINE ON RT 45		
Zone code:	S		
Horiz x:	2452825.07		
Horiz y:	1145772.75		
Horiz datu:	NAD27		
Horiz acc :	0		
Horiz acc1:	0		
Horiz ac 1:	Not Reported		
Vert loc:	0		
Vert acc:	0		
Vert acc u:	Not Reported		
Latitude:	41.134088		
Longitude:	-80.856619		
Source of :	Digitized	Flowing we:	Not Reported
Test rate:	0		
Draw down:	0		
Draw down :	0		
S water le:	0		
S water me:	Not Reported	S water 1:	07/29/2005
Cas ht:	0		
Screen len:	0		
Total dept:	70		
Date of co:	11/05/1965	Located in:	Y
Assoc rpt :	Not Reported		
Depth to b:	31		
Drill year:	Not Reported		
Comments:	Not Reported		
Well seal :	0		
Screen slo:	0		
Screened i:	0		
Screened 1:	0		
Sustained :	0		
Attatch st:	\\NRAS1\		
Screen dia:	0		
Screen typ:	Not Reported	Screen mat:	Not Reported
Pump type:	Not Reported		
Pump capac:	0		
Pump set a:	0		
Pitless ty:	Not Reported	Pump inst :	Not Reported
Elev sourc:	Not Reported		
Water leve:	0		
Well drill:	Not Reported	Subcon odh:	Not Reported
Site id:	OHD400000211912		

4
NNE
1/2 - 1 Mile
Higher

OH WELLS OHD400000213758

Oid :	479876		
Well log n:	59624		
Well type :	WATER WELL		
End user i:	2440		
Cnty code:	155	Twp code:	1575
Orig owner:	WILLIAM	Orig own 1:	SMITH
Drill type:	Not Reported	Test type :	Not Reported
Well use c:	Not Reported	Aquifer ty:	SHALE
Loc map ye:	1945	Loc area:	Not Reported
Loc no:	2227		

GEOCHECK® - PHYSICAL SETTING SOURCE MAP FINDINGS

Sub name:	Not Reported	Sub map ye:	Not Reported
Sub no:	Not Reported	Permit no:	Not Reported
Sec owner :	Not Reported	Lot no:	Not Reported
Sect no:	0		
St dir cod:	Not Reported		
St no:	0		
St name:	45	St type co:	SR
Sec add:	Not Reported		
Sec add no:	0		
City:	Not Reported	State code:	OH
Zip:	Not Reported		
Well loc d:	Not Reported		
Zone code:	S		
Horiz x:	2452304.67		
Horiz y:	1152030.69		
Horiz datu:	NAD27		
Horiz acc :	0		
Horiz acc1:	0		
Horiz ac 1:	Not Reported		
Vert loc:	0		
Vert acc:	0		
Vert acc u:	Not Reported		
Latitude:	41.151279		
Longitude:	-80.858095		
Source of :	Digitized	Flowing we:	N
Test rate:	0		
Draw down:	45		
Draw down :	0		
S water le:	8		
S water me:	Not Reported	S water 1:	07/18/2002
Cas ht:	0		
Screen len:	0		
Total dept:	54		
Date of co:	06/26/1950	Located in:	Y
Assoc rpt :	Not Reported		
Depth to b:	0		
Drill year:	Not Reported		
Comments:	Not Reported		
Well seal :	0		
Screen slo:	0		
Screened i:	0		
Screened 1:	0		
Sustained :	0		
Attatch st:	\\NRAS1\		
Screen dia:	0		
Screen typ:	Not Reported	Screen mat:	Not Reported
Pump type:	Not Reported		
Pump capac:	0		
Pump set a:	0		
Pitless ty:	Not Reported	Pump inst :	Not Reported
Elev sourc:	Not Reported		
Water leve:	0		
Well drill:	Not Reported	Subcon odh:	Not Reported
Site id:	OHD400000213758		

GEOCHECK® - PHYSICAL SETTING SOURCE MAP FINDINGS

Map ID
Direction
Distance
Elevation

Database

EDR ID Number

5
SW
1/2 - 1 Mile
Higher

OH WELLS

OHD400000212016

Oid :	481913		
Well log n:	399230		
Well type :	WATER WELL		
End user i:	2353		
Cnty code:	155	Twp code:	1575
Orig owner:	EUGENE	Orig own 1:	VALLOZZI
Drill type:	Not Reported	Test type :	Not Reported
Well use c:	Not Reported	Aquifer ty:	SANDSTONE
Loc map ye:	1972	Loc area:	Not Reported
Loc no:	10		
Sub name:	Not Reported	Sub map ye:	Not Reported
Sub no:	Not Reported	Permit no:	Not Reported
Sec owner :	Not Reported	Lot no:	Not Reported
Sect no:	0		
St dir cod:	Not Reported		
St no:	0		
St name:	ELSWORTH BALLEY	St type co:	RD
Sec add:	Not Reported		
Sec add no:	0		
City:	Not Reported	State code:	OH
Zip:	Not Reported		
Well loc d:	Not Reported		
Zone code:	S		
Horiz x:	2449288.64		
Horiz y:	1146033.04		
Horiz datu:	NAD27		
Horiz acc :	0		
Horiz acc1:	0		
Horiz ac 1:	Not Reported		
Vert loc:	1000		
Vert acc:	0		
Vert acc u:	Not Reported		
Latitude:	41.134978		
Longitude:	-80.869433		
Source of :	Digitized	Flowing we:	N
Test rate:	10		
Draw down:	20		
Draw down :	2		
S water le:	20		
S water me:	Not Reported	S water 1:	08/18/2005
Cas ht:	0		
Screen len:	0		
Total dept:	70		
Date of co:	01/07/1970	Located in:	Y
Assoc rpt :	Not Reported		
Depth to b:	0		
Drill year:	Not Reported		
Comments:	Not Reported		
Well seal :	0		
Screen slo:	0		

GEOCHECK® - PHYSICAL SETTING SOURCE MAP FINDINGS

Screened i:	0		
Screened 1:	0		
Sustained :	0		
Attatch st:	Not Reported		
Screen dia:	0		
Screen typ:	Not Reported	Screen mat:	Not Reported
Pump type:	Not Reported		
Pump capac:	0		
Pump set a:	0		
Pitless ty:	Not Reported	Pump inst :	Not Reported
Elev sourc:	Not Reported		
Water leve:	980		
Well drill:	Not Reported	Subcon odh:	Not Reported
Site id:	OHD400000212016		

6
NNE
1/2 - 1 Mile
Higher

OH WELLS OHD400000213858

Oid :	479873		
Well log n:	59606		
Well type :	WATER WELL		
End user i:	2440		
Cnty code:	155	Twp code:	1575
Orig owner:	JAMES	Orig own 1:	WILSON
Drill type:	Not Reported	Test type :	Not Reported
Well use c:	Not Reported	Aquifer ty:	SHALE
Loc map ye:	1945	Loc area:	Not Reported
Loc no:	2213		
Sub name:	Not Reported	Sub map ye:	Not Reported
Sub no:	Not Reported	Permit no:	Not Reported
Sec owner :	Not Reported	Lot no:	Not Reported
Sect no:	0		
St dir cod:	Not Reported		
St no:	0		
St name:	1	St type co:	SR
Sec add:	Not Reported		
Sec add no:	0		
City:	Not Reported	State code:	OH
Zip:	Not Reported		
Well loc d:	Not Reported		
Zone code:	S		
Horiz x:	2452796.83		
Horiz y:	1152291.05		
Horiz datu:	NAD27		
Horiz acc :	0		
Horiz acc1:	0		
Horiz ac 1:	Not Reported		
Vert loc:	0		
Vert acc:	0		
Vert acc u:	Not Reported		
Latitude:	41.151969		
Longitude:	-80.856291		
Source of :	Digitized	Flowing we:	N
Test rate:	0		
Draw down:	0		
Draw down :	.5		
S water le:	25		
S water me:	Not Reported	S water 1:	01/23/2007

GEOCHECK® - PHYSICAL SETTING SOURCE MAP FINDINGS

Cas ht:	0		
Screen len:	0		
Total dept:	106		
Date of co:	12/20/1949	Located in:	Y
Assoc rpt :	Not Reported		
Depth to b:	0		
Drill year:	Not Reported		
Comments:	Not Reported		
Well seal :	0		
Screen slo:	0		
Screened i:	0		
Screened 1:	0		
Sustained :	0		
Attatch st:	\\NRAS1\		
Screen dia:	0		
Screen typ:	Not Reported	Screen mat:	Not Reported
Pump type:	Not Reported		
Pump capac:	0		
Pump set a:	0		
Pitless ty:	Not Reported	Pump inst :	Not Reported
Elev sourc:	Not Reported		
Water leve:	0		
Well drill:	Not Reported	Subcon odh:	Not Reported
Site id:	OHD400000213858		

7
SSW
1/2 - 1 Mile
Higher

OH WELLS OHD400000211867

Oid :	543369		
Well log n:	398267		
Well type :	WATER WELL		
End user i:	2119		
Cnty code:	99	Twp code:	1345
Orig owner:	Not Reported	Orig own 1:	UNITED AUTO WORKERS
Drill type:	Not Reported	Test type :	B
Well use c:	DOMESTIC	Aquifer ty:	SANDSTONE
Loc map ye:	1974	Loc area:	Not Reported
Loc no:	10		
Sub name:	Not Reported	Sub map ye:	Not Reported
Sub no:	Not Reported	Permit no:	Not Reported
Sec owner :	UNITED AUTO WORKERS	Lot no:	Not Reported
Sect no:	0		
St dir cod:	W		
St no:	0		
St name:	MAHONING TRUMBULL COUNTY	St type co:	RD
Sec add:	Not Reported		
Sec add no:	0		
City:	NORTH JACKSON	State code:	OH
Zip:	44451		
Well loc d:	COUNTY LINE RD 1/2M W OF OHIO RT 45		
Zone code:	S		
Horiz x:	2449818.59		
Horiz y:	1145556.48		
Horiz datu:	NAD27		
Horiz acc :	0		
Horiz acc1:	0		
Horiz ac 1:	Not Reported		
Vert loc:	1000		

GEOCHECK® - PHYSICAL SETTING SOURCE MAP FINDINGS

Vert acc:	0		
Vert acc u:	Not Reported		
Latitude:	41.133644		
Longitude:	-80.867542		
Source of :	Digitized	Flowing we:	Not Reported
Test rate:	20		
Draw down:	5		
Draw down :	1		
S water le:	17		
S water me:	Not Reported	S water 1:	05/04/1970
Cas ht:	0		
Screen len:	0		
Total dept:	100		
Date of co:	05/05/1970	Located in:	Y
Assoc rpt :	Not Reported		
Depth to b:	25		
Drill year:	Not Reported		
Comments:	Not Reported		
Well seal :	0		
Screen slo:	0		
Screened i:	0		
Screened 1:	0		
Sustained :	0		
Attatch st:	Not Reported		
Screen dia:	0		
Screen typ:	Not Reported	Screen mat:	Not Reported
Pump type:	Not Reported		
Pump capac:	0		
Pump set a:	0		
Pitless ty:	Not Reported	Pump inst :	Not Reported
Elev sourc:	Not Reported		
Water leve:	983		
Well drill:	Not Reported	Subcon odh:	Not Reported
Site id:	OHD400000211867		

8
SSE
1/2 - 1 Mile
Higher

OH WELLS OHD400000211752

Oid :	534367		
Well log n:	349511		
Well type :	WATER WELL		
End user i:	1723		
Cnty code:	99	Twp code:	1345
Orig owner:	BRAD	Orig own 1:	MILLER
Drill type:	Not Reported	Test type :	Not Reported
Well use c:	DOMESTIC	Aquifer ty:	STONE
Loc map ye:	1974	Loc area:	Not Reported
Loc no:	15.5		
Sub name:	Not Reported	Sub map ye:	Not Reported
Sub no:	Not Reported	Permit no:	Not Reported
Sec owner :	MILLER BRAD	Lot no:	Not Reported
Sect no:	0		
St dir cod:	N		
St no:	0		
St name:	SALEM WARREN	St type co:	RD
Sec add:	Not Reported		
Sec add no:	0		
City:	NORTH JACKSON	State code:	OH

GEOCHECK® - PHYSICAL SETTING SOURCE MAP FINDINGS

Zip:	44451		
Well loc d:	1/4M N OF TURNPIKE ON RT 45		
Zone code:	S		
Horiz x:	2452765.72		
Horiz y:	1145203.43		
Horiz datu:	NAD27		
Horiz acc :	0		
Horiz acc1:	0		
Horiz ac 1:	Not Reported		
Vert loc:	982.28		
Vert acc:	0		
Vert acc u:	Not Reported		
Latitude:	41.132529		
Longitude:	-80.856872		
Source of :	Digitized	Flowing we:	Y
Test rate:	10		
Draw down:	64		
Draw down :	1		
S water le:	5		
S water me:	Not Reported	S water 1:	06/01/1966
Cas ht:	0		
Screen len:	0		
Total dept:	85		
Date of co:	06/01/1966	Located in:	Y
Assoc rpt :	Not Reported		
Depth to b:	9		
Drill year:	Not Reported		
Comments:	Not Reported		
Well seal :	0		
Screen slo:	0		
Screened i:	0		
Screened 1:	0		
Sustained :	0		
Attatch st:	\\NRAS1\		
Screen dia:	0		
Screen typ:	Not Reported	Screen mat:	Not Reported
Pump type:	Not Reported		
Pump capac:	0		
Pump set a:	0		
Pitless ty:	Not Reported	Pump inst :	Not Reported
Elev sourc:	Not Reported		
Water leve:	977		
Well drill:	Not Reported	Subcon odh:	Not Reported
Site id:	OHD400000211752		

9
SW
1/2 - 1 Mile
Higher

OH WELLS OHD400000211874

Oid :	545452		
Well log n:	506335		
Well type :	WATER WELL		
End user i:	2437		
Cnty code:	99	Twp code:	1345
Orig owner:	EUGENE	Orig own 1:	VALLAAZNI
Drill type:	Not Reported	Test type :	B
Well use c:	DOMESTIC	Aquifer ty:	SANDSTONE
Loc map ye:	1990	Loc area:	Not Reported
Loc no:	6		

GEOCHECK® - PHYSICAL SETTING SOURCE MAP FINDINGS

Sub name:	Not Reported	Sub map ye:	Not Reported
Sub no:	Not Reported	Permit no:	Not Reported
Sec owner :	VALLAAZNI EUGENE	Lot no:	Not Reported
Sect no:	0		
St dir cod:	Not Reported		
St no:	0		
St name:	RICHARD OHLTOWN	St type co:	RD
Sec add:	Not Reported		
Sec add no:	0		
City:	Not Reported	State code:	OH
Zip:	Not Reported		
Well loc d:	3/4M W OF RT 45		
Zone code:	S		
Horiz x:	2449325.36		
Horiz y:	1145572.81		
Horiz datu:	NAD27		
Horiz acc :	0		
Horiz acc1:	0		
Horiz ac 1:	Not Reported		
Vert loc:	1000		
Vert acc:	0		
Vert acc u:	Not Reported		
Latitude:	41.133714		
Longitude:	-80.86933		
Source of :	Digitized	Flowing we:	Not Reported
Test rate:	20		
Draw down:	10		
Draw down :	4		
S water le:	10		
S water me:	Not Reported	S water 1:	06/29/1977
Cas ht:	0		
Screen len:	0		
Total dept:	75		
Date of co:	06/29/1977	Located in:	Y
Assoc rpt :	Not Reported		
Depth to b:	18		
Drill year:	Not Reported		
Comments:	Not Reported		
Well seal :	0		
Screen slo:	0		
Screened i:	0		
Screened 1:	0		
Sustained :	0		
Attatch st:	Not Reported		
Screen dia:	0		
Screen typ:	Not Reported	Screen mat:	Not Reported
Pump type:	Not Reported		
Pump capac:	0		
Pump set a:	0		
Pitless ty:	Not Reported	Pump inst :	Not Reported
Elev sourc:	Not Reported		
Water leve:	990		
Well drill:	Not Reported	Subcon odh:	Not Reported
Site id:	OHD400000211874		

GEOCHECK® - PHYSICAL SETTING SOURCE MAP FINDINGS

Map ID
Direction
Distance
Elevation

Database EDR ID Number

A10
South
1/2 - 1 Mile
Higher

OH WELLS OHD400000211425

Oid :	543353		
Well log n:	398260		
Well type :	WATER WELL		
End user i:	2119		
Cnty code:	99	Twp code:	1345
Orig owner:	ROBERT	Orig own 1:	WOLF
Drill type:	Not Reported	Test type :	B
Well use c:	DOMESTIC	Aquifer ty:	SANDSTONE
Loc map ye:	1974	Loc area:	Not Reported
Loc no:	14		
Sub name:	Not Reported	Sub map ye:	Not Reported
Sub no:	Not Reported	Permit no:	Not Reported
Sec owner :	WOLF ROBERT	Lot no:	Not Reported
Sect no:	0		
St dir cod:	Not Reported		
St no:	0		
St name:	GLADSTONE	St type co:	RD
Sec add:	Not Reported		
Sec add no:	0		
City:	NORTH JACKSON	State code:	OH
Zip:	44451		
Well loc d:	3M W OF OHIO RT 45 ON GLADSTONE RD		
Zone code:	S		
Horiz x:	2451662.51		
Horiz y:	1144104.62		
Horiz datu:	NAD27		
Horiz acc :	0		
Horiz acc1:	0		
Horiz ac 1:	Not Reported		
Vert loc:	1000		
Vert acc:	0		
Vert acc u:	Not Reported		
Latitude:	41.12957		
Longitude:	-80.860947		
Source of :	Digitized	Flowing we:	Not Reported
Test rate:	20		
Draw down:	0		
Draw down :	1		
S water le:	23		
S water me:	Not Reported	S water 1:	12/11/1969
Cas ht:	0		
Screen len:	0		
Total dept:	100		
Date of co:	12/11/1969	Located in:	Y
Assoc rpt :	Not Reported		
Depth to b:	21		
Drill year:	Not Reported		
Comments:	Not Reported		
Well seal :	0		
Screen slo:	0		

GEOCHECK® - PHYSICAL SETTING SOURCE MAP FINDINGS

Screened i:	0		
Screened 1:	0		
Sustained :	0		
Attatch st:	Not Reported		
Screen dia:	0		
Screen typ:	Not Reported	Screen mat:	Not Reported
Pump type:	Not Reported		
Pump capac:	0		
Pump set a:	0		
Pitless ty:	Not Reported	Pump inst :	Not Reported
Elev sourc:	Not Reported		
Water leve:	977		
Well drill:	Not Reported	Subcon odh:	Not Reported
Site id:	OHD400000211425		

A11 South 1/2 - 1 Mile Higher

OH WELLS OHD400000211416

Oid :	723959		
Well log n:	251790		
Well type :	WATER WELL		
End user i:	1980		
Cnty code:	99	Twp code:	1345
Orig owner:	RUPERT	Orig own 1:	WORKMAN
Drill type:	Not Reported	Test type :	B
Well use c:	DOMESTIC	Aquifer ty:	SANDSTONE
Loc map ye:	1974	Loc area:	Not Reported
Loc no:	12		
Sub name:	Not Reported	Sub map ye:	Not Reported
Sub no:	Not Reported	Permit no:	Not Reported
Sec owner :	WORKMAN RUPERT	Lot no:	Not Reported
Sect no:	0		
St dir cod:	Not Reported		
St no:	0		
St name:	GLADSTONE	St type co:	RD
Sec add:	Not Reported		
Sec add no:	0		
City:	NORTH JACKSON	State code:	OH
Zip:	44451		
Well loc d:	GLADSTON RD 1/5M W OF ST RT 45		
Zone code:	S		
Horiz x:	2451382.34		
Horiz y:	1144048.79		
Horiz datu:	NAD27		
Horiz acc :	0		
Horiz acc1:	0		
Horiz ac 1:	Not Reported		
Vert loc:	1002.76		
Vert acc:	0		
Vert acc u:	Not Reported		
Latitude:	41.129431		
Longitude:	-80.861967		
Source of :	Digitized	Flowing we:	Not Reported
Test rate:	20		
Draw down:	20		
Draw down :	1		
S water le:	22		
S water me:	Not Reported	S water 1:	07/13/1962

GEOCHECK® - PHYSICAL SETTING SOURCE MAP FINDINGS

Cas ht:	0		
Screen len:	0		
Total dept:	75		
Date of co:	07/13/1962	Located in:	Y
Assoc rpt :	Not Reported		
Depth to b:	22		
Drill year:	Not Reported		
Comments:	Not Reported		
Well seal :	0		
Screen slo:	0		
Screened i:	0		
Screened 1:	0		
Sustained :	0		
Attatch st:	\\NRAS1\		
Screen dia:	0		
Screen typ:	Not Reported	Screen mat:	Not Reported
Pump type:	Not Reported		
Pump capac:	0		
Pump set a:	0		
Pitless ty:	Not Reported	Pump inst :	Not Reported
Elev sourc:	Not Reported		
Water leve:	981		
Well drill:	Not Reported	Subcon odh:	Not Reported
Site id:	OHD400000211416		

12
North
1/2 - 1 Mile
Higher

OH WELLS OHD400000214461

Oid :	662518		
Well log n:	59639		
Well type :	WATER WELL		
End user i:	2440		
Cnty code:	155	Twp code:	1575
Orig owner:	RACHEL	Orig own 1:	SMITH
Drill type:	Not Reported	Test type :	Not Reported
Well use c:	Not Reported	Aquifer ty:	SANDSTONE
Loc map ye:	1945	Loc area:	Not Reported
Loc no:	2239		
Sub name:	Not Reported	Sub map ye:	Not Reported
Sub no:	Not Reported	Permit no:	Not Reported
Sec owner :	Not Reported	Lot no:	Not Reported
Sect no:	0		
St dir cod:	Not Reported		
St no:	0		
St name:	45	St type co:	SR
Sec add:	Not Reported		
Sec add no:	0		
City:	Not Reported	State code:	OH
Zip:	Not Reported		
Well loc d:	Not Reported		
Zone code:	S		
Horiz x:	2452272.37		
Horiz y:	1153813.8		
Horiz datu:	NAD27		
Horiz acc :	0		
Horiz acc1:	0		
Horiz ac 1:	Not Reported		
Vert loc:	0		

GEOCHECK® - PHYSICAL SETTING SOURCE MAP FINDINGS

Vert acc:	0		
Vert acc u:	Not Reported		
Latitude:	41.156172		
Longitude:	-80.858094		
Source of :	Digitized	Flowing we:	N
Test rate:	0		
Draw down:	25		
Draw down :	0		
S water le:	9		
S water me:	Not Reported	S water 1:	10/27/2008
Cas ht:	0		
Screen len:	0		
Total dept:	47		
Date of co:	12/09/1950	Located in:	Y
Assoc rpt :	Not Reported		
Depth to b:	0		
Drill year:	Not Reported		
Comments:	Not Reported		
Well seal :	0		
Screen slo:	0		
Screened i:	0		
Screened 1:	0		
Sustained :	0		
Attatch st:	\\NRAS1\		
Screen dia:	0		
Screen typ:	Not Reported	Screen mat:	Not Reported
Pump type:	Not Reported		
Pump capac:	0		
Pump set a:	0		
Pitless ty:	Not Reported	Pump inst :	Not Reported
Elev sourc:	Not Reported		
Water leve:	0		
Well drill:	Not Reported	Subcon odh:	Not Reported
Site id:	OHD400000214461		

13 South 1/2 - 1 Mile Higher

OH WELLS OHD400000211334

Oid :	546446		
Well log n:	419205		
Well type :	WATER WELL		
End user i:	758		
Cnty code:	99	Twp code:	1345
Orig owner:	Not Reported	Orig own 1:	MAGNETIC ANALYSIS
Drill type:	Not Reported	Test type :	Not Reported
Well use c:	PUBLIC/SEMI-PUB	Aquifer ty:	DRIFT
Loc map ye:	1974	Loc area:	Not Reported
Loc no:	11		
Sub name:	Not Reported	Sub map ye:	Not Reported
Sub no:	Not Reported	Permit no:	Not Reported
Sec owner :	MAGNETIC ANALYSIS	Lot no:	Not Reported
Sect no:	0		
St dir cod:	Not Reported		
St no:	0		
St name:	GLADSTONE	St type co:	RD
Sec add:	Not Reported		
Sec add no:	0		
City:	NORTH JACKSON	State code:	OH

GEOCHECK® - PHYSICAL SETTING SOURCE MAP FINDINGS

Zip:	44451		
Well loc d:	1/2M W OF OHIO RT 45		
Zone code:	S		
Horiz x:	2451177.02		
Horiz y:	1143702.75		
Horiz datu:	NAD27		
Horiz acc :	0		
Horiz acc1:	0		
Horiz ac 1:	Not Reported		
Vert loc:	1005.33		
Vert acc:	0		
Vert acc u:	Not Reported		
Latitude:	41.128492		
Longitude:	-80.862735		
Source of :	Digitized	Flowing we:	Not Reported
Test rate:	27		
Draw down:	27		
Draw down :	.5		
S water le:	29		
S water me:	Not Reported	S water 1:	10/27/1970
Cas ht:	0		
Screen len:	0		
Total dept:	105		
Date of co:	10/27/1970	Located in:	Y
Assoc rpt :	Not Reported		
Depth to b:	25		
Drill year:	Not Reported		
Comments:	Not Reported		
Well seal :	0		
Screen slo:	0		
Screened i:	0		
Screened 1:	0		
Sustained :	0		
Attatch st:	Not Reported		
Screen dia:	0		
Screen typ:	Not Reported	Screen mat:	Not Reported
Pump type:	Not Reported		
Pump capac:	0		
Pump set a:	0		
Pitless ty:	Not Reported	Pump inst :	Not Reported
Elev sourc:	Not Reported		
Water leve:	976		
Well drill:	Not Reported	Subcon odh:	Not Reported
Site id:	OHD400000211334		

14
NNE
1/2 - 1 Mile
Higher

OH WELLS OHD400000214446

Oid :	479879		
Well log n:	59638		
Well type :	WATER WELL		
End user i:	2440		
Cnty code:	155	Twp code:	1575
Orig owner:	C	Orig own 1:	ELESSER
Drill type:	Not Reported	Test type :	Not Reported
Well use c:	Not Reported	Aquifer ty:	LIMESTONE
Loc map ye:	1945	Loc area:	Not Reported
Loc no:	2238		

GEOCHECK® - PHYSICAL SETTING SOURCE MAP FINDINGS

Sub name:	Not Reported	Sub map ye:	Not Reported
Sub no:	Not Reported	Permit no:	Not Reported
Sec owner :	Not Reported	Lot no:	Not Reported
Sect no:	0		
St dir cod:	Not Reported		
St no:	0		
St name:	45	St type co:	SR
Sec add:	Not Reported		
Sec add no:	0		
City:	Not Reported	State code:	OH
Zip:	Not Reported		
Well loc d:	Not Reported		
Zone code:	S		
Horiz x:	2452700.88		
Horiz y:	1153797.22		
Horiz datu:	NAD27		
Horiz acc :	0		
Horiz acc1:	0		
Horiz ac 1:	Not Reported		
Vert loc:	0		
Vert acc:	0		
Vert acc u:	Not Reported		
Latitude:	41.156105		
Longitude:	-80.85654		
Source of :	Digitized	Flowing we:	N
Test rate:	0		
Draw down:	27		
Draw down :	0		
S water le:	6		
S water me:	Not Reported	S water 1:	04/12/2003
Cas ht:	0		
Screen len:	0		
Total dept:	61		
Date of co:	11/27/1950	Located in:	Y
Assoc rpt :	Not Reported		
Depth to b:	0		
Drill year:	Not Reported		
Comments:	Not Reported		
Well seal :	0		
Screen slo:	0		
Screened i:	0		
Screened 1:	0		
Sustained :	0		
Attatch st:	\\NRAS1\		
Screen dia:	0		
Screen typ:	Not Reported	Screen mat:	Not Reported
Pump type:	Not Reported		
Pump capac:	0		
Pump set a:	0		
Pitless ty:	Not Reported	Pump inst :	Not Reported
Elev sourc:	Not Reported		
Water leve:	0		
Well drill:	Not Reported	Subcon odh:	Not Reported
Site id:	OHD400000214446		

GEOCHECK® - PHYSICAL SETTING SOURCE MAP FINDINGS

Map ID
Direction
Distance
Elevation

Database EDR ID Number

B15
SSW
1/2 - 1 Mile
Higher

OH WELLS OHD400000211390

Oid :	680655		
Well log n:	959636		
Well type :	WATER WELL		
End user i:	569		
Cnty code:	99	Twp code:	1345
Orig owner:	STEVE	Orig own 1:	RAFFA
Drill type:	ROTARY	Test type :	A
Well use c:	DOMESTIC	Aquifer ty:	SANDSTONE
Loc map ye:	Not Reported	Loc area:	Not Reported
Loc no:	0		
Sub name:	Not Reported	Sub map ye:	Not Reported
Sub no:	Not Reported	Permit no:	Not Reported
Sec owner :	Not Reported	Lot no:	Not Reported
Sect no:	0		
St dir cod:	Not Reported		
St no:	11510		
St name:	GLADSTONE	St type co:	RD
Sec add:	Not Reported		
Sec add no:	0		
City:	NORTH JACKSON	State code:	OH
Zip:	44451		
Well loc d:	Not Reported		
Zone code:	S		
Horiz x:	2449837.6		
Horiz y:	1143918.38		
Horiz datu:	NAD27		
Horiz acc :	0		
Horiz acc1:	0		
Horiz ac 1:	Not Reported		
Vert loc:	0		
Vert acc:	0		
Vert acc u:	Not Reported		
Latitude:	41.12915		
Longitude:	-80.86758		
Source of :	GPS	Flowing we:	Not Reported
Test rate:	15		
Draw down:	35		
Draw down :	.5		
S water le:	40		
S water me:	G	S water 1:	09/16/2003
Cas ht:	1		
Screen len:	0		
Total dept:	105		
Date of co:	09/16/2003	Located in:	Not Reported
Assoc rpt :	Not Reported		
Depth to b:	0		
Drill year:	Not Reported		
Comments:	Not Reported		
Well seal :	0		
Screen slo:	0		

GEOCHECK® - PHYSICAL SETTING SOURCE MAP FINDINGS

Screened i:	0		
Screened 1:	0		
Sustained :	20		
Attatch st:	Not Reported		
Screen dia:	0		
Screen typ:	Not Reported	Screen mat:	Not Reported
Pump type:	Not Reported		
Pump capac:	0		
Pump set a:	0		
Pitless ty:	Not Reported	Pump inst :	Not Reported
Elev sourc:	Not Reported		
Water leve:	0		
Well drill:	Not Reported	Subcon odh:	Not Reported
Site id:	OHD400000211390		

B16
SSW
1/2 - 1 Mile
Higher

OH WELLS OHD400000211407

Oid :	779145		
Well log n:	1009079		
Well type :	WATER WELL		
End user i:	742		
Cnty code:	99	Twp code:	1345
Orig owner:	JEFF	Orig own 1:	MORRISON
Drill type:	ROTARY	Test type :	A
Well use c:	DOMESTIC	Aquifer ty:	Not Reported
Loc map ye:	Not Reported	Loc area:	Not Reported
Loc no:	0		
Sub name:	Not Reported	Sub map ye:	Not Reported
Sub no:	Not Reported	Permit no:	6086
Sec owner :	Not Reported	Lot no:	Not Reported
Sect no:	0		
St dir cod:	Not Reported		
St no:	11662		
St name:	GLADSTONE	St type co:	RD
Sec add:	Not Reported		
Sec add no:	0		
City:	JACKSON	State code:	OH
Zip:	Not Reported		
Well loc d:	Not Reported		
Zone code:	Not Reported		
Horiz x:	0		
Horiz y:	0		
Horiz datu:	Not Reported		
Horiz acc :	0		
Horiz acc1:	0		
Horiz ac 1:	Not Reported		
Vert loc:	1007		
Vert acc:	0		
Vert acc u:	Not Reported		
Latitude:	41.12933		
Longitude:	-80.86867		
Source of :	Not Reported	Flowing we:	Not Reported
Test rate:	10		
Draw down:	70		
Draw down :	0		
S water le:	27		
S water me:	T	S water 1:	10/22/2008

GEOCHECK® - PHYSICAL SETTING SOURCE MAP FINDINGS

Cas ht:	1		
Screen len:	0		
Total dept:	100		
Date of co:	10/24/2008	Located in:	Not Reported
Assoc rpt :	Not Reported		
Depth to b:	0		
Drill year:	Not Reported		
Comments:	Not Reported		
Well seal :	0		
Screen slo:	0		
Screened i:	0		
Screened 1:	0		
Sustained :	10		
Attatch st:	Not Reported		
Screen dia:	0		
Screen typ:	Not Reported	Screen mat:	Not Reported
Pump type:	Not Reported		
Pump capac:	0		
Pump set a:	0		
Pitless ty:	Not Reported	Pump inst :	Not Reported
Elev sourc:	Not Reported		
Water leve:	0		
Well drill:	Not Reported	Subcon odh:	Not Reported
Site id:	OHD400000211407		

GEOCHECK® - PHYSICAL SETTING SOURCE MAP FINDINGS

RADON

AREA RADON INFORMATION

State Database: OH Radon

Radon Test Results

Zip	Total Sites	Median	1st Quartile	3rd Quartile	Min.	Max.
44481	65	1.1	0.4	2.68	0.1	11.1

Federal EPA Radon Zone for TRUMBULL County: 2

Note: Zone 1 indoor average level > 4 pCi/L.
 : Zone 2 indoor average level >= 2 pCi/L and <= 4 pCi/L.
 : Zone 3 indoor average level < 2 pCi/L.

Federal Area Radon Information for Zip Code: 44481

Number of sites tested: 1

Area	Average Activity	% <4 pCi/L	% 4-20 pCi/L	% >20 pCi/L
Living Area - 1st Floor	0.300 pCi/L	100%	0%	0%
Living Area - 2nd Floor	Not Reported	Not Reported	Not Reported	Not Reported
Basement	Not Reported	Not Reported	Not Reported	Not Reported

PHYSICAL SETTING SOURCE RECORDS SEARCHED

TOPOGRAPHIC INFORMATION

USGS 7.5' Digital Elevation Model (DEM)

Source: United States Geologic Survey

EDR acquired the USGS 7.5' Digital Elevation Model in 2002 and updated it in 2006. The 7.5 minute DEM corresponds to the USGS 1:24,000- and 1:25,000-scale topographic quadrangle maps. The DEM provides elevation data with consistent elevation units and projection.

Scanned Digital USGS 7.5' Topographic Map (DRG)

Source: United States Geologic Survey

A digital raster graphic (DRG) is a scanned image of a U.S. Geological Survey topographic map. The map images are made by scanning published paper maps on high-resolution scanners. The raster image is georeferenced and fit to the Universal Transverse Mercator (UTM) projection.

HYDROLOGIC INFORMATION

Flood Zone Data: This data, available in select counties across the country, was obtained by EDR in 1999 from the Federal Emergency Management Agency (FEMA). Data depicts 100-year and 500-year flood zones as defined by FEMA.

NWI: National Wetlands Inventory. This data, available in select counties across the country, was obtained by EDR in 2002 and 2005 from the U.S. Fish and Wildlife Service.

State Wetlands Data: Wetlands Inventory

Source: Department of Natural Resources

Telephone: 614-265-1044

HYDROGEOLOGIC INFORMATION

AQUIFLOW^R Information System

Source: EDR proprietary database of groundwater flow information

EDR has developed the AQUIFLOW Information System (AIS) to provide data on the general direction of groundwater flow at specific points. EDR has reviewed reports submitted to regulatory authorities at select sites and has extracted the date of the report, hydrogeologically determined groundwater flow direction and depth to water table information.

GEOLOGIC INFORMATION

Geologic Age and Rock Stratigraphic Unit

Source: P.G. Schruben, R.E. Arndt and W.J. Bawiec, Geology of the Conterminous U.S. at 1:2,500,000 Scale - A digital representation of the 1974 P.B. King and H.M. Beikman Map, USGS Digital Data Series DDS - 11 (1994).

STATSGO: State Soil Geographic Database

Source: Department of Agriculture, Natural Resources Conservation Services

The U.S. Department of Agriculture's (USDA) Natural Resources Conservation Service (NRCS) leads the national Conservation Soil Survey (NCSS) and is responsible for collecting, storing, maintaining and distributing soil survey information for privately owned lands in the United States. A soil map in a soil survey is a representation of soil patterns in a landscape. Soil maps for STATSGO are compiled by generalizing more detailed (SSURGO) soil survey maps.

SSURGO: Soil Survey Geographic Database

Source: Department of Agriculture, Natural Resources Conservation Services (NRCS)

Telephone: 800-672-5559

SSURGO is the most detailed level of mapping done by the Natural Resources Conservation Services, mapping scales generally range from 1:12,000 to 1:63,360. Field mapping methods using national standards are used to construct the soil maps in the Soil Survey Geographic (SSURGO) database. SSURGO digitizing duplicates the original soil survey maps. This level of mapping is designed for use by landowners, townships and county natural resource planning and management.

PHYSICAL SETTING SOURCE RECORDS SEARCHED

LOCAL / REGIONAL WATER AGENCY RECORDS

FEDERAL WATER WELLS

PWS: Public Water Systems

Source: EPA/Office of Drinking Water

Telephone: 202-564-3750

Public Water System data from the Federal Reporting Data System. A PWS is any water system which provides water to at least 25 people for at least 60 days annually. PWSs provide water from wells, rivers and other sources.

PWS ENF: Public Water Systems Violation and Enforcement Data

Source: EPA/Office of Drinking Water

Telephone: 202-564-3750

Violation and Enforcement data for Public Water Systems from the Safe Drinking Water Information System (SDWIS) after August 1995. Prior to August 1995, the data came from the Federal Reporting Data System (FRDS).

USGS Water Wells: USGS National Water Inventory System (NWIS)

This database contains descriptive information on sites where the USGS collects or has collected data on surface water and/or groundwater. The groundwater data includes information on wells, springs, and other sources of groundwater.

STATE RECORDS

Public Water System Data

Source: Ohio Environmental Protection Agency

Telephone: 614-644-3677

The database includes community, transient noncommunity and nontransient noncommunity water wells; and source treatment unit locations.

Water Well Database

Source: Department of Natural Resources

Telephone: 614-265-6747

OTHER STATE DATABASE INFORMATION

RADON

State Database: OH Radon

Source: Department of Health

Telephone: 614-644-2727

Radon Statistics for Zip Code Areas

Area Radon Information

Source: USGS

Telephone: 703-356-4020

The National Radon Database has been developed by the U.S. Environmental Protection Agency (USEPA) and is a compilation of the EPA/State Residential Radon Survey and the National Residential Radon Survey. The study covers the years 1986 - 1992. Where necessary data has been supplemented by information collected at private sources such as universities and research institutions.

EPA Radon Zones

Source: EPA

Telephone: 703-356-4020

Sections 307 & 309 of IRAA directed EPA to list and identify areas of U.S. with the potential for elevated indoor radon levels.

OTHER

Airport Landing Facilities: Private and public use landing facilities

Source: Federal Aviation Administration, 800-457-6656

Epicenters: World earthquake epicenters, Richter 5 or greater

Source: Department of Commerce, National Oceanic and Atmospheric Administration

PHYSICAL SETTING SOURCE RECORDS SEARCHED

STREET AND ADDRESS INFORMATION

© 2009 Tele Atlas North America, Inc. All rights reserved. This material is proprietary and the subject of copyright protection and other intellectual property rights owned by or licensed to Tele Atlas North America, Inc. The use of this material is subject to the terms of a license agreement. You will be held liable for any unauthorized copying or disclosure of this material.