

BULLETIN #114
3-6-78

LEGEND	
PROPOSED	DESCRIPTION
—	FIRE LINE
—	INDUSTRIAL WASTE
—	SANITARY SEWER
—	CITY WATER SUPPLY
—	STORM (RAIN) SEWER
●	MANHOLE
●	FIRE HYDRANT
■	CATCH BASIN

SCHEDULE OF MECHANICAL DRAWINGS			
MP-1M	MASTER PLOT PLAN - MECH. LAYOUT	59-M	PENTHOUSE NO. 2 PLAN & ELEVATION
MP-2M	LEGEND AND ABBREVIATIONS	40-M	PENTHOUSE ELEVATIONS
1-M	PART SITE PLAN - MECHANICAL SERVICES	41-M	HEATING DIAGRAMS & DETAILS
2-M	" " " " " "	42-M	PIPING SYSTEMS FLOW DIAGRAM
3-M	" " " " " "	43-M	H.W. RADIATION & CH.W. FLOW DIAGRAMS
4-M	" " " " " "	44-M	HEAT RECOVERY & PROCESS COOLING DIAGRAMS
5-M	" " " " " "	45-M	HEATING EQUIP. SCHEDULES
6-M	" " " " " "	46-M	HVAC EQUIP. SCHEDULES
7-M	" " " " " "	47-M	" " DETAILS
8-M	" " " " " "	48-M	" " " "
9-M	" " " " " "	49-M	" " TEMPERATURE
10-M	" " " " " "	50-M	" " " "
11-M	SCHEDULES & DETAILS OF MANHOLES, CATCH BASINS	51-M	BAGHOUSE AIR
12-M	SITE DETAILS - MECHANICAL WORK	52-M	" " " "
13-M	PROFILE OF STORM SEWER	53-M	" " " "
14-M	PROFILE OF SANITARY & INDUSTRIAL WASTE	54-M	COOLING
15-M	PART FIRST FLOOR PLAN - PLUMBING	55-M	" " " "
16-M	" " " " " LABORATORY	56-M	" " " "
17-M	" " " " " " "	57-M	" " " "
18-M	" " " " " " "	58-M	" " " "
19-M	" " " " " " "	59-M	" " " "
20-M	PERFORMANCE TEST CELLS - FIRST FLOOR PLAN	60-M	" " " "
21-M	" " " " " MEZZANINE PLAN	61-M	" " " "
22-M	EMERGENCY GENERATOR & DYNAMOMETER PIT	62	" " " "
23-M	TOILET ROOM PLUMBING DETAILS		
24-M	MISCELLANEOUS PLUMBING DETAILS		
25-M	PART FIRST FLOOR PLAN - HVAC	100	
26-M	" " " " " LABORATORY	101	
27-M	" " " " " " "	102	
28-M	" " " " " " "	103	
29-M	" " " " " EQUIP. STORAGE	104	
30-M	OFFICE MEZZ. FLOOR PLAN & SERVICES COM.	105	
31-M	PART FIRST FLOOR PLAN - PEAP TEST CELLS		
32-M	TYPICAL PERFORMANCE TEST CELL		
33-M	TEST CELL - MEZZ. FLOOR PLAN		
34-M	" " " " " " "		
35-M	MEZZ. FLOOR ELEVATIONS		
36-M	PENTHOUSE NO. 1 PLAN & ELEV.		
37-M	" " NO. 2 "		
38-M	" " " "		

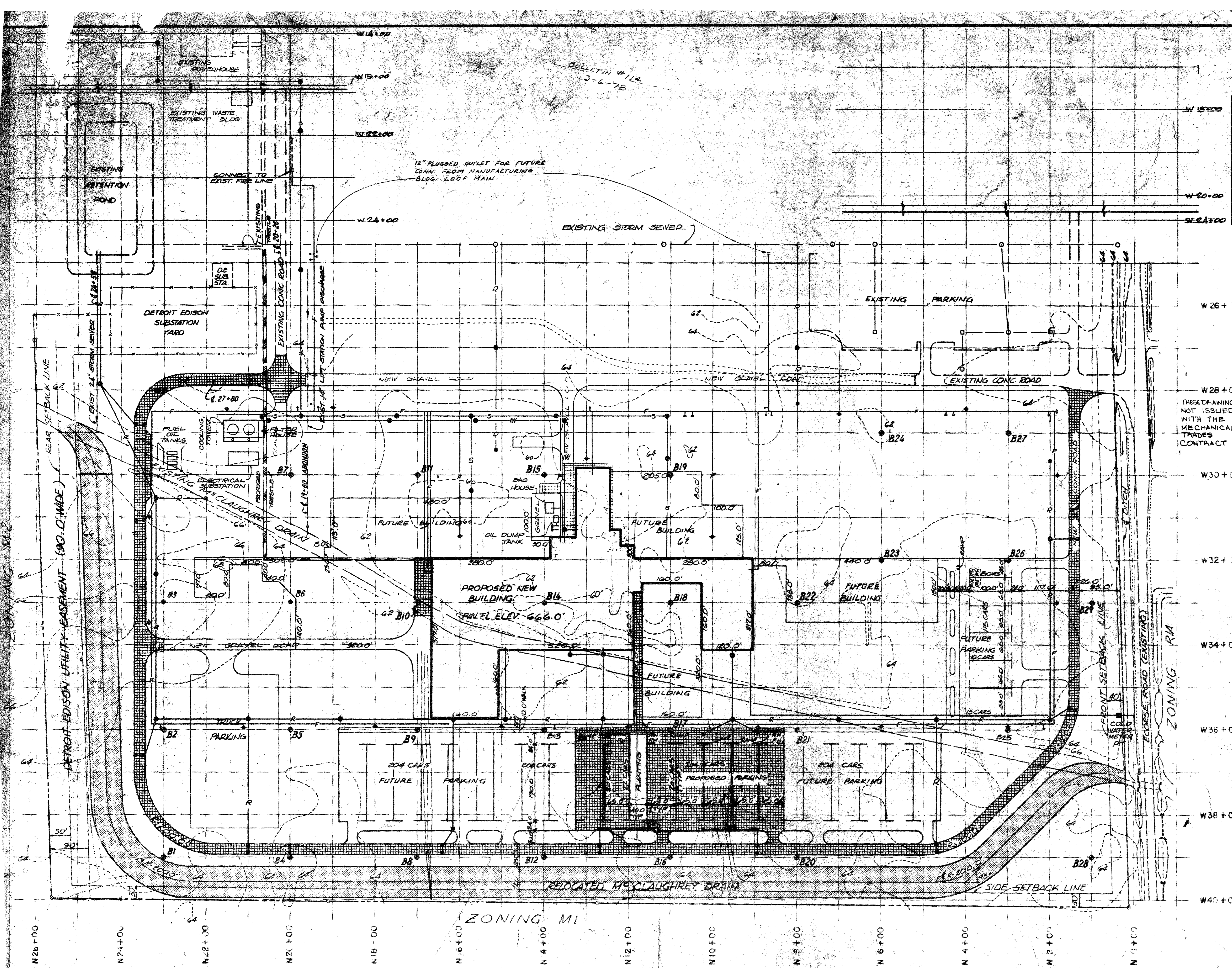

MASTER PLOT PLAN
North
SCALE 1/400

FOR DETAILS OF MECHANICAL
SEE DRAWING NO. 10 IN THIRD

REVISIONS			
Date	By	Date	By
3-6-78	RDS		

IN CHARGE: GVA HOLNESS
TRACED: RDS
DRAWN: GVRH
CHECKED: GVAH
DATE 11-18-77 APP.

ALBERT KAHN ASSOCIATES
ARCHITECTS AND ENGINEERS
NEW CENTER BUILDING