

17075



**Worldwide Facilities Group
Remediation Team
September 18, 2003**

MDEQ Michigan District
Remediation and Redevelopment Division,
MDEQ
Saginaw Bay District Office
503 N. Euclid Ave., Suite 1
Bay City, Michigan 48706-2965
(989) 686-8025

Dear Sir or Madam:

Re: Form 4482, Notice of Migration of Contamination
Saginaw Metal Castings Operation
2100 Veterans Memorial Parkway, Washington Ave. & Veterans Memorial Pkwy
Saginaw/Saginaw

GM hereby provides a completed form EQP 4482 to advise of contaminant migration pursuant to Part 201 of Act 451. Although the information is provided sufficient to satisfy obligations pursuant to both R 299.5522 and R 299.51017, provision of this information does not indicate GM admits to being subject to MCL 324.20114 for conditions at this location.

Please note that notifications have not been made to property owners east of Outer Drive since based on actual soil boring data, the upper water bearing zone pinches out on the east side of Outer Drive and therefore contaminant migration cannot occur to the east.

Previous notifications were provided on June 7, 1999 and December 26, 2002.

For additional information regarding this submittal or conditions at this location please contact me at (248) 680-5219.

Sincerely,

A handwritten signature in black ink, appearing to read "Cheryl Hiatt", written over the printed name.

Cheryl Hiatt
Senior Environmental Engineer
General Motors Corporation

Cc: Edward Peterson
Tony Thrubis



MICHIGAN DEPARTMENT OF ENVIRONMENTAL QUALITY
REMEDIATION AND REDEVELOPMENT DIVISION

For DEQ Use Only
ITS # _____
Site ID # _____
Category Code: _____

NOTICE OF MIGRATION OF CONTAMINATION

(Under the authority of Part 201, Natural Resources and Environmental Protection Act, 1994 Act 451, as amended, (NREPA) and the Rules promulgated thereunder)

An owner or operator of property that is a facility, and/or who is subject to MCL 324.20114, and who has reason to believe that a hazardous substance is emanating from, has emanated from, or is likely to be emanating from the property and migrating beyond the boundaries of the property that he or she owns or operates is required under R 299.5522 and R 299.51017(1) to notify the Michigan Department of Environmental Quality ("DEQ") and affected property owners, unless he or she is exempt from MCL 324.20107a (see MCL 324.20107a(4) for exemptions), or unless he or she has provided the notice required by MCL 324.21309a.

The notice must be provided within 45 days after the owner or operator has reason to believe that hazardous substances have migrated, or are likely to have migrated, to or beyond the boundary of his or her property (see R 299.51017 and R 299.5522 for exceptions). If a person is required to provide additional notice as a result of the changes in R 299.51017 that took effect on December 21, 2002, then that additional notice shall be provided not later than September 21, 2003.

Use of this form is mandatory for the notice required by R 299.51017(1) and may also be used by parties subject to MCL 324.20114 to provide notice required by R 299.5522. This form may also be used to provide notice to affected property owners as required by those rules.

If a person holds a permit for an oil and gas well under Part 615, Supervisor of Wells, of the NREPA and there is a release from the oil and gas exploration or production activities, that person shall give notice to the DEQ and to the owner of the surface rights of the property.

If a person holds an easement and there is a release from the easement holder's activities, that person shall provide notice to the DEQ and to the grantor of the easement, or the grantor's successor in interest, if any.

Completing this notice in no way relieves a person who is subject to MCL 324.20114 from the responsibility to undertake required response activities.

This notice must be sent to the DEQ office that serves the county in which the property is located. A list of DEQ offices is attached. The DEQ will not prepare acknowledgement of receipt of these notices. The sender is responsible for sending the report using a method that provides proof of delivery if such proof is desired. Please label the outside of the envelope "Migration Notice."

THIS NOTICE IS PROVIDED PURSUANT TO:

(check both, if applicable)

R 299.5522



R 299.51017



Please provide the following information as completely as possible.

1. Name and location of the property that hazardous substances are emanating from:

2. Status relative to the property:
(Check one or both, as applicable.)

Name: SAGINAW METAL CASTINGS OPERATION

Address: 2100 VETERANS MEMORIAL PARKWAY

Location: WASHINGTON AVENUE & VETERANS MEMORIAL PARKWAY

City/County: SAGINAW/SAGINAW

Owner



Operator



Please provide any additional ID numbers associated with the property (e.g., EPA ID No., BEA No., etc.)

MID 041 793 340

3. Name, address and telephone number of the property owner or operator submitting the notice:

Name: GENERAL MOTORS CORP/WFG-REMEDIATION, MAIL CODE 483-619-356

Address: TROY TECH PARK SOUTH – BLDG A, 1996 TECHNOLOGY DRIVE

City/State: TROY, MICHIGAN

Telephone number: (248) 680-5219

4. Name, address and telephone number of a contact person familiar with the content of the notice:

Name: CHERYL HIATT

Address: TROY TECH PARK SOUTH – BLDG A, 1996 TECHNOLOGY DRIVE

City/State: TROY, MICHIGAN

Telephone: (248) 680-5219

5. If this Notice is provided pursuant to R 299.51017, provide the address and other location information for the *adjacent* property onto which contamination has migrated. If this Notice is provided pursuant to R 299.5522, provide the address and other location information for *each* property onto which contamination has migrated.

Address: 1753 N 6TH AVE

City/State: Saginaw, MI

Property Tax ID number: 01-0937-00000

Other:

Notified? No ☐ Yes ☒

Date: Sep. 18, 03

Address: 1827 1ST STREET

City/State: Saginaw, MI

Property Tax ID number: 01-0620-00000

Other:

Notified? No ☐ Yes ☒

Date: Sep. 18, 03

Address: 1601 N 6th Ave.

City/State: Saginaw, MI

Property Tax ID number: 01-0938-00000

Other:

Notified? No ☐ Yes ☒

Date: Sep. 18, 03

Address: 1227 N WASHINGTON AVE

City/State: Saginaw, MI

Property Tax ID number: 01-0935-0000

Other:

Notified? No ☐ Yes ☒

Date: Sep. 18, 03

Address: 1203 N WASHINGTON AVE

City/State: Saginaw, MI

Property Tax ID number: 01-0934-00000

Other:

Notified? No ☐ Yes ☒

Date: Sep. 18, 03

Address: 2406 VETERANS MEMORIAL PRKY

City/State: Saginaw, MI

Property Tax ID number: 10-12-5-05-4171-A00, 10-12-5-05-4010-000, 10-12-5-05-4009-000

Other:

Notified? No ☐ Yes ☒

Date: Sep. 18, 03

Address: 1900 N 23RD

City/State: Saginaw, MI

Property Tax ID number: 10-12-5-08-4007-000, 10-12-5-08-4008-000, 10-12-5-08-4010-000, 10-12-5-08-4028-000

Other:

Notified? No ☐ Yes ☒

Date: Sep. 18, 03

Address: 2300 Veterans Memorial Dr.
City/State: Saginaw, MI
Property Tax ID number: 21-4333-002-00
Other:

Notified? No ☐ Yes ☒

Date: Sep. 18, 03

Address: Exit 153, I-75

Notified? No ☐ Yes ☒

Date: Sep. 18, 03

City/State: Saginaw, MI

Property Tax ID number: 10-12-5-05-4105-B00, 10-12-5-05-4002-A00, 10-12-5-05-4124-A00, 10-12-5-05-1002-A00, 10-12-5-05-1006-A00

Other:

Address: 2301 VETERANS MEMORIAL PKWY

Notified? No ☐ Yes ☒

Date: Sep. 18, 03

City/State: Saginaw, MI

Property Tax ID number: 21-4335-00100

Other:

Address: 4500 CROW ISLAND

Notified? No ☐ Yes ☒

Date: Sep. 18, 03

City/State: Saginaw, MI

Property Tax ID number: 10-12-5-05-4007-000

Other:

Address: Veterans Memorial Parkway

Notified? No ☐ Yes ☒

Date: Sep. 18, 03

City/State: Saginaw, MI

Property Tax ID number:

Other: Control Section - 73091

6. Complete the Table on Page 3 of this Form for each hazardous substance which has migrated, or is likely to have migrated, beyond the property boundary at a concentration that exceeds a Generic Residential Cleanup Criterion developed by the DEQ pursuant to MCL 324.20120a(1). Complete and attach additional copies of Page 3, if necessary, to list all hazardous substances that must be reported. Include a scaled map or drawing that shows the location of sampling points identified on the Table on Page 3.

See Table 1 and Figure 1

7. Provide a summary of the information which shows that contamination is emanating from, or has emanated from, and is present beyond the boundary of the source property at a concentration which exceeds that allowed by MCL 324.20120a(1)(a). This summary shall identify the environmental media affected, specific hazardous substances, and the concentrations of those hazardous substances in all affected environmental media at the property boundary and in any sample locations beyond the property boundary. The summary shall also describe the basis for the conclusion that the contamination is emanating, has emanated, or is present beyond the boundary of the source property, including whether the conclusion is based on groundwater analytical data or fate and transport modeling, both, or neither.

See Table 1 and Figure 1

8. If the person making this notice has reason to believe that a migrating hazardous substance has affected, or is likely to affect, a private or public water supply, then that water supply must be identified here:

9. Is this notice being submitted within the timeframes established under R 299.5522 and/or R 299.51017, as applicable?

YES ☒ NO ☐

10. Is this notice in addition to a notice submitted prior to December 21, 2002?
(R 299.51017(4)(c))

☒ ☐

11. Is this notice related to an oil and gas well permit (R 299.51017(2))?



12. Is this notice related to an easement (R 299.51017(3))?



(NOTE: All easement grantors *must* receive this notice.)

13. Has a surface water been affected (R 299.51017(1) and R 299.5522(2))?



(If yes, please identify the affected surface water body.) SAGINAW RIVER

CERTIFICATION:

With my signature below, I certify that I am the owner of the facility or that I am legally authorized to execute this notice on behalf of the owner or operator named on this form, and that to the best of my knowledge and belief the above representations are complete and accurate. I understand that intentionally submitting false information to the DEQ is a felony and may result in fines up to \$25,000 for each violation.

Signature

Cheryl Hiatt on behalf of General Motors Corp
(Owner or person legally authorized to bind the person making this report)

Date

09/18/03

Name (Typed or Printed)

CHERYL HIATT

Title (Typed or Printed)

SENIOR ENVIRONMENTAL ENGINEER



MICHIGAN DEPARTMENT OF ENVIRONMENTAL QUALITY
REMEDIATION AND REDEVELOPMENT DIVISION

NOTICE OF MIGRATION OF CONTAMINATION

(Under the authority of Part 201, Natural Resources and Environmental Protection Act, 1994 Act 451, as amended, (NREPA) and the Rules promulgated thereunder)

See Item 6 on Page 2 of this Form for instructions to be used in completing this Table. Attach additional pages if necessary. The information to be included in each column of the Table is:

Column A

Name of hazardous substance.

Column B

Chemical Abstract Service (CAS) Number for the hazardous substance.

Column C

Sample location for Column C (relate to label on map).

Column D

Maximum hazardous substance concentration measured on the property, expressed parts per billion (e.g. ug/L or ug/Kg). Report maximum concentration separately for each environmental medium.

Column E

Environmental medium in which concentration reported in Column C was measured (e.g., soil or groundwater).

Column F

Distance from point of maximum measured concentration (Column D) to property boundary, in direction of contaminant migration, if direction is known or can reasonably be inferred. If direction is unknown, list distance to nearest property boundary.

Column G

Direction of contaminant migration, if known.

Column H

Sample location for Column I (relate to label on map).

Column I

Concentration closest to property boundary, if known. If a concentration lower than the maximum concentration reported in Column C has been measured at a point closer to the property boundary in the direction of contaminant migration, use Column I to list the concentration that was measured closest to the property boundary in the direction of contaminant migration.

Column J

Environmental medium for measurement reported in Column I, if applicable.

A Hazardous Substance	B CAS Number	C Maximum Concentration	D Sample Location for "C"	E Environmental Medium for "C"	F Distance to Property Boundary	G Direction of Migration	H Sample Location for "I"	I Boundary Concentration	J Environmental Medium for "I"
SEE	ATTACHED	TABLE 1							

Total Number Samples Collected: _____

Total Number of Samples Exceeding Criteria: _____

**ADDRESSES FOR SUBMITTALS
TO DEPARTMENT OF ENVIRONMENTAL QUALITY**

All Upper Peninsula counties:

Remediation and Redevelopment Division
(RRD)
Upper Peninsula District Office
K.I. Sawyer International Airport and
Business Center
420 Fifth Street
Gwinn, Michigan 49855-9198
(906) 346-8300

**Benzie, Grand Traverse, Lake, Leelanau,
Manistee, Mason, Osceola, and Wexford
counties:**

RRD
Cadillac District Office
120 W. Chapin St.
Cadillac, Michigan 49601
(231) 775-3960

**Alcona, Alpena, Antrim, Charlevoix,
Cheboygan, Crawford, Emmet, Kalkaska,
Missaukee, Montmorency, Oscoda, Otsego,
Presque Isle, and Roscommon counties:**

RRD
Gaylord Field Office
1732 West M-32
P.O. Box 667
Gaylord, Michigan 49735-0667
(989) 731-4920

**Arenac, Bay, Clare, Gladwin, Huron, Iosco,
Isabella, Midland, Ogemaw, Saginaw, Sanilac,
and Tuscola counties:**

RRD
Saginaw Bay District Office
503 N. Euclid Ave., Suite 1
Bay City, Michigan 48706-2965
(989) 686-8025

**Barry, Ionia, Kent, Mecosta, Montcalm,
Muskegon, Newaygo, Oceana, and Ottawa
counties:**

RRD
Grand Rapids District Office
245 Colrain, SW
Wyoming, Michigan 49548-1013
(616) 246-1720

**Clinton, Eaton, Genesee, Gratiot, Ingham,
Lapeer, Livingston, and Shiawassee counties:**

RRD
Lansing District Office
P.O. Box 30426
525 W. Allegan Street
Lansing, Michigan 48909
(517) 335-6010

**Macomb, Oakland, St. Clair, and Wayne
counties (except City of Detroit):**

RRD
Southeast Michigan District Office
38980 Seven Mile Road
Livonia, Michigan 48152-1006
(734) 953-8905

(City of Detroit, Hamtramck and Highland Park)

RRD
Detroit Office
3058 W. Grand Blvd.
Cadillac Place, Suite 2-300
Detroit, Michigan 48207
(313) 456-4700

**Hillsdale, Jackson, Lenawee, Monroe, and
Washtenaw counties:**

RRD
Jackson District Office
Jackson State Office Building
301 E. Louis Glick Highway
Jackson, Michigan 49201-1556
(517) 780-7690

**Allegan, Berrien, Branch, Calhoun, Cass,
Kalamazoo, St. Joseph, and Van Buren
counties:**

RRD
Kalamazoo District Office
7953 Adobe Road
Kalamazoo, Michigan 490009
(269) 567-3500

TABLE 1

Notice of Mitigation of Contamination
GM SMC
Saginaw, MI

Hazardous Substance	CAS Number	Maximum Concentration (mg/l)	Sample Location for C	Environmental Medium for C	Distance to Property Boundary (ft)	Direction of Migration	Sample Location for I	Boundary Concentration (mg/l)	Environmental Medium for I
Aluminum	7429-90-5T	174	MW-11530	GW	200	NW	MW-00008	0.731	GW
Aluminum	7429-90-5T	174	MW-11530	GW	200	NW	MW-00124	13.2	GW
Aluminum	7429-90-5T	174	MW-11530	GW	200	NW	MW-00208	3.11	GW
Aluminum	7429-90-5T	174	MW-11530	GW	200	NW	MW-00306	2.5	GW
Aluminum	7429-90-5T	174	MW-11530	GW	200	NW	MW-00925	8.67	GW
Aluminum	7429-90-5T	174	MW-11530	GW	200	NW	MW-01223	12.8	GW
Aluminum	7429-90-5T	174	MW-11530	GW	200	NW	MW-01329	1.53	GW
Aluminum	7429-90-5T	174	MW-11530	GW	200	NW	MW-01827	27.3	GW
Aluminum	7429-90-5T	174	MW-11530	GW	200	NW	MW-03623	9.13	GW
Aluminum	7429-90-5T	174	MW-11530	GW	200	NW	MW-03746	17.8	GW
Aluminum	7429-90-5T	174	MW-11530	GW	200	NW	MW-04757	23.3	GW
Aluminum	7429-90-5T	174	MW-11530	GW	200	NW	MW-04854	7.29	GW
Aluminum	7429-90-5T	174	MW-11530	GW	200	NW	MW-07959	6.58	GW
Aluminum	7429-90-5T	174	MW-11530	GW	200	NW	MW-10000	6.07	GW
Aluminum	7429-90-5T	174	MW-11530	GW	200	NW	MW-11530	15.7	GW
Aluminum	7429-90-5T	174	MW-11530	GW	200	NW	MW-11901	2.3	GW
Aluminum	7429-90-5T	174	MW-11530	GW	200	NW	MW-12432	3.05	GW
Aluminum	7429-90-5T	174	MW-11530	GW	200	NW	MW-13205	26.2	GW
Aluminum	7429-90-5T	174	MW-11530	GW	200	NW	MW-16080	26.6	GW
Aluminum	7429-90-5T	174	MW-11530	GW	200	NW	MW-17948	3.06	GW
Aluminum	7429-90-5T	174	MW-11530	GW	200	NW	MW-96080	5.5	GW
Aluminum (Dissolved)	7429-90-5D	4.13	MW-00017	GW	50	NW	MW-00017	4.13	GW
Aluminum (Dissolved)	7429-90-5D	4.13	MW-00017	GW	50	NW	MW-00309	1.07	GW
Aluminum (Dissolved)	7429-90-5D	4.13	MW-00017	GW	50	NW	MW-03240	2.91	GW
Aluminum (Dissolved)	7429-90-5D	4.13	MW-00017	GW	50	NW	MW-04250	1.57	GW
Aluminum (Dissolved)	7429-90-5D	4.13	MW-00017	GW	50	NW	MW-04864	1.4	GW
Ammonia	7664-41-7	29.1	MW-18	GW	1600	NW	MW-07959	20.3	GW
Antimony	7440-36-0T	0.076	MW-04831	GW	1750	NW	MW-00309	0.031	GW
Antimony	7440-36-0T	0.076	MW-04831	GW	1750	NW	MW-00925	0.0225	GW
Antimony	7440-36-0T	0.076	MW-04831	GW	1750	NW	MW-01223	0.0221	GW
Antimony	7440-36-0T	0.076	MW-04831	GW	1750	NW	MW-01827	0.0203	GW
Antimony	7440-36-0T	0.076	MW-04831	GW	1750	NW	MW-03746	0.0204	GW
Antimony	7440-36-0T	0.0346	MW-04831	GW	1750	NW	MW-11530	0.054	GW
Antimony	7440-36-0T	0.076	MW-04831	GW	1750	NW	MW-13205	0.0276	GW
Antimony (Dissolved)	7440-36-0D	0.0346	MW-90124	GW	100	NW	MW-00004	0.0322	GW
Antimony (Dissolved)	7440-36-0D	0.0346	MW-90124	GW	100	NW	MW-00017	0.0225	GW
Antimony (Dissolved)	7440-36-0D	0.0346	MW-90124	GW	100	NW	MW-00124	0.029	GW
Antimony (Dissolved)	7440-36-0D	0.0346	MW-90124	GW	100	NW	MW-03240	0.0284	GW
Antimony (Dissolved)	7440-36-0D	0.0346	MW-90124	GW	100	NW	MW-03623	0.0246	GW
Antimony (Dissolved)	7440-36-0D	0.0346	MW-90124	GW	100	NW	MW-17948	0.0227	GW

TABLE 1
Notice of Mitigation of Contamination
GM SMC
Saginaw, MI

Hazardous Substance	CAS Number	Maximum Concentration (mg/l)	Sample Location for C	Environmental Medium for C	Distance to Property Boundary (ft)	Direction of Migration	Sample Location for I	Boundary Concentration (mg/l)	Environmental Medium for I
Antimony (Dissolved)	7440-36-0D	0.0346	MW-90124	GW	100	NW	MW-90124	0.0346	GW
Aroclor-1254 (PCB-1254)	11097-69-1	0.0009	MW-00306	GW	300	NW	MW-00306	0.00087	GW
Arsenic	7440-38-2T	0.446	MW-01329	GW	50	NW	MW-00124	0.0852	GW
Arsenic	7440-38-2T	0.446	MW-01329	GW	50	NW	MW-01329	0.446	GW
Arsenic	7440-38-2T	0.446	MW-01329	GW	50	NW	MW-01530	0.0852	GW
Arsenic	7440-38-2T	0.446	MW-01329	GW	50	NW	MW-01827	0.0615	GW
Arsenic	7440-38-2T	0.446	MW-01329	GW	50	NW	MW-03240	0.103	GW
Arsenic	7440-38-2T	0.446	MW-01329	GW	50	NW	MW-03623	0.058	GW
Arsenic	7440-38-2T	0.446	MW-01329	GW	50	NW	MW-03746	0.069	GW
Arsenic	7440-38-2T	0.446	MW-01329	GW	50	NW	MW-04864	0.052	GW
Arsenic	7440-38-2T	0.446	MW-01329	GW	50	NW	MW-07959	0.072	GW
Arsenic	7440-38-2T	0.446	MW-01329	GW	50	NW	MW-10000	0.235	GW
Benzo(a)anthracene	56-55-3	12	MW-00305	GW	400	W	MW-00306	0.003	GW
Benzo(a)anthracene	56-55-3	12	MW-00305	GW	400	W	MW-00309	0.003	GW
Benzo(b)fluoranthene	205-99-2	8.6	MW-00305	GW	400	W	MW-00306	0.003	GW
Benzo(b)fluoranthene	205-99-2	8.6	MW-00305	GW	400	W	MW-00309	0.003	GW
Beryllium	7440-41-7T	0.028	MW-03240	GW	50	NW	MW-00309	0.0044	GW
Beryllium	7440-41-7T	0.028	MW-03240	GW	50	NW	MW-03240	0.0195	GW
Beryllium	7440-41-7T	0.028	MW-03240	GW	50	NW	MW-03623	0.006	GW
Beryllium	7440-41-7T	0.028	MW-03240	GW	50	NW	MW-07959	0.006	GW
Beryllium	7440-41-7T	0.028	MW-03240	GW	50	NW	MW-11530	0.01	GW
Cadmium	7440-43-9T	0.0206	MW-00309	GW	350	W	MW-00309	0.0206	GW
Cadmium	7440-43-9T	0.0206	MW-00309	GW	350	W	MW-07959	0.013	GW
Chromium	7440-47-3T	3.9	MW-02410	GW	2700	NW	MW-00017	0.199	GW
Chromium	7440-47-3T	3.9	MW-02410	GW	2700	NW	MW-00309	0.161	GW
Chromium	7440-47-3T	3.9	MW-02410	GW	2700	NW	MW-02432	0.139	GW
Chromium	7440-47-3T	3.9	MW-02410	GW	2700	NW	MW-03240	3.72	GW
Chromium	7440-47-3T	3.9	MW-02410	GW	2700	NW	MW-03623	0.212	GW
Chromium	7440-47-3T	3.9	MW-02410	GW	2700	NW	MW-04250	0.186	GW
Chromium	7440-47-3T	3.9	MW-02410	GW	2700	NW	MW-04757	0.126	GW
Chromium	7440-47-3T	3.9	MW-02410	GW	2700	NW	MW-07959	0.296	GW
Chromium	7440-47-3T	3.9	MW-02410	GW	2700	NW	MW-10000	0.124	GW
Chromium	7440-47-3T	3.9	MW-02410	GW	2700	NW	MW-11530	0.327	GW
Cobalt	7440-48-4T	0.355	MW-03240	GW	50	NW	MW-03240	0.355	GW
Cobalt	7440-48-4T	0.355	MW-03240	GW	50	NW	MW-03623	0.065	GW
Cobalt	7440-48-4T	0.355	MW-03240	GW	50	NW	MW-10000	0.091	GW
Cobalt	7440-48-4T	0.355	MW-03240	GW	50	NW	MW-11530	0.129	GW
Cyanide (total)	57-12-5T	0.42	MW-07959	GW	100	NE	MW-07959	0.21	GW
2,4-Dimethylphenol	105-67-9	0.89	MW-07959	GW	100	NE	MW-07959	0.63	GW
Formaldehyde	50-00-0	1.9	MW-07959	GW	100	NE	MW-07959	1.5	GW

TABLE 1
Notice of Mitigation of Contamination
GM SMC0
Saginaw, MI

Hazardous Substance	CAS Number	Maximum Concentration (mg/l)	Sample Location for C	Environmental Medium for C	Distance to Property Boundary (ft)	Direction of Migration	Sample Location for I	Boundary Concentration (mg/l)	Environmental Medium for I
Iron	7439-89-6T	474	MW-03240	GW	50	NW	MW-02432	95.6	GW
Iron	7439-89-6T	474	MW-03240	GW	50	NW	MW-04250	96.7	GW
Iron	7439-89-6T	474	MW-03240	GW	50	NW	MW-04757	201	GW
Iron	7439-89-6T	474	MW-03240	GW	50	NW	MW-04854	6.57	GW
Iron	7439-89-6T	474	MW-03240	GW	50	NW	MW-04864	8.9	GW
Iron	7439-89-6T	474	MW-03240	GW	50	NW	MW-07959	141	GW
Iron	7439-89-6T	474	MW-03240	GW	50	NW	MW-10000	182	GW
Iron	7439-89-6T	474	MW-03240	GW	50	NW	MW-11901	79.5	GW
Iron	7439-89-6T	474	MW-03240	GW	50	NW	MW-13205	4.07	GW
Iron	7439-89-6T	474	MW-03240	GW	50	NW	MW-16080	17.7	GW
Iron	7439-89-6T	474	MW-03240	GW	50	NW	MW-96080	2.25	GW
Iron	7439-89-6T	474	MW-03240	GW	50	NW	MW-00008	4.1	GW
Iron (Dissolved)	7439-89-6D	102	MW-03240	GW	50	NW	MW-00017	3.5	GW
Iron (Dissolved)	7439-89-6D	102	MW-03240	GW	50	NW	MW-00124	14.6	GW
Iron (Dissolved)	7439-89-6D	102	MW-03240	GW	50	NW	MW-00925	4.85	GW
Iron (Dissolved)	7439-89-6D	102	MW-03240	GW	50	NW	MW-01329	9.71	GW
Iron (Dissolved)	7439-89-6D	102	MW-03240	GW	50	NW	MW-01530	4.57	GW
Iron (Dissolved)	7439-89-6D	102	MW-03240	GW	50	NW	MW-01827	6.15	GW
Iron (Dissolved)	7439-89-6D	102	MW-03240	GW	50	NW	MW-03240	102	GW
Iron (Dissolved)	7439-89-6D	102	MW-03240	GW	50	NW	MW-03746	37.2	GW
Iron (Dissolved)	7439-89-6D	102	MW-03240	GW	50	NW	MW-13623	4.54	GW
Iron (Dissolved)	7439-89-6D	102	MW-03240	GW	50	NW	MW-90124	2.02	GW
Lead	7439-92-1T	3.4	MW-01119	GW	300	NW	MW-00008	0.02	GW
Lead	7439-92-1T	3.4	MW-01119	GW	300	NW	MW-00017	1.78	GW
Lead	7439-92-1T	3.4	MW-01119	GW	300	NW	MW-00124	0.0399	GW
Lead	7439-92-1T	3.4	MW-01119	GW	300	NW	MW-00208	0.0215	GW
Lead	7439-92-1T	3.4	MW-01119	GW	300	NW	MW-00306	0.0866	GW
Lead	7439-92-1T	3.4	MW-01119	GW	300	NW	MW-00925	0.0344	GW
Lead	7439-92-1T	3.4	MW-01119	GW	300	NW	MW-01223	0.146	GW
Lead	7439-92-1T	3.4	MW-01119	GW	300	NW	MW-01329	0.007	GW
Lead	7439-92-1T	3.4	MW-01119	GW	300	NW	MW-01827	0.0726	GW
Lead	7439-92-1T	3.4	MW-01119	GW	300	NW	MW-02432	0.11	GW
Lead	7439-92-1T	3.4	MW-01119	GW	300	NW	MW-03746	0.0415	GW
Lead	7439-92-1T	3.4	MW-01119	GW	300	NW	MW-04250	0.0229	GW
Lead	7439-92-1T	3.4	MW-01119	GW	300	NW	MW-04757	0.126	GW
Lead	7439-92-1T	3.4	MW-01119	GW	300	NW	MW-04854	0.0121	GW
Lead	7439-92-1T	3.4	MW-01119	GW	300	NW	MW-04864	0.0057	GW
Lead	7439-92-1T	3.4	MW-01119	GW	300	NW	MW-07959	0.135	GW
Lead	7439-92-1T	3.4	MW-01119	GW	300	NW	MW-10000	0.007	GW
Lead	7439-92-1T	3.4	MW-01119	GW	300	NW	MW-11530	0.0138	GW

TABLE 1
Notice of Mitigation of Contamination
GM SMCO
Saginaw, MI

Hazardous Substance	CAS Number	Maximum Concentration (mg/l)	Sample Location for C	Environmental Medium for C	Distance to Property Boundary (ft)	Direction of Migration	Sample Location for I	Boundary Concentration (mg/l)	Environmental Medium for I
Lead	7439-92-1T	3.4	MW-01119	GW	300	NW	MW-11901	0.048	GW
Lead	7439-92-1T	3.4	MW-01119	GW	300	NW	MW-13205	0.0241	GW
Lead	7439-92-1T	3.4	MW-01119	GW	300	NW	MW-13623	0.026	GW
Lead	7439-92-1T	3.4	MW-01119	GW	300	NW	MW-16080	0.0265	GW
Lead	7439-92-1T	3.4	MW-01119	GW	300	NW	MW-96080	0.0062	GW
Lead (Dissolved)	7439-92-1D	0.0132	MW-01119	GW	300	NW	MW-00309	0.0113	GW
Lead (Dissolved)	7439-92-1D	0.0132	MW-01119	GW	300	NW	MW-03240	0.0056	GW
Manganese	7439-96-5T	19.1	MW-07959	GW	100	NE	MW-00008	1.15	GW
Manganese	7439-96-5T	19.1	MW-07959	GW	100	NE	MW-00208	0.922	GW
Manganese	7439-96-5T	19.1	MW-07959	GW	100	NE	MW-01223	1.35	GW
Manganese	7439-96-5T	19.1	MW-07959	GW	100	NE	MW-01329	1.03	GW
Manganese	7439-96-5T	19.1	MW-07959	GW	100	NE	MW-01827	2.31	GW
Manganese	7439-96-5T	19.1	MW-07959	GW	100	NE	MW-02432	2.76	GW
Manganese	7439-96-5T	19.1	MW-07959	GW	100	NE	MW-04250	2.78	GW
Manganese	7439-96-5T	19.1	MW-07959	GW	100	NE	MW-04757	1.63	GW
Manganese	7439-96-5T	19.1	MW-07959	GW	100	NE	MW-07959	1.18	GW
Manganese	7439-96-5T	19.1	MW-07959	GW	100	NE	MW-10000	5.42	GW
Manganese	7439-96-5T	19.1	MW-07959	GW	100	NE	MW-11901	1.51	GW
Manganese (Dissolved)	7439-96-5D	5.82	MW-06951	GW	100	NE	MW-13205	1.04	GW
Manganese (Dissolved)	7439-96-5D	5.82	MW-06951	GW	3400	W	MW-00017	1.18	GW
Manganese (Dissolved)	7439-96-5D	5.82	MW-06951	GW	3400	W	MW-00124	1.69	GW
Manganese (Dissolved)	7439-96-5D	5.82	MW-06951	GW	3400	W	MW-00309	1.84	GW
Manganese (Dissolved)	7439-96-5D	5.82	MW-06951	GW	3400	W	MW-00925	1.88	GW
Manganese (Dissolved)	7439-96-5D	5.82	MW-06951	GW	3400	W	MW-01530	2.13	GW
Manganese (Dissolved)	7439-96-5D	5.82	MW-06951	GW	3400	W	MW-03240	3.54	GW
Manganese (Dissolved)	7439-96-5D	5.82	MW-06951	GW	3400	W	MW-03746	1.06	GW
Nickel	7440-02-0T	1.07	MW-03240	GW	3400	W	MW-13623	0.913	GW
Nickel	7440-02-0T	1.07	MW-03240	GW	50	NW	MW-00017	0.219	GW
Nickel	7440-02-0T	1.07	MW-03240	GW	50	NW	MW-00306	0.128	GW
Nickel	7440-02-0T	1.07	MW-03240	GW	50	NW	MW-00309	0.153	GW
Nickel	7440-02-0T	1.07	MW-03240	GW	50	NW	MW-02432	0.103	GW
Nickel	7440-02-0T	1.07	MW-03240	GW	50	NW	MW-03240	1.07	GW
Nickel	7440-02-0T	1.07	MW-03240	GW	50	NW	MW-03623	0.197	GW
Nickel	7440-02-0T	1.07	MW-03240	GW	50	NW	MW-04757	0.106	GW
Nickel	7440-02-0T	1.07	MW-03240	GW	50	NW	MW-10000	0.218	GW
Nickel	7440-02-0T	1.07	MW-03240	GW	50	NW	MW-11530	0.103	GW
Nickel	7440-02-0T	1.07	MW-03240	GW	50	NW	MW-11901	0.133	GW
Pentachlorophenol	87-86-5	0.0063	MW-07959	GW	100	NE	MW-07959	0.0063	GW
Phenol	108-95-2	5.2	MW-07959	GW	100	NE	MW-07959	5.2	GW
Vanadium	7440-62-2T	0.356	MW-11530	GW	200	NW	MW-00008	0.0046	GW

TABLE 1
Notice of Mitigation of Contamination
GM SMC
Saginaw, MI

Hazardous Substance	CAS Number	Maximum Concentration (mg/l)	Sample Location for C	Environmental Medium for C	Distance to Property Boundary (ft)	Direction of Migration	Sample Location for I	Boundary Concentration (mg/l)	Environmental Medium for I
Vanadium	7440-62-2T	0.356	MW-11530	GW	200	NW	MW-00124	0.0405	GW
Vanadium	7440-62-2T	0.356	MW-11530	GW	200	NW	MW-00208	0.0068	GW
Vanadium	7440-62-2T	0.356	MW-11530	GW	200	NW	MW-00925	0.0205	GW
Vanadium	7440-62-2T	0.356	MW-11530	GW	200	NW	MW-01223	0.0278	GW
Vanadium	7440-62-2T	0.356	MW-11530	GW	200	NW	MW-01827	0.0681	GW
Vanadium	7440-62-2T	0.356	MW-11530	GW	200	NW	MW-03746	0.0357	GW
Vanadium	7440-62-2T	0.356	MW-11530	GW	200	NW	MW-04757	0.0363	GW
Vanadium	7440-62-2T	0.356	MW-11530	GW	200	NW	MW-10000	0.0187	GW
Vanadium	7440-62-2T	0.356	MW-11530	GW	200	NW	MW-11901	0.0076	GW
Vanadium	7440-62-2T	0.356	MW-11530	GW	200	NW	MW-12432	0.0083	GW
Vanadium	7440-62-2T	0.356	MW-11530	GW	200	NW	MW-13205	0.0674	GW
Vanadium	7440-62-2T	0.356	MW-11530	GW	200	NW	MW-13623	0.075	GW
Vanadium	7440-62-2T	0.356	MW-11530	GW	200	NW	MW-16080	0.0675	GW
Vanadium	7440-62-2T	0.356	MW-11530	GW	200	NW	MW-17948	0.0091	GW
Vanadium	7440-62-2T	0.356	MW-11530	GW	200	NW	MW-96080	0.0122	GW
Vanadium (Dissolved)	7440-62-2D	0.0328	MW-04864	GW	400	SW	MW-00017	0.0136	GW
Vanadium (Dissolved)	7440-62-2D	0.0328	MW-04864	GW	400	SW	MW-00306	0.0063	GW
Vanadium (Dissolved)	7440-62-2D	0.0328	MW-04864	GW	400	SW	MW-00309	0.0048	GW
Vanadium (Dissolved)	7440-62-2D	0.0328	MW-04864	GW	400	SW	MW-04250	0.0136	GW
Vanadium (Dissolved)	7440-62-2D	0.0328	MW-04864	GW	400	SW	MW-04854	0.0079	GW
Vanadium (Dissolved)	7440-62-2D	0.0328	MW-04864	GW	400	SW	MW-04864	0.0328	GW
Vanadium (Dissolved)	7440-62-2D	0.0328	MW-04864	GW	400	SW	MW-07959	0.0118	GW
Vanadium (Dissolved)	7440-62-2D	0.0328	MW-04864	GW	400	SW	MW-11530	0.0075	GW
Vanadium (Dissolved)	7440-62-2D	0.0328	MW-04864	GW	400	SW	MW-13240	0.0057	GW
Zinc	7440-66-6T	37.1	MW-07959	GW	100	NE	MW-90124	0.00496	GW
Zinc	7440-66-6T	37.1	MW-07959	GW	100	NE	MW-00309	6.42	GW
Zinc	7440-66-6T	37.1	MW-07959	GW	100	NE	MW-03240	3.14	GW
pH	pH	10.42	MW-04864	GW	400	SW	MW-07959	37.1	GW
Total Dissolved Solids (TDS)	TDS	12800	MW-4S	GW	350	S	MW-04864	10.42	GW
							MW-07959	1220	GW

Number	Property Address
1	CROP PRODUCTION SERVICES INC 1753 N 6TH AVE SAGINAW, MI 48601
2	CITY OF SAGINAW 1827 1ST ST SAGINAW, MI 48601
3	LOCAL 666 ES EDUCATION ASSOCIATION 1801 N 6TH AVE SAGINAW, MI 48601
4	L & C INVESTMENTS 1227 N WASHINGTON AVE SAGINAW, MI 48601
5	CSX TRANSPORT 1203 N WASHINGTON AVE SAGINAW, MI 48601
6	WIRT FINANCIAL 2300 VETERANS MEMORIAL PKWY SAGINAW, MI 48602
7	CITY OF SAGINAW SEWAGE DISPOSAL PLANT 2406 VETERANS MEMORIAL PKWY SAGINAW, MI 48601
8	FAIRCHILD, LARRY 1900 N 23RD and just North of 23rd BUENA VISTA TOWNSHIP
9	CITY OF SAGINAW 4006 I-75 BUENA VISTA TOWNSHIP
10	CITY OF SAGINAW 2301 VETERANS MEMORIAL PKWY SAGINAW, MI 48601
11	ADAMS, MARILYN J 4500 CROW ISLAND BUENA VISTA TOWNSHIP
12	HUNDLEY, DON MICHIGAN DEPARTMENT OF TRANSPORTATION VETERANS MEMORIAL PARKWAY SAGINAW, MI

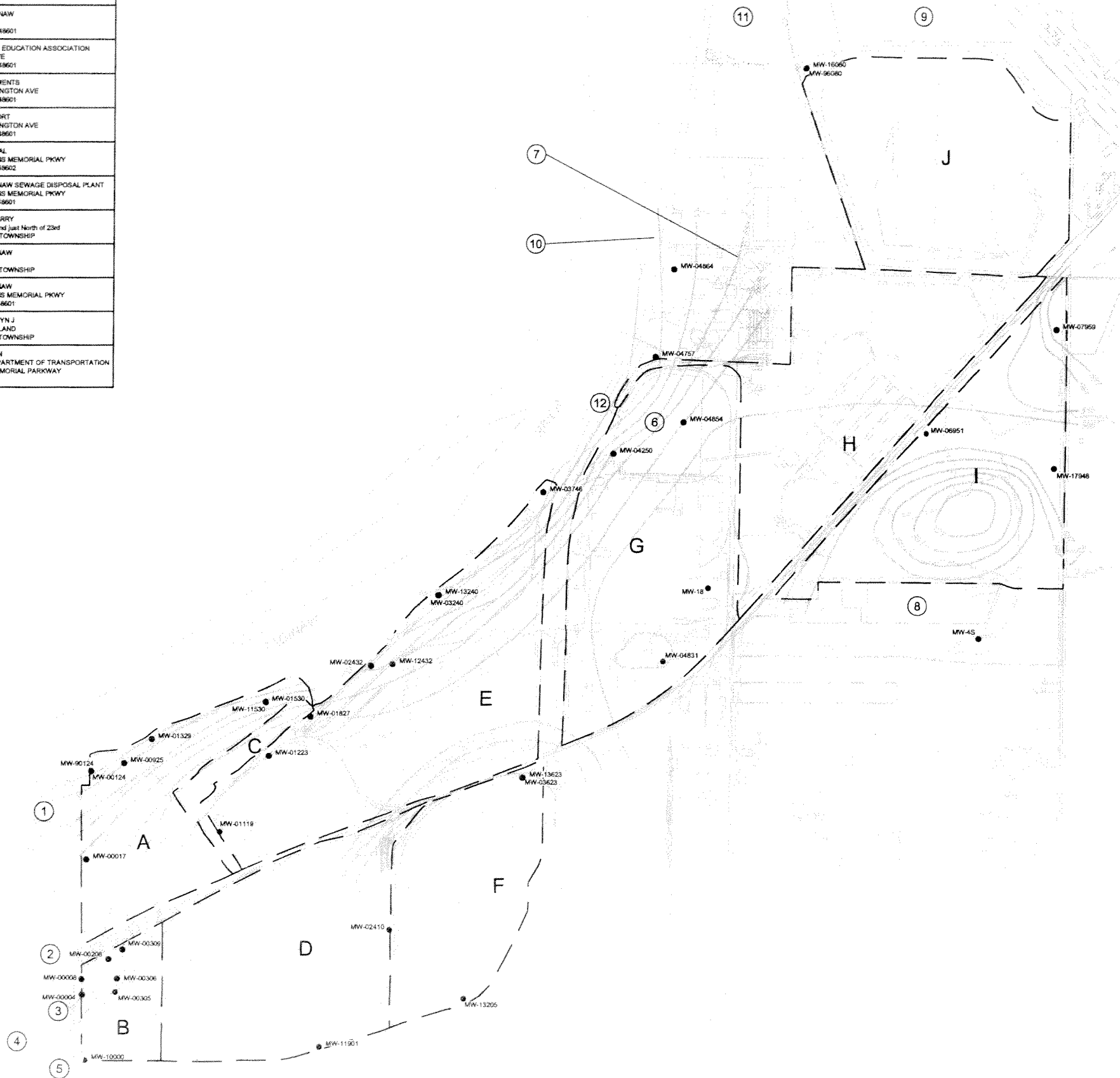

Revision	Date	Initial



0 200 500

LEGEND

- MW-17661 ● EXISTING MONITORING WELLS
- GROUNDWATER ELEVATION FT. AMSL (NAVD 88)

SCALE VERIFICATION

THIS BAR MEASURES 1" ON ORIGINAL. ADJUST SCALE ACCORDINGLY.



Approved

DRAWING STATUS

Status	Date	Initial

GENERAL MOTORS CORPORATION
SAGINAW METAL CASTING OPERATIONS

SAGINAW, MICHIGAN

MONITORING WELL LOCATIONS



CONESTOGA-ROVERS & ASSOCIATES

Source Reference:

MICHIGAN STATE PLANE SOUTH, NAD 83 USING INTERNATIONAL FEET, NGVD 86

Project Manager	Reviewed By	Date	
IR	D D	SEPTEMBER 2003	
Scale	Project No	Report No	Drawing No
1" = 500'	17075-23	FL001	1



**Worldwide Facilities Group
Remediation Team**

September 18, 2003

Owner/Operator
Crop Production Services, Inc.
1753 N 6th Ave.
Saginaw Michigan 48601

Dear Sir/Madam:

General Motors Corporation (GM) is conducting a Resource Conservation and Recovery Act (RCRA) Facility Investigation (RFI) at the Saginaw Metal Casting Operations (SMCO) Facility, in Saginaw, Michigan. As part of the RFI, soil and groundwater samples have been collected on the SMCO Facility property. The RFI is being performed consistent with the Unilateral Administrative Order issued by the United States Environmental Protection Agency (U.S. EPA).

In accordance with Part 201 of Act 451, GM is providing you with notification of the potential for migration of contamination onto your property. Available data collected from monitoring wells located on GM property upgradient of groundwater flow indicates the potential for migration of contamination above Act 451, Part 201 generic residential standards onto your property. Figure 1 presents your property location and associated upgradient monitoring well location(s). Table 1 presents the parameters exceeding generic residential criteria.

GM's Remediation Team believes that the compounds in the groundwater will cause no adverse effect since residents are connected to the city's water supply.

GM is committed to protecting the health and safety of its neighbors.

If you have any questions about the RFI, or if you have a private well, please call Ben Ippolito with GM toll-free at (888) 436-6687.

Sincerely,

A handwritten signature in black ink, appearing to read "Cheryl Hiatt", written over a horizontal line.

Cheryl Hiatt
Senior Environmental Engineer
General Motors Corporation

Enclosure

CC: Edward Peterson, GM
Tony Thrubis, GM

Table 1

Notice of Mitigation of Contamination
GM SMC
Saginaw, MI

<i>Substance</i>	<i>CAS Number</i>	<i>Sample Location</i>	<i>Boundary Concentration (mg/l)</i>	<i>Environmental Medium</i>
Aluminum (Dissolved)	7429-90-5D	MW-00017	4.13	Ground Water
Antimony (Dissolved)	7440-36-0D	MW-00017	0.0225	Ground Water
Chromium	7440-47-3T	MW-00017	0.199	Ground Water
Iron (Dissolved)	7439-89-6D	MW-00017	3.5	Ground Water
Lead	7439-92-1T	MW-00017	1.78	Ground Water
Manganese (Dissolved)	7439-96-5D	MW-00017	1.18	Ground Water
Nickel	7440-02-0T	MW-00017	0.219	Ground Water
Vanadium (Dissolved)	7440-62-2D	MW-00017	0.0136	Ground Water

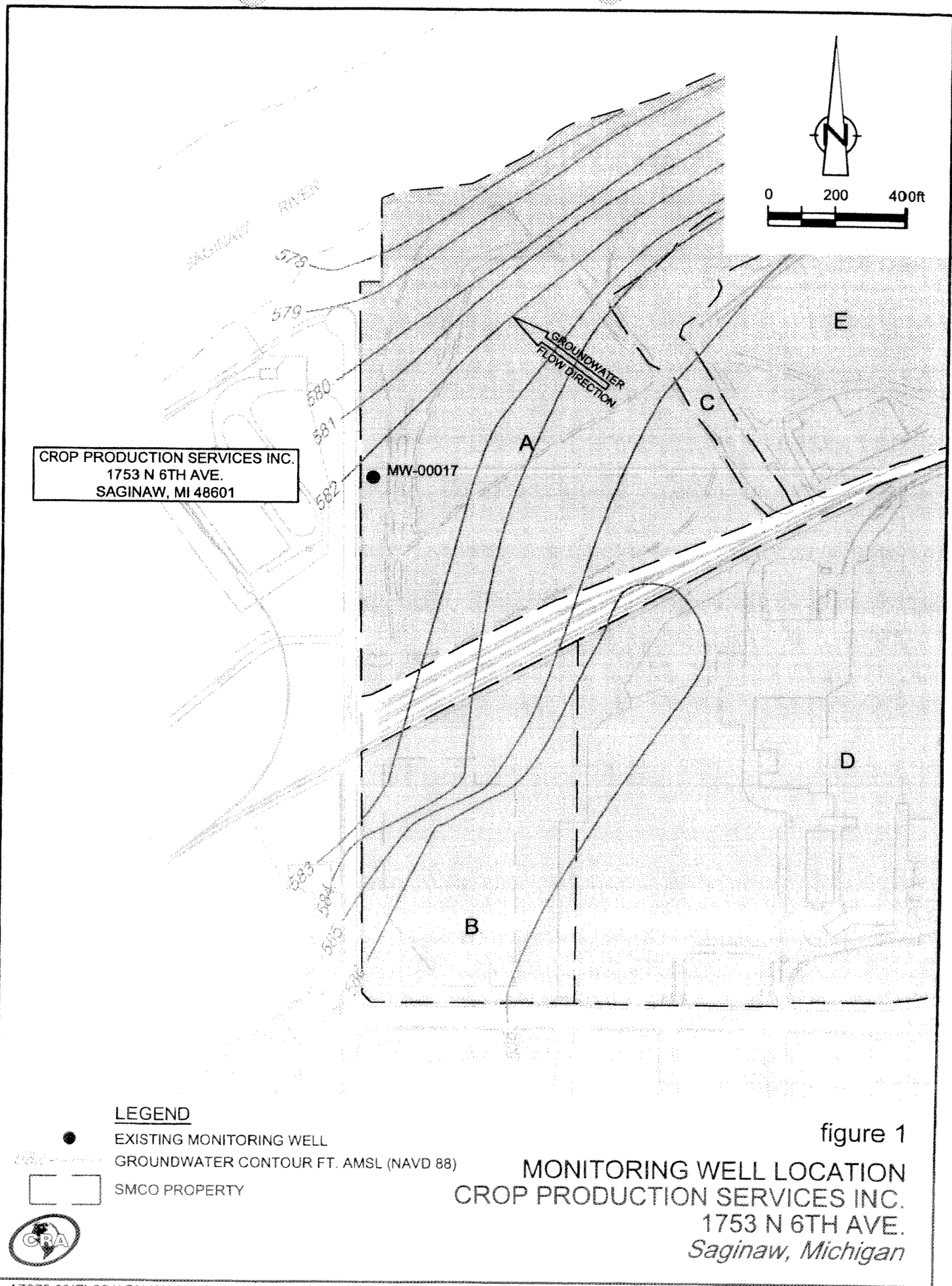



**Worldwide Facilities Group
Remediation Team**

September 18, 2003

Owner/Operator
City of Saginaw
1827 1st St.
Saginaw Michigan 48601

Dear Sir/Madam:

General Motors Corporation (GM) is conducting a Resource Conservation and Recovery Act (RCRA) Facility Investigation (RFI) at the Saginaw Metal Casting Operations (SMCO) Facility, in Saginaw, Michigan. As part of the RFI, soil and groundwater samples have been collected on the SMCO Facility property. The RFI is being performed consistent with the Unilateral Administrative Order issued by the United States Environmental Protection Agency (U.S. EPA).

In accordance with Part 201 of Act 451, GM is providing you with notification of the potential for migration of contamination onto your property. Available data collected from monitoring wells located on GM property upgradient of groundwater flow indicates the potential for migration of contamination above Act 451, Part 201 generic residential standards onto your property. Figure 1 presents your property location and associated upgradient monitoring well location(s). Table 1 presents the parameters exceeding generic residential criteria.

GM's Remediation Team believes that the compounds in the groundwater will cause no adverse effect since residents are connected to the city's water supply.

GM is committed to protecting the health and safety of its neighbors.

If you have any questions about the RFI, or if you have a private well, please call Ben Ippolito with GM toll-free at (888) 436-6687.

Sincerely,

A handwritten signature in black ink, appearing to read "Cheryl Hiatt", written over the typed name.

Cheryl Hiatt
Senior Environmental Engineer
General Motors Corporation

Enclosure

CC: Edward Peterson, GM
Tony Thrubis, GM

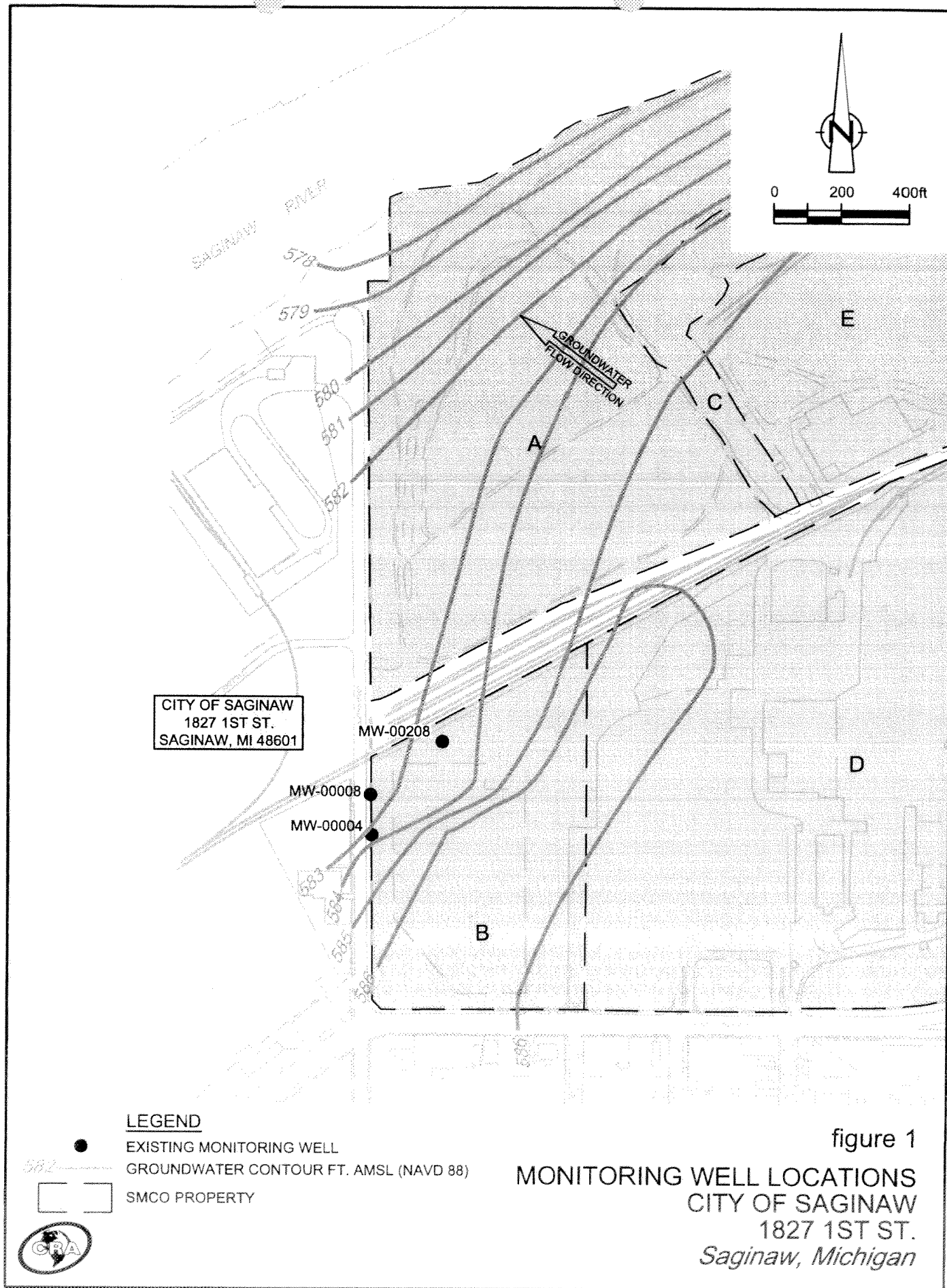

Table 1

Notice of Mitigation of Contamination
GM SMC
Saginaw, MI

<i>Substance</i>	<i>CAS Number</i>	<i>Sample Location</i>	<i>Boundary Concentration (mg/l)</i>	<i>Environmental Medium</i>
Aluminum	7429-90-5T	MW-00208	3.11	Ground Water
Lead	7439-92-1T	MW-00208	0.0215	Ground Water
Manganese	7439-96-5T	MW-00208	0.922	Ground Water
Vanadium	7440-62-2T	MW-00208	0.0068	Ground Water
Aluminum	7429-90-5T	MW-00008	0.731	Ground Water
Iron (Dissolved)	7439-89-6D	MW-00008	4.1	Ground Water
Lead	7439-92-1T	MW-00008	0.02	Ground Water
Manganese	7439-96-5T	MW-00008	1.15	Ground Water
Vanadium	7440-62-2T	MW-00008	0.0046	Ground Water
Antimony (Dissolved)	7440-36-0D	MW-00004	0.0322	Ground Water



**Worldwide Facilities Group
Remediation Team**

September 18, 2003

Owner/Operator
Local 669 ES Education Association
1601 N 6th Ave.
Saginaw Michigan 48601

Dear Sir/Madam:

General Motors Corporation (GM) is conducting a Resource Conservation and Recovery Act (RCRA) Facility Investigation (RFI) at the Saginaw Metal Casting Operations (SMCO) Facility, in Saginaw, Michigan. As part of the RFI, soil and groundwater samples have been collected on the SMCO Facility property. The RFI is being performed consistent with the Unilateral Administrative Order issued by the United States Environmental Protection Agency (U.S. EPA).

In accordance with Part 201 of Act 451, GM is providing you with notification of the potential for migration of contamination onto your property. Available data collected from monitoring wells located on GM property upgradient of groundwater flow indicates the potential for migration of contamination above Act 451, Part 201 generic residential standards onto your property. Figure 1 presents your property location and associated upgradient monitoring well location(s). Table 1 presents the parameters exceeding generic residential criteria.

GM's Remediation Team believes that the compounds in the groundwater will cause no adverse effect since residents are connected to the city's water supply.

GM is committed to protecting the health and safety of its neighbors.

If you have any questions about the RFI, or if you have a private well, please call Ben Ippolito with GM toll-free at (888) 436-6687.

Sincerely,

A handwritten signature in cursive script, appearing to read "Cheryl Hiatt".

Cheryl Hiatt

Enclosure

CC: Edward Peterson, GM
Tony Thrubis, GM

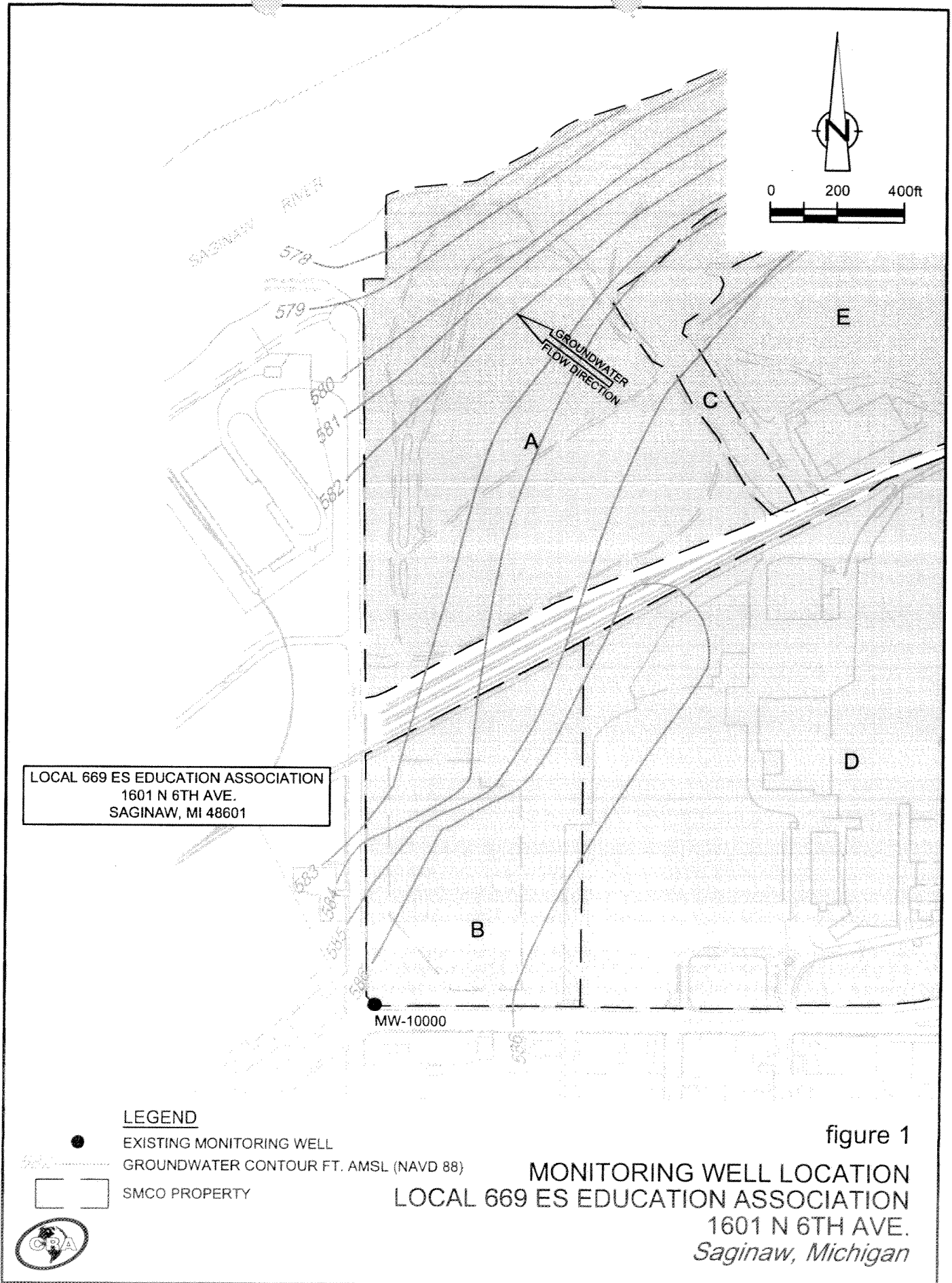

Table 1

Notice of Mitigation of Contamination
GM SMC
Saginaw, MI

<i>Substance</i>	<i>CAS Number</i>	<i>Sample Location</i>	<i>Boundary Concentration (mg/l)</i>	<i>Environmental Medium</i>
Aluminum	7429-90-5T	MW-10000	6.07	Ground Water
Arsenic	7440-38-2T	MW-10000	0.235	Ground Water
Chromium	7440-47-3T	MW-10000	0.124	Ground Water
Cobalt	7440-48-4T	MW-10000	0.091	Ground Water
Iron	7439-89-6T	MW-10000	182	Ground Water
Lead	7439-92-1T	MW-10000	0.007	Ground Water
Manganese	7439-96-5T	MW-10000	5.42	Ground Water
Nickel	7440-02-0T	MW-10000	0.218	Ground Water
Vanadium	7440-62-2T	MW-10000	0.0187	Ground Water



**Worldwide Facilities Group
Remediation Team**

September 18, 2003

Owner/Operator
L & C Investments
1227 N Washington Ave.
Saginaw Michigan 48601

Dear Sir/Madam:

General Motors Corporation (GM) is conducting a Resource Conservation and Recovery Act (RCRA) Facility Investigation (RFI) at the Saginaw Metal Casting Operations (SMCO) Facility, in Saginaw, Michigan. As part of the RFI, soil and groundwater samples have been collected on the SMCO Facility property. The RFI is being performed consistent with the Unilateral Administrative Order issued by the United States Environmental Protection Agency (U.S. EPA).

In accordance with Part 201 of Act 451, GM is providing you with notification of the potential for migration of contamination onto your property. Available data collected from monitoring wells located on GM property upgradient of groundwater flow indicates the potential for migration of contamination above Act 451, Part 201 generic residential standards onto your property. Figure 1 presents your property location and associated upgradient monitoring well location(s). Table 1 presents the parameters exceeding generic residential criteria.

GM's Remediation Team believes that the compounds in the groundwater will cause no adverse effect since residents are connected to the city's water supply.

GM is committed to protecting the health and safety of its neighbors.

If you have any questions about the RFI, or if you have a private well, please call Ben Ippolito with GM toll-free at (888) 436-6687.

Sincerely,

A handwritten signature in black ink, appearing to read "Cheryl Hiatt", written over a horizontal line.

Cheryl Hiatt
Senior Environmental Engineer
General Motors Corporation

Enclosure

CC: Edward Peterson, GM
Tony Thrubis, GM

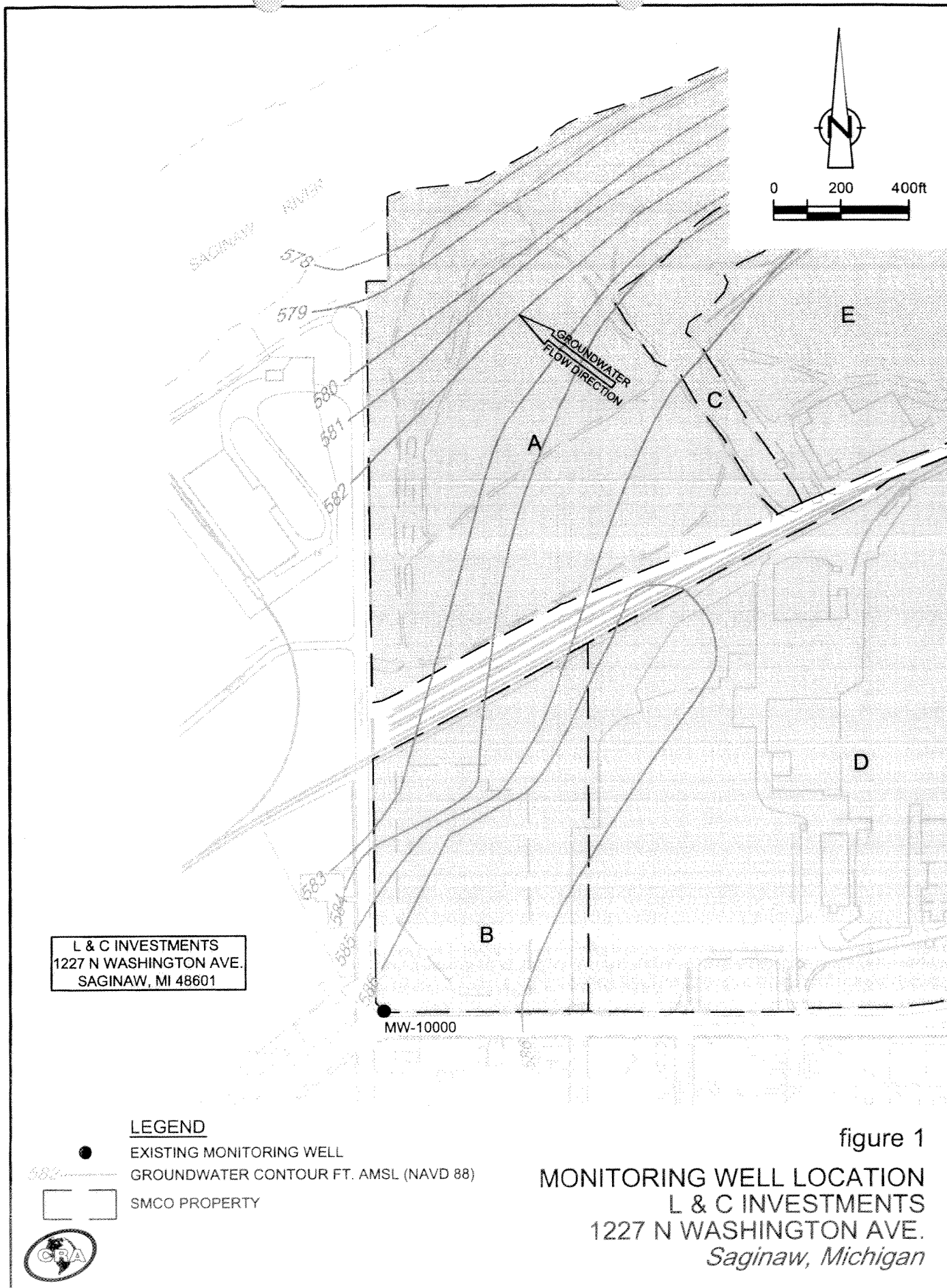

Table 1

Notice of Mitigation of Contamination
GM SMC
Saginaw, MI

<i>Substance</i>	<i>CAS Number</i>	<i>Sample Location</i>	<i>Boundary Concentration (mg/l)</i>	<i>Environmental Medium</i>
Aluminum	7429-90-5T	MW-10000	6.07	Ground Water
Arsenic	7440-38-2T	MW-10000	0.235	Ground Water
Chromium	7440-47-3T	MW-10000	0.124	Ground Water
Cobalt	7440-48-4T	MW-10000	0.091	Ground Water
Iron	7439-89-6T	MW-10000	182	Ground Water
Lead	7439-92-1T	MW-10000	0.007	Ground Water
Manganese	7439-96-5T	MW-10000	5.42	Ground Water
Nickel	7440-02-0T	MW-10000	0.218	Ground Water
Vanadium	7440-62-2T	MW-10000	0.0187	Ground Water



**Worldwide Facilities Group
Remediation Team**

September 18, 2003

Owner/Operator
CSX Transport
1203 N Washington Ave.
Saginaw Michigan 48601

Dear Sir/Madam:

General Motors Corporation (GM) is conducting a Resource Conservation and Recovery Act (RCRA) Facility Investigation (RFI) at the Saginaw Metal Casting Operations (SMCO) Facility, in Saginaw, Michigan. As part of the RFI, soil and groundwater samples have been collected on the SMCO Facility property. The RFI is being performed consistent with the Unilateral Administrative Order issued by the United States Environmental Protection Agency (U.S. EPA).

In accordance with Part 201 of Act 451, GM is providing you with notification of the potential for migration of contamination onto your property. Available data collected from monitoring wells located on GM property upgradient of groundwater flow indicates the potential for migration of contamination above Act 451, Part 201 generic residential standards onto your property. Figure 1 presents your property location and associated upgradient monitoring well location(s). Table 1 presents the parameters exceeding generic residential criteria.

GM's Remediation Team believes that the compounds in the groundwater will cause no adverse effect since residents are connected to the city's water supply.

GM is committed to protecting the health and safety of its neighbors.

If you have any questions about the RFI, or if you have a private well, please call Ben Ippolito with GM toll-free at (888) 436-6687.

Sincerely,

A handwritten signature in black ink, appearing to read "Cheryl Hiatt".

Cheryl Hiatt
Senior Environmental Engineer
General Motors Corporation

Enclosure

CC: Edward Peterson, GM
Tony Thrubis, GM

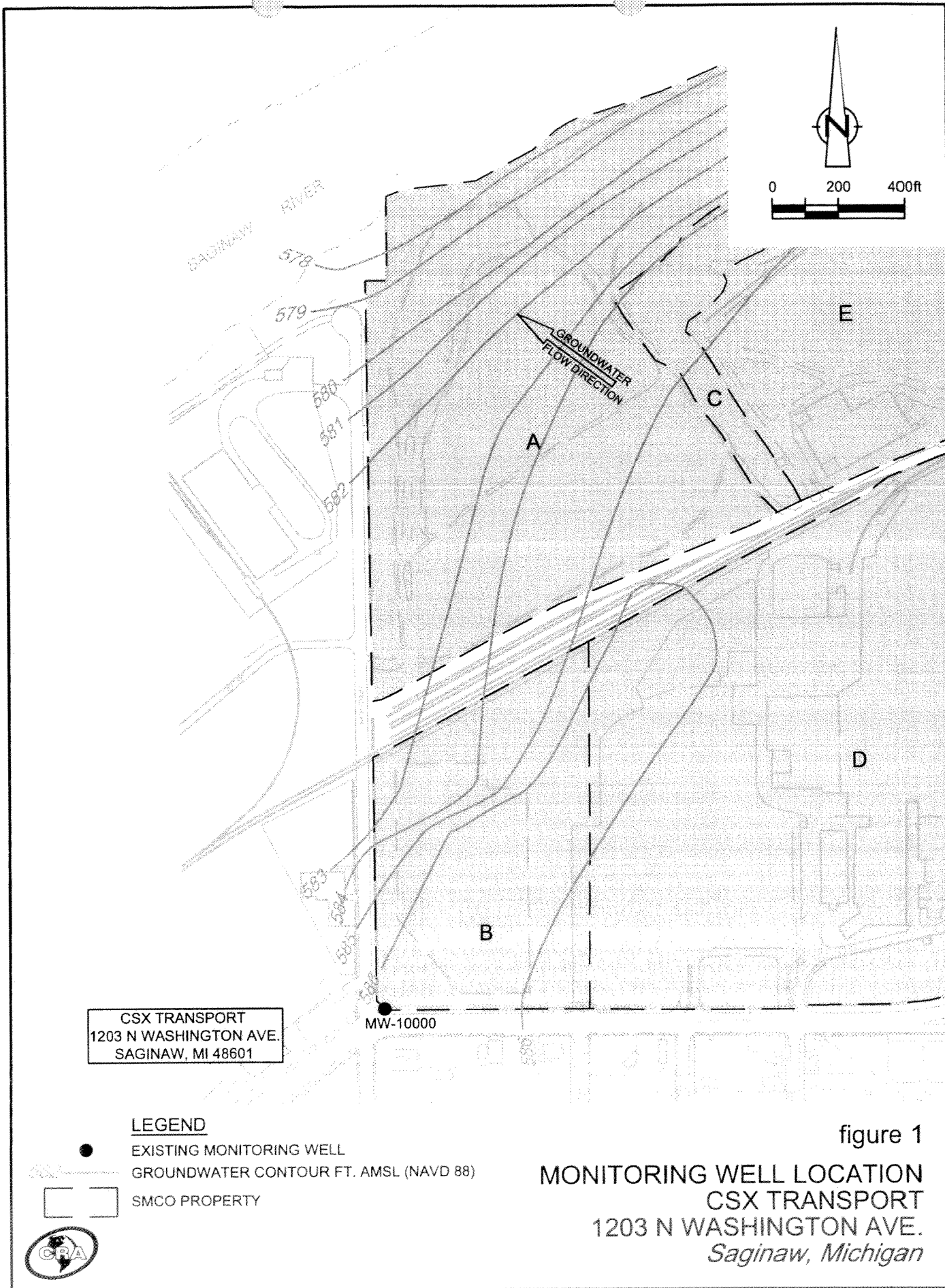

Table 1

Notice of Mitigation of Contamination
GM SMC
Saginaw, MI

<i>Substance</i>	<i>CAS Number</i>	<i>Sample Location</i>	<i>Boundary Concentration (mg/l)</i>	<i>Environmental Medium</i>
Aluminum	7429-90-5T	MW-10000	6.07	Ground Water
Arsenic	7440-38-2T	MW-10000	0.235	Ground Water
Chromium	7440-47-3T	MW-10000	0.124	Ground Water
Cobalt	7440-48-4T	MW-10000	0.091	Ground Water
Iron	7439-89-6T	MW-10000	182	Ground Water
Lead	7439-92-1T	MW-10000	0.007	Ground Water
Manganese	7439-96-5T	MW-10000	5.42	Ground Water
Nickel	7440-02-0T	MW-10000	0.218	Ground Water
Vanadium	7440-62-2T	MW-10000	0.0187	Ground Water



**Worldwide Facilities Group
Remediation Team**

September 18, 2003

Owner/Operator
City of Saginaw Sewage Disposal Plant
2406 Veterans Memorial Pkwy
Saginaw Michigan 48601

Dear Sir/Madam:

General Motors Corporation (GM) is conducting a Resource Conservation and Recovery Act (RCRA) Facility Investigation (RFI) at the Saginaw Metal Casting Operations (SMCO) Facility, in Saginaw, Michigan. As part of the RFI, soil and groundwater samples have been collected on the SMCO Facility property. The RFI is being performed consistent with the Unilateral Administrative Order issued by the United States Environmental Protection Agency (U.S. EPA).

In accordance with Part 201 of Act 451, GM is providing you with notification of the potential for migration of contamination onto your property. Available data collected from monitoring wells located on GM property upgradient of groundwater flow indicates the potential for migration of contamination above Act 451, Part 201 generic residential standards onto your property. Figure 1 presents your property location and associated upgradient monitoring well location(s). Table 1 presents the parameters exceeding generic residential criteria.

GM's Remediation Team believes that the compounds in the groundwater will cause no adverse effect since residents are connected to the city's water supply.

GM is committed to protecting the health and safety of its neighbors.

If you have any questions about the RFI, or if you have a private well, please call Ben Ippolito with GM toll-free at (888) 436-6687.

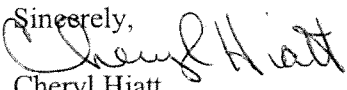
Sincerely,

Cheryl Hiatt
Senior Environmental Engineer
General Motors Corporation

Enclosure

CC: Edward Peterson, GM
Tony Thrubis, GM

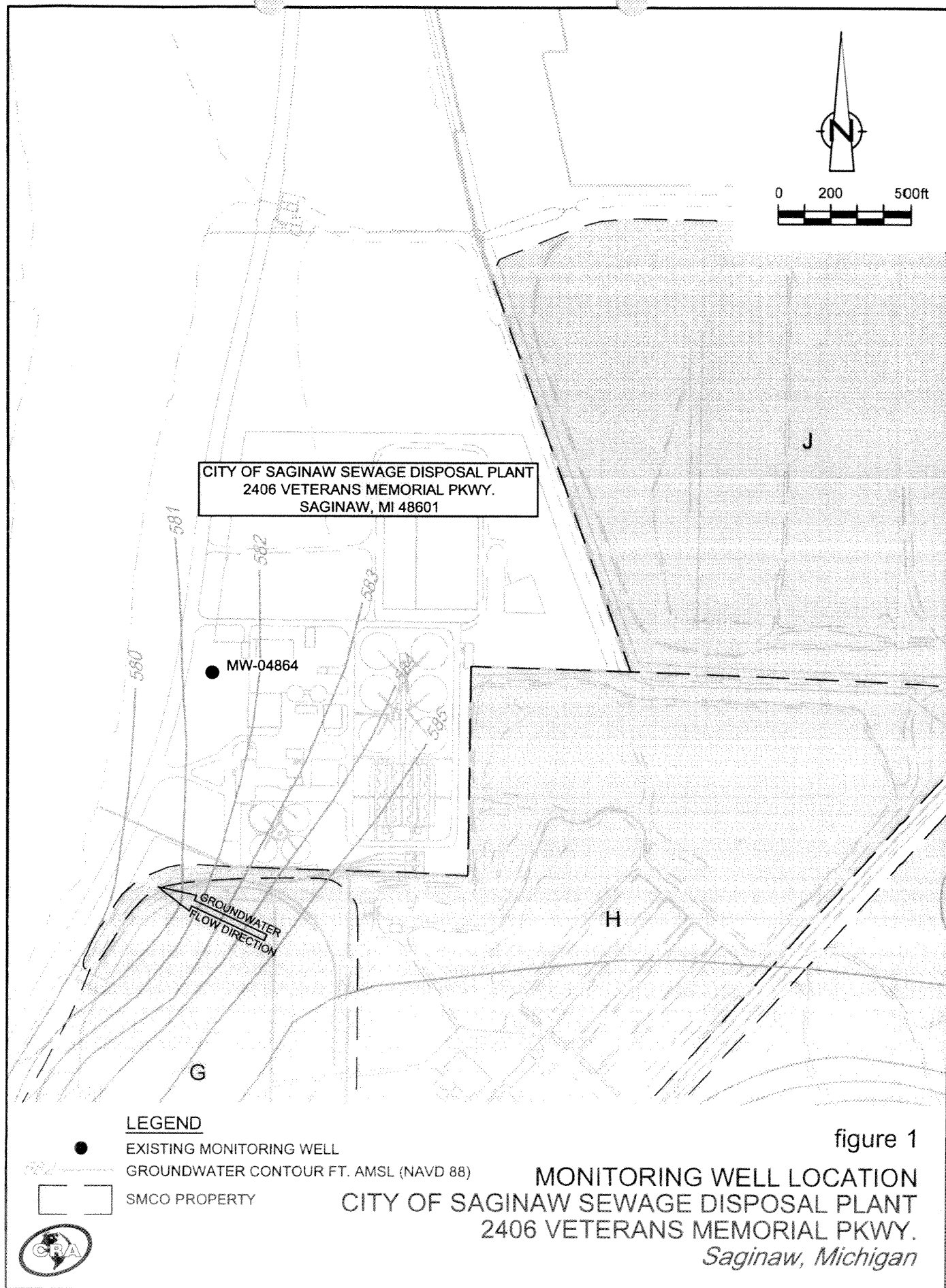

Table 1

Notice of Mitigation of Contamination
GM SMC
Saginaw, MI

<i>Substance</i>	<i>CAS Number</i>	<i>Sample Location</i>	<i>Boundary Concentration (mg/l)</i>	<i>Environmental Medium</i>
Aluminum (Dissolved)	7429-90-5D	MW-04864	1.4	Ground Water
Arsenic	7440-38-2T	MW-04864	0.052	Ground Water
Iron	7439-89-6T	MW-04864	8.9	Ground Water
Lead	7439-92-1T	MW-04864	0.0057	Ground Water
Vanadium (Dissolved)	7440-62-2D	MW-04864	0.0328	Ground Water
pH	pH	MW-04864	10.42	Ground Water



**Worldwide Facilities Group
Remediation Team**

September 18, 2003

Mr. Larry Fairchild
1900 N 23rd
Buena Vista Township
Saginaw Michigan 48601

Dear Mr. Fairchild:

General Motors Corporation (GM) is conducting a Resource Conservation and Recovery Act (RCRA) Facility Investigation (RFI) at the Saginaw Metal Casting Operations (SMCO) Facility, in Saginaw, Michigan. As part of the RFI, soil and groundwater samples have been collected on the SMCO Facility property. The RFI is being performed consistent with the Unilateral Administrative Order issued by the United States Environmental Protection Agency (U.S. EPA).

In accordance with Part 201 of Act 451, GM is providing you with notification of the potential for migration of contamination onto your property. Available data collected from monitoring wells located on GM property upgradient of groundwater flow indicates the potential for migration of contamination above Act 451, Part 201 generic residential standards onto your property. Figure 1 presents your property location and associated upgradient monitoring well location(s). Table 1 presents the parameters exceeding generic residential criteria.

GM's Remediation Team believes that the compounds in the groundwater will cause no adverse effect since residents are connected to the city's water supply.

GM is committed to protecting the health and safety of its neighbors.

If you have any questions about the RFI, or if you have a private well, please call Ben Ippolito with GM toll-free at (888) 436-6687.

Sincerely,

A handwritten signature in black ink, appearing to read "Cheryl Hiatt", written over a horizontal line.

Cheryl Hiatt
Senior Environmental Engineer
General Motors Corporation

Enclosure

CC: Edward Peterson, GM
Tony Thrubis, GM

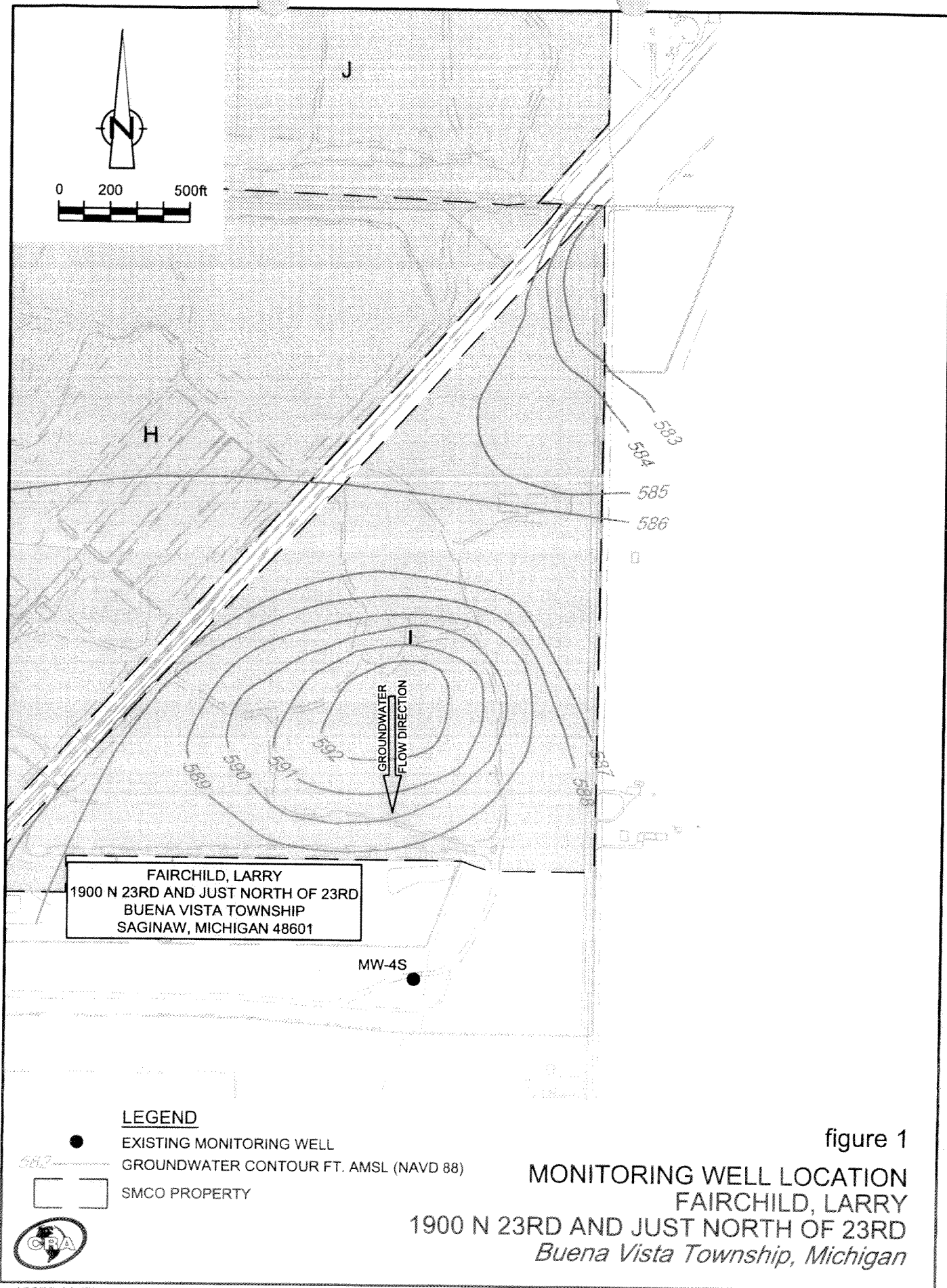

Table 1

Notice of Mitigation of Contamination
GM SMC
Saginaw, MI

<i>Substance</i>	<i>CAS Number</i>	<i>Sample Location</i>	<i>Boundary Concentration (mg/l)</i>	<i>Environmental Medium</i>
Total Dissolved Solids (TDS)	TDS	MW-4S	1220	Ground Water



**Worldwide Facilities Group
Remediation Team**

September 18, 2003

Mr. Wirt
Wirt Financial
909 Washington Avenue
Bay City, MI 48708

Dear Mr. Wirt:

General Motors Corporation (GM) is conducting a Resource Conservation and Recovery Act (RCRA) Facility Investigation (RFI) at the Saginaw Metal Casting Operations (SMCO) Facility, in Saginaw, Michigan. As part of the RFI, soil and groundwater samples have been collected on the SMCO Facility property. The RFI is being performed consistent with the Unilateral Administrative Order issued by the United States Environmental Protection Agency (U.S. EPA).

In accordance with Part 201 of Act 451, GM is providing you with notification of the potential for migration of contamination onto your property located at 2300 Veteran's Memorial Parkway, adjacent to GM's SMCO Facility. Available data collected from monitoring wells located on GM property upgradient of groundwater flow indicates the potential for migration of contamination above Act 451, Part 201 generic residential standards onto your property. Figure 1 presents your property location and associated upgradient monitoring well location(s). Table 1 presents the parameters exceeding generic residential criteria.

GM's Remediation Team believes that the compounds in the groundwater will cause no adverse effect since residents are connected to the city's water supply.

GM is committed to protecting the health and safety of its neighbors. If you have any questions about the RFI, or if you have a private well, please call Ben Ippolito with GM toll-free at (888) 436-6687.

Sincerely,

A handwritten signature in black ink, appearing to read "Cheryl Hiatt", written over the printed name.

Cheryl Hiatt
Senior Environmental Engineer
General Motors Corporation

Enclosure

Cc: Edward Peterson, GM
Tony Thrubis, GM

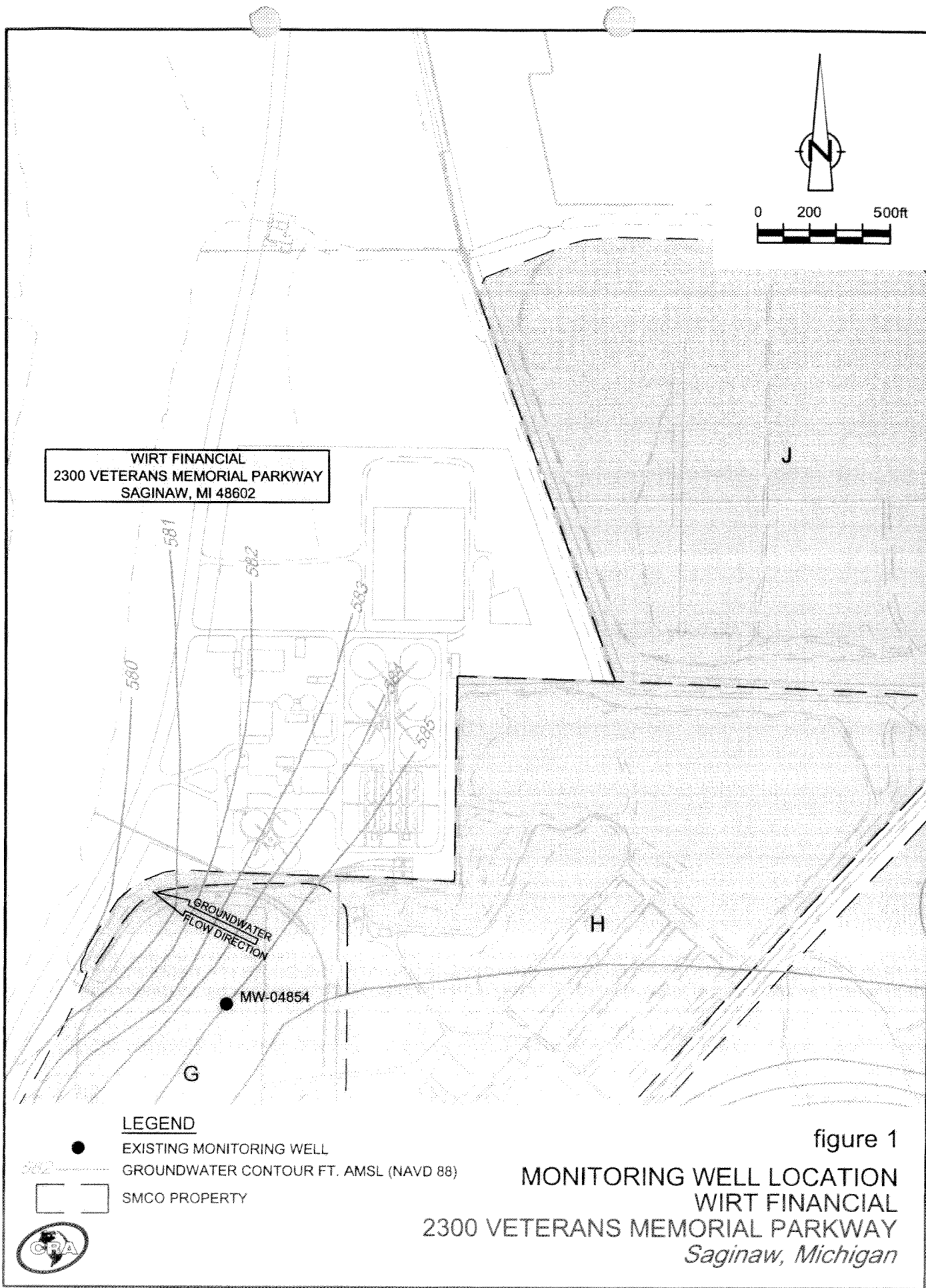

Table 1

Notice of Mitigation of Contamination
GM SMC
Saginaw, MI

<i>Substance</i>	<i>CAS Number</i>	<i>Sample Location</i>	<i>Boundary Concentration (mg/l)</i>	<i>Environmental Medium</i>
Aluminum	7429-90-5T	MW-04854	7.29	Ground Water
Iron	7439-89-6T	MW-04854	6.57	Ground Water
Lead	7439-92-1T	MW-04854	0.0121	Ground Water
Vanadium (Dissolved)	7440-62-2D	MW-04854	0.0079	Ground Water



**Worldwide Facilities Group
Remediation Team**

September 18, 2003

City Hall
Deborah Kimble, City Manager
1315 S. Washington Ave.
Saginaw, Michigan 48601

Dear Ms. Kimble:

General Motors Corporation (GM) is conducting a Resource Conservation and Recovery Act (RCRA) Facility Investigation (RFI) at the Saginaw Metal Casting Operations (SMCO) Facility, in Saginaw, Michigan. As part of the RFI, soil and groundwater samples have been collected on the SMCO Facility property. The RFI is being performed consistent with the Unilateral Administrative Order issued by the United States Environmental Protection Agency (U.S. EPA).

In accordance with Part 201 of Act 451, GM is providing you with notification of the potential for migration of contamination onto your property located at exit 153 on I-75, adjacent to GMs SMCO Facility. Available data collected from monitoring wells located on GM property upgradient of groundwater flow indicates the potential for migration of contamination above Act 451, Part 201 generic residential standards onto your property. Figure 1 presents your property location and associated upgradient monitoring well location(s). Table 1 presents the parameters exceeding generic residential criteria.

GM's Remediation Team believes that the compounds in the groundwater will cause no adverse effect since residents are connected to the city's water supply.

GM is committed to protecting the health and safety of its neighbors. If you have any questions about the RFI, or if you have a private well, please call Ben Ippolito with GM toll-free at (888) 436-6687.

Sincerely,

A handwritten signature in black ink, appearing to read "Cheryl Hiatt", written over the word "Sincerely,".

Cheryl Hiatt
Senior Environmental Engineer
General Motors Corporation

Enclosure

CC: Edward Peterson, GM
Tony Thrubis, GM

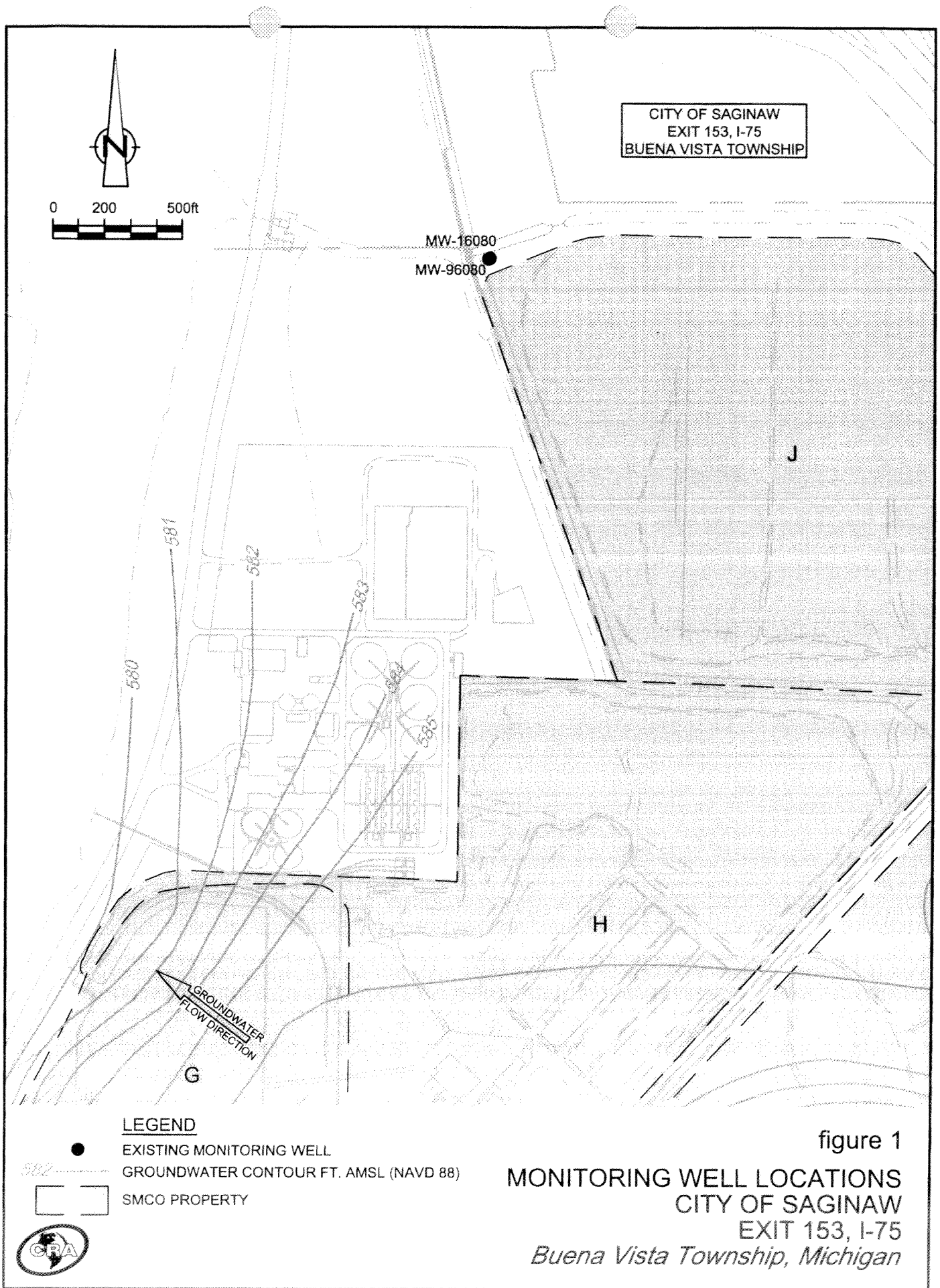

Table 1

Notice of Mitigation of Contamination
GM SMC
Saginaw, MI

<i>Substance</i>	<i>CAS Number</i>	<i>Sample Location</i>	<i>Boundary Concentration (mg/l)</i>	<i>Environmental Medium</i>
Aluminum	7429-90-5T	MW-16080	26.6	Ground Water
Iron	7439-89-6T	MW-16080	17.7	Ground Water
Lead	7439-92-1T	MW-16080	0.0265	Ground Water
Vanadium	7440-62-2T	MW-16080	0.0675	Ground Water
Aluminum	7429-90-5T	MW-96080	5.5	Ground Water
Iron	7439-89-6T	MW-96080	2.25	Ground Water
Lead	7439-92-1T	MW-96080	0.0062	Ground Water
Vanadium	7440-62-2T	MW-96080	0.0122	Ground Water



**Worldwide Facilities Group
Remediation Team**

September 18, 2003

Owner/Operator
City of Saginaw
2301 Veterans Memorial Pkwy
Saginaw Michigan 48601

Dear Sir/Madam:

General Motors Corporation (GM) is conducting a Resource Conservation and Recovery Act (RCRA) Facility Investigation (RFI) at the Saginaw Metal Casting Operations (SMCO) Facility, in Saginaw, Michigan. As part of the RFI, soil and groundwater samples have been collected on the SMCO Facility property. The RFI is being performed consistent with the Unilateral Administrative Order issued by the United States Environmental Protection Agency (U.S. EPA).

In accordance with Part 201 of Act 451, GM is providing you with notification of the potential for migration of contamination onto your property. Available data collected from monitoring wells located on GM property upgradient of groundwater flow indicates the potential for migration of contamination above Act 451, Part 201 generic residential standards onto your property. Figure 1 presents your property location and associated upgradient monitoring well location(s). Table 1 presents the parameters exceeding generic residential criteria.

GM's Remediation Team believes that the compounds in the groundwater will cause no adverse effect since residents are connected to the city's water supply.

GM is committed to protecting the health and safety of its neighbors.

If you have any questions about the RFI, or if you have a private well, please call Ben Ippolito with GM toll-free at (888) 436-6687.

Sincerely,

A handwritten signature in black ink, appearing to read "Cheryl Hiatt", written over a horizontal line.

Cheryl Hiatt
Senior Environmental Engineer
General Motors Corporation

Enclosure

CC: Edward Peterson, GM
Tony Thrubis, GM

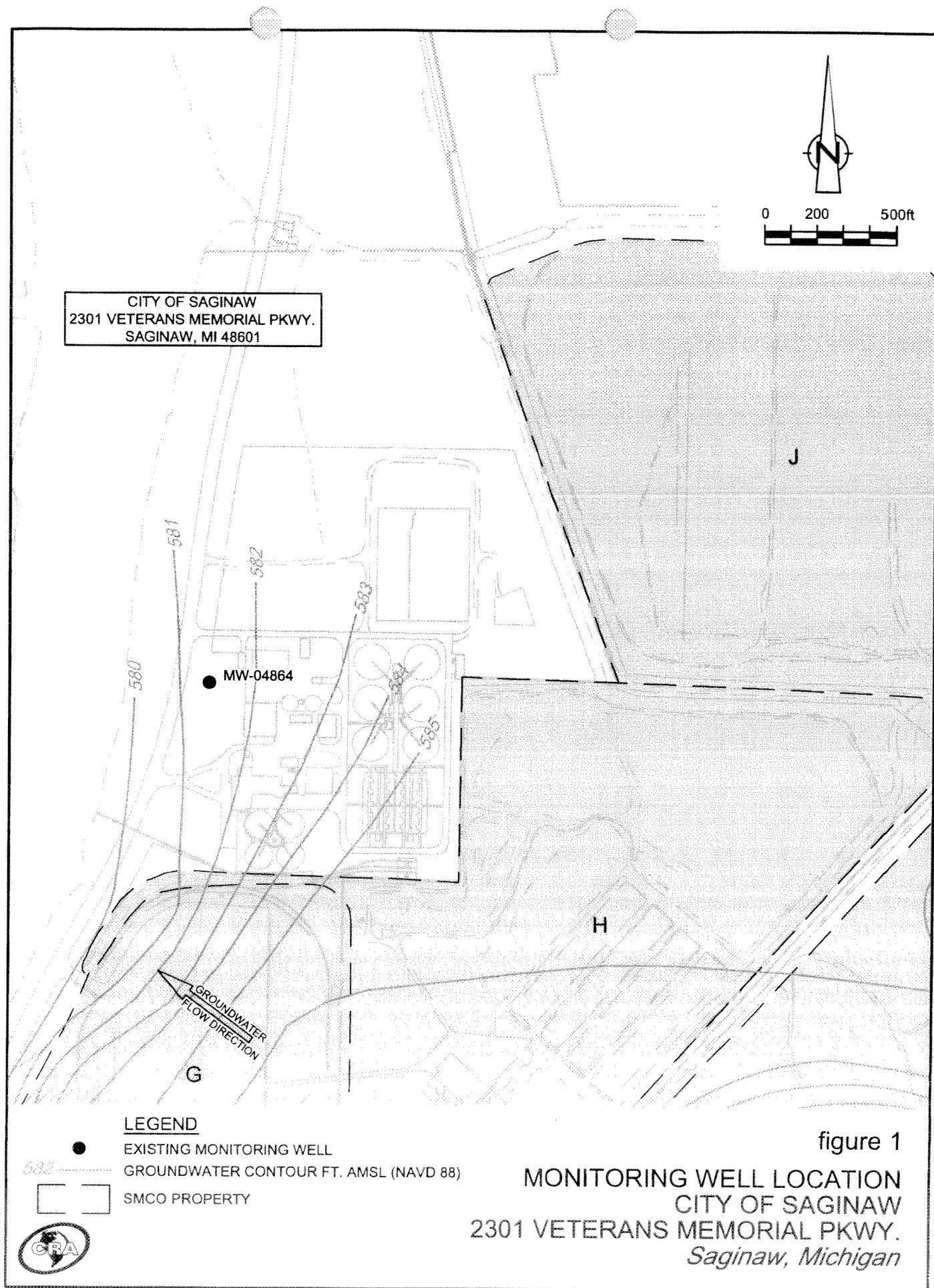

Table 1

Notice of Mitigation of Contamination
GM SMC
Saginaw, MI

<i>Substance</i>	<i>CAS Number</i>	<i>Sample Location</i>	<i>Boundary Concentration (mg/l)</i>	<i>Environmental Medium</i>
Aluminum (Dissolved)	7429-90-5D	MW-04864	1.4	Ground Water
Arsenic	7440-38-2T	MW-04864	0.052	Ground Water
Iron	7439-89-6T	MW-04864	8.9	Ground Water
Lead	7439-92-1T	MW-04864	0.0057	Ground Water
Vanadium (Dissolved)	7440-62-2D	MW-04864	0.0328	Ground Water
pH	pH	MW-04864	10.42	Ground Water



**Worldwide Facilities Group
Remediation Team**

September 18, 2003

Ms. Marilyn J. Adams
4500 Crow Island Rd.
Buena Vista Township
Saginaw Michigan 48601

Dear Ms. Adams:

General Motors Corporation (GM) is conducting a Resource Conservation and Recovery Act (RCRA) Facility Investigation (RFI) at the Saginaw Metal Casting Operations (SMCO) Facility, in Saginaw, Michigan. As part of the RFI, soil and groundwater samples have been collected on the SMCO Facility property. The RFI is being performed consistent with the Unilateral Administrative Order issued by the United States Environmental Protection Agency (U.S. EPA).

In accordance with Part 201 of Act 451, GM is providing you with notification of the potential for migration of contamination onto your property. Available data collected from monitoring wells located on GM property upgradient of groundwater flow indicates the potential for migration of contamination above Act 451, Part 201 generic residential standards onto your property. Figure 1 presents your property location and associated upgradient monitoring well location(s). Table 1 presents the parameters exceeding generic residential criteria.

GM's Remediation Team believes that the compounds in the groundwater will cause no adverse effect since residents are connected to the city's water supply.

GM is committed to protecting the health and safety of its neighbors.

If you have any questions about the RFI, or if you have a private well, please call Ben Ippolito with GM toll-free at (888) 436-6687.

Sincerely,

A handwritten signature in black ink, appearing to read "Cheryl Hiatt", written over a horizontal line.

Cheryl Hiatt
Senior Environmental Engineer
General Motors Corporation

Enclosure

CC: Edward Peterson, GM
Tony Thrubis, GM

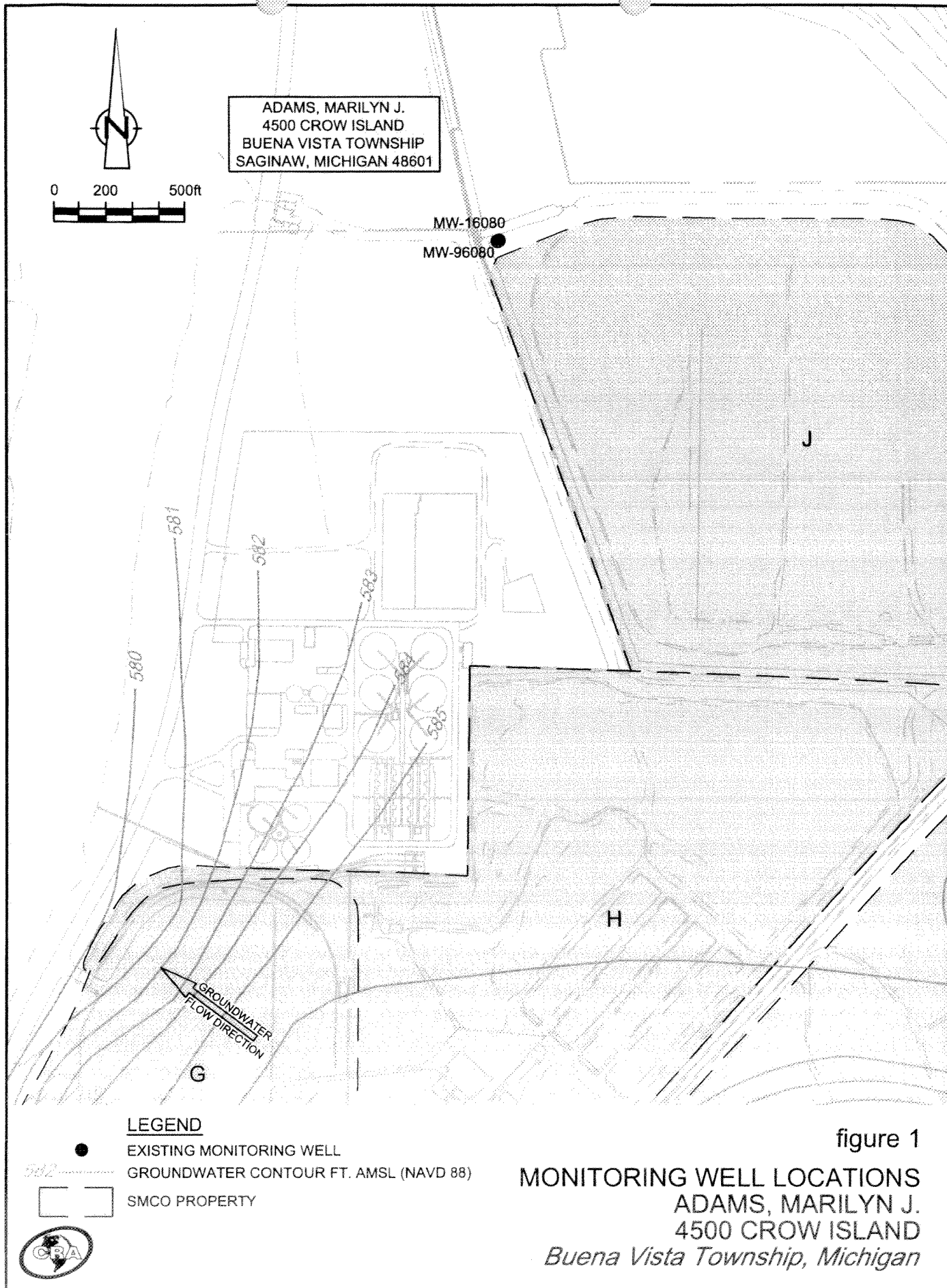

Table 1

Notice of Mitigation of Contamination
GM SMC
Saginaw, MI

<i>Substance</i>	<i>CAS Number</i>	<i>Sample Location</i>	<i>Boundary Concentration (mg/l)</i>	<i>Environmental Medium</i>
Aluminum	7429-90-5T	MW-16080	26.6	Ground Water
Iron	7439-89-6T	MW-16080	17.7	Ground Water
Lead	7439-92-1T	MW-16080	0.0265	Ground Water
Vanadium	7440-62-2T	MW-16080	0.0675	Ground Water
Aluminum	7429-90-5T	MW-96080	5.5	Ground Water
Iron	7439-89-6T	MW-96080	2.25	Ground Water
Lead	7439-92-1T	MW-96080	0.0062	Ground Water
Vanadium	7440-62-2T	MW-96080	0.0122	Ground Water



**Worldwide Facilities Group
Remediation Team**

September 18, 2003

Mr. Don Hundley
Michigan Department of Transportation (MDOT)
2590 East Wilder Rd.
Bay City, MI 48706

Dear Mr. Hundley:

General Motors Corporation (GM) is conducting a Resource Conservation and Recovery Act (RCRA) Facility Investigation (RFI) at the Saginaw Metal Casting Operations (SMCO) Facility, in Saginaw, Michigan. As part of the RFI, soil and groundwater samples have been collected on the SMCO Facility property. The RFI is being performed consistent with the Unilateral Administrative Order issued by the United States Environmental Protection Agency (U.S. EPA).

In accordance with Part 201 of Act 451, GM is providing you with notification of the potential for migration of contamination onto Veterans Memorial Parkway, located adjacent to GMs SMCO Facility. Available data collected from monitoring wells located on GM property upgradient of groundwater flow indicates the potential for migration of contamination above Act 451, Part 201 generic residential standards onto your property. Figure 1 presents your property location and associated upgradient monitoring well location(s). Table 1 presents the parameters exceeding generic residential criteria.

GM's Remediation Team believes that the compounds in the groundwater will cause no adverse effect since residents are connected to the city's water supply.

GM is committed to protecting the health and safety of its neighbors. If you have any questions about the RFI, or if you have a private well, please call Ben Ippolito with GM toll-free at (888) 436-6687.

Sincerely,

A handwritten signature in black ink, appearing to read "Cheryl Hiatt", written over the printed name.

Cheryl Hiatt
Senior Environmental Engineer
General Motors Corporation

Enclosure

CC: Edward Peterson, GM
Tony Thrubis, GM

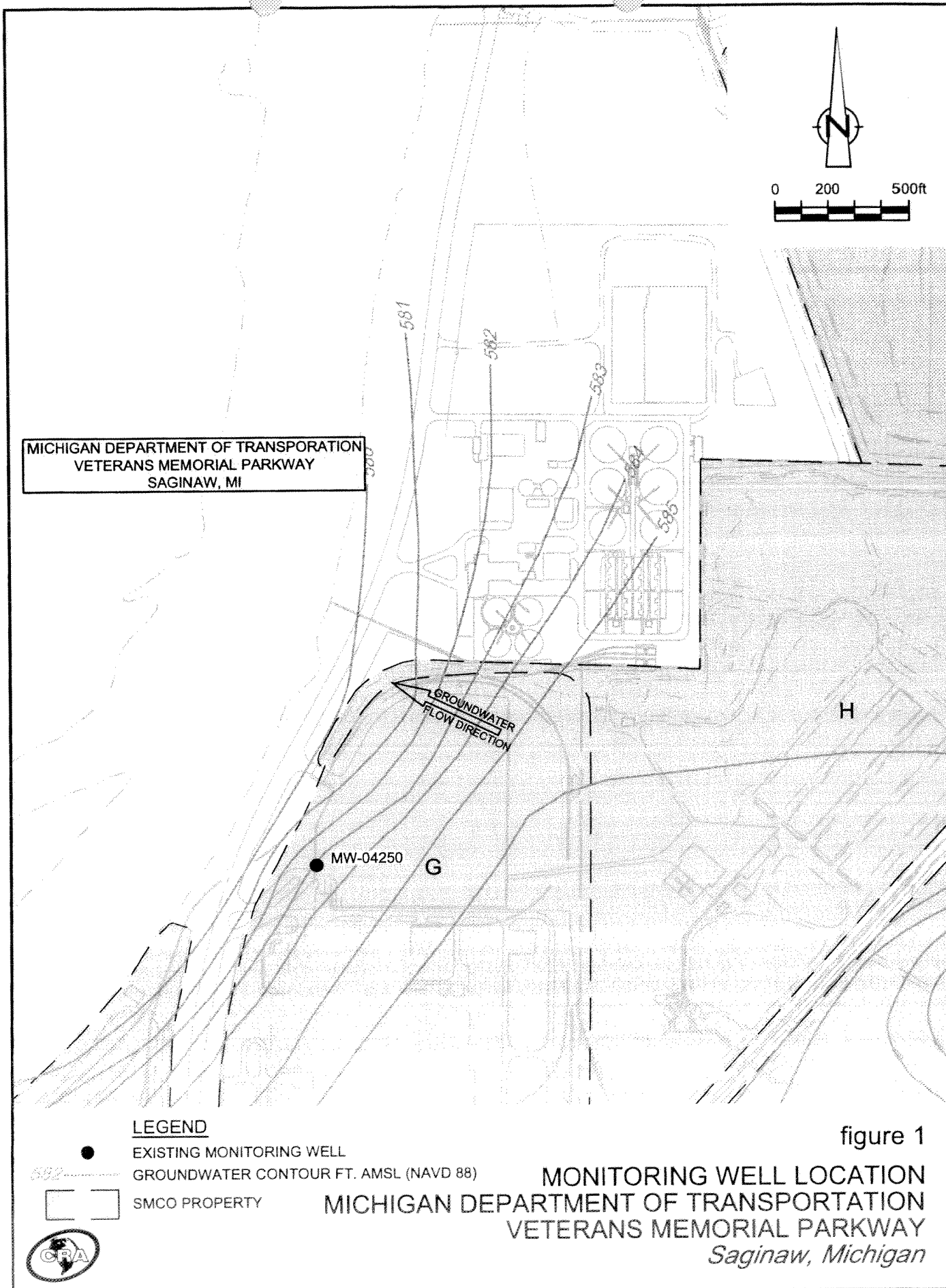

Table 1

Notice of Mitigation of Contamination
GM SMC
Saginaw, MI

<i>Substance</i>	<i>CAS Number</i>	<i>Sample Location</i>	<i>Boundary Concentration (mg/l)</i>	<i>Environmental Medium</i>
Aluminum (Dissolved)	7429-90-5D	MW-04250	1.57	Ground Water
Chromium	7440-47-3T	MW-04250	0.186	Ground Water
Iron	7439-89-6T	MW-04250	96.7	Ground Water
Lead	7439-92-1T	MW-04250	0.0229	Ground Water
Manganese	7439-96-5T	MW-04250	2.78	Ground Water
Vanadium (Dissolved)	7440-62-2D	MW-04250	0.0136	Ground Water